



Assembly instructions

Instrucciones de montaje
Instructions de montage





Contents / Contenu / Contenido

P4 - P10 : Starter units / unités initiales / unidades iniciales

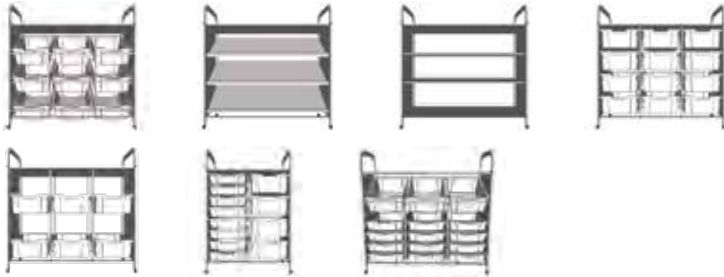

P11 - P22 : Additional units / unités supplémentaires / unidades adicionales

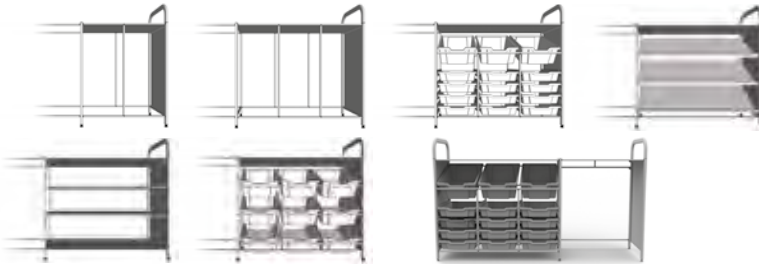

P22 - P31 : Tall starter units / unités hautes initiales / unidades altas iniciales

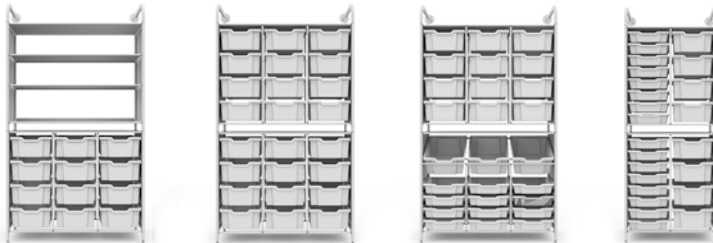

P32 - P42 : Additional tall units / unités hautes supplémentaires / unidades altas adicionales

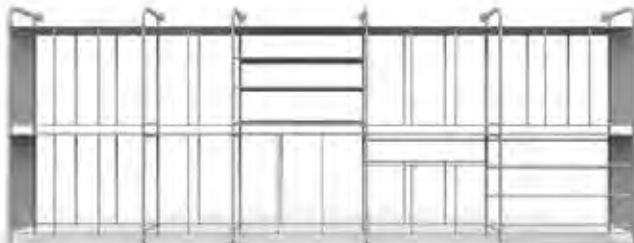

P43 : Supplementary information / Information supplémentaire / Información suplementaria

StoreMoreStore.com | 855-786-7667 | sales@storemorestore.com

Double column unit

Dimensions: 995(H) x 690(W) x 430mm(D)



CFRA44 x 1
CFRF44 x 1
CFRH44 x 1

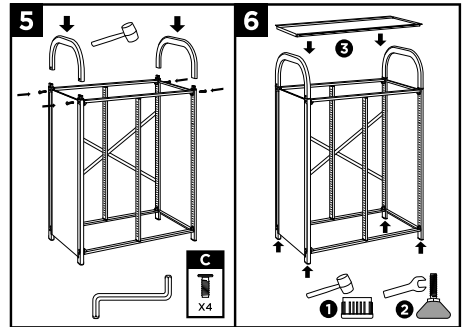
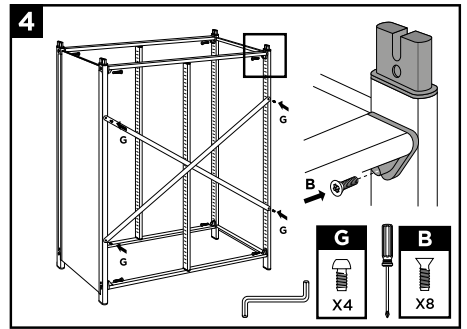
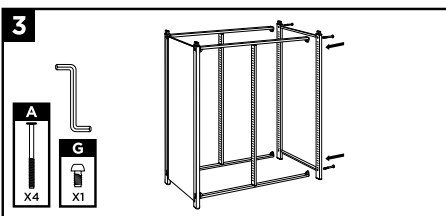
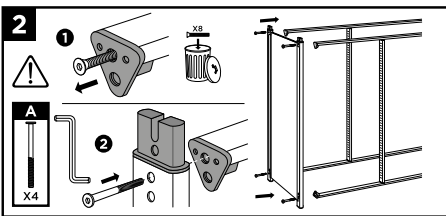
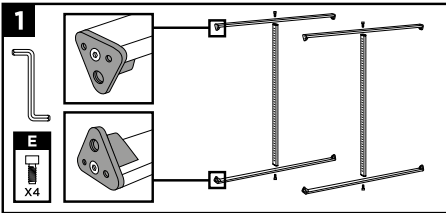
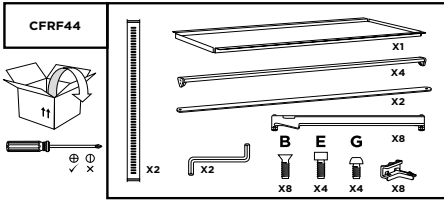
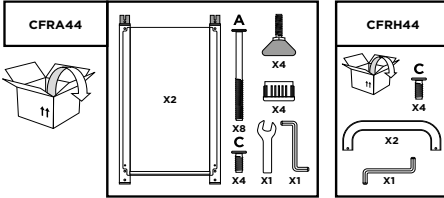

Treble Column Unit

Dimensions: 995(H) x 1025(W) x 430mm(D)

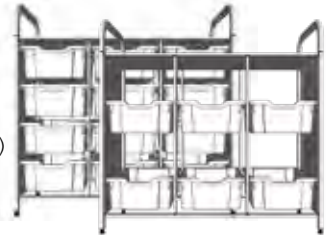

CF.....
CFRC44 x 1
CFRH44 x 1

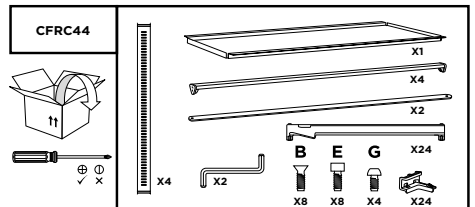
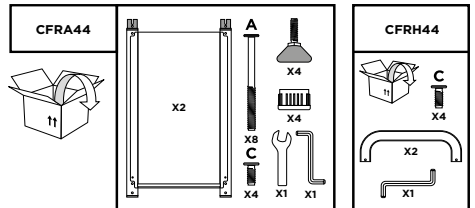

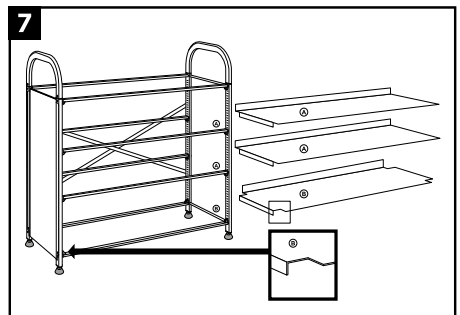
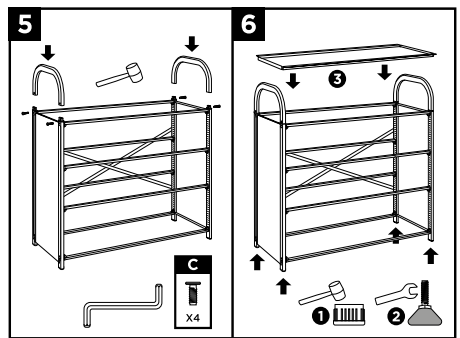
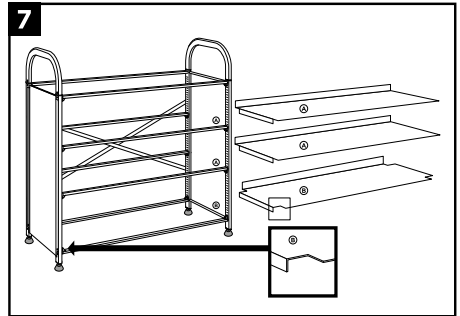
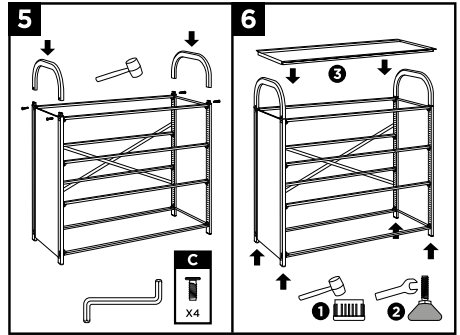
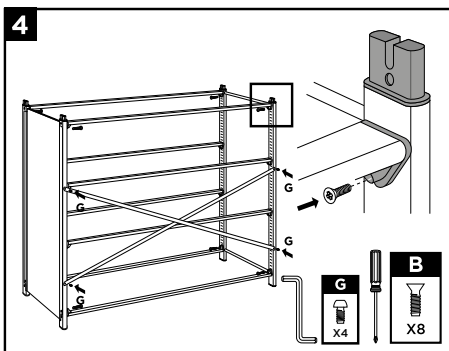
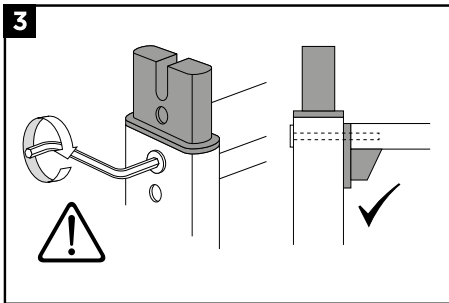
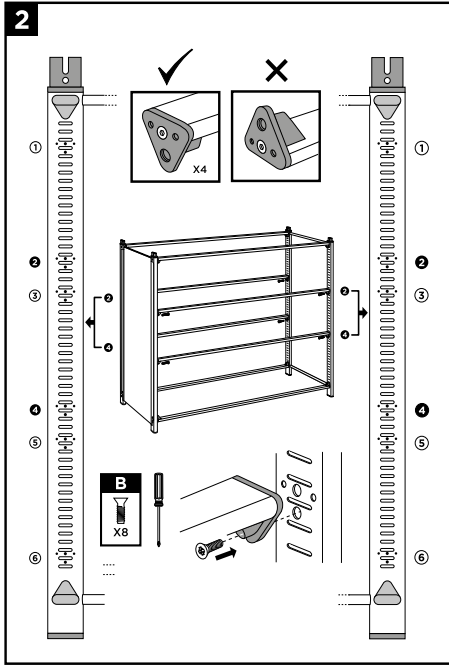

Titled shelf unit

Dimensions: 995(H) x 1025(W) x 430mm(D)



11
CFRA44 x 1
CFRD44 x 1
CFRH44 x 1

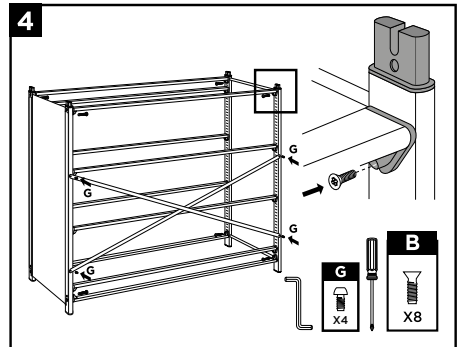
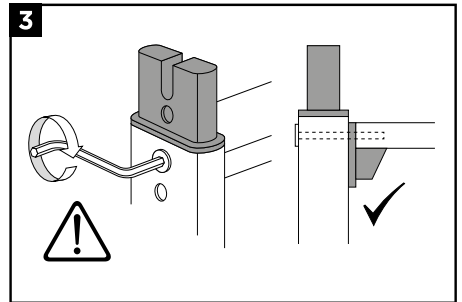
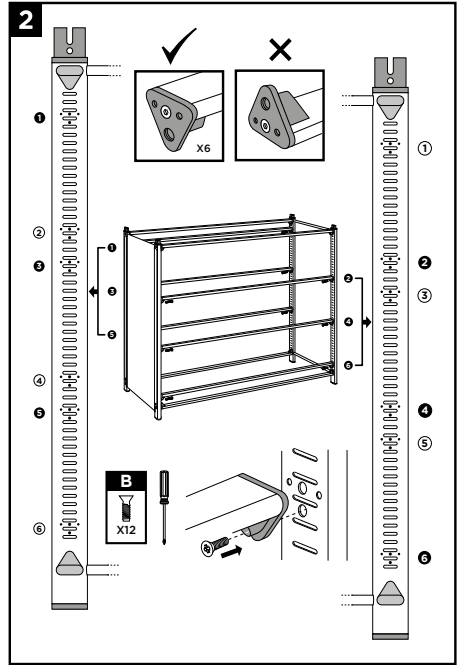
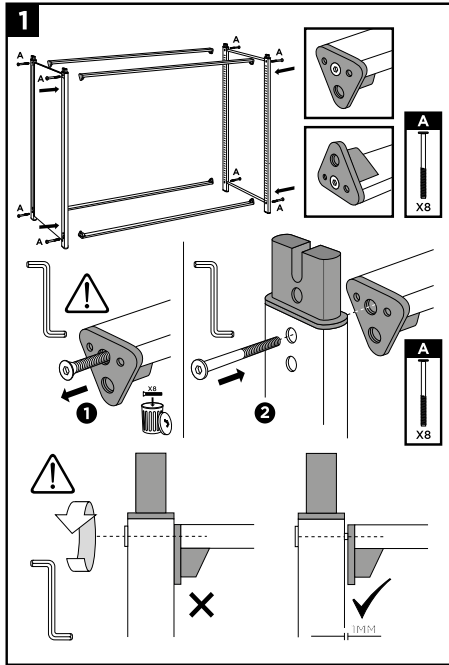
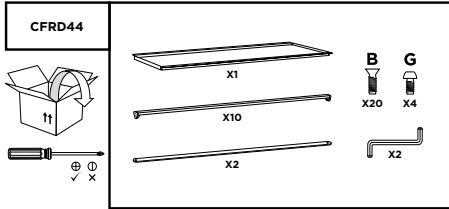
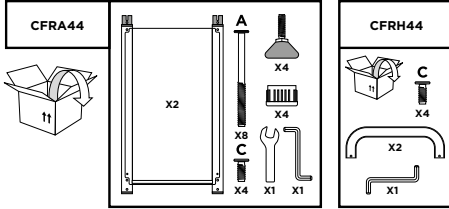

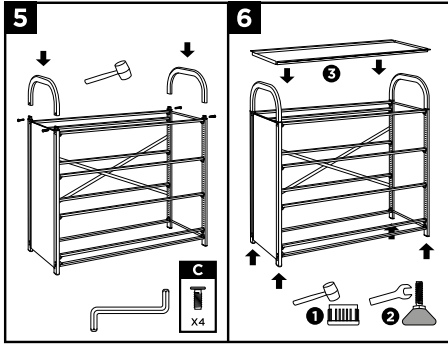

Titled tray unit

Dimensions: 995(H) x 1025(W) x 430mm(D)



CFRA44 x 1
CFRE44 x 1
CFRH44 x 1

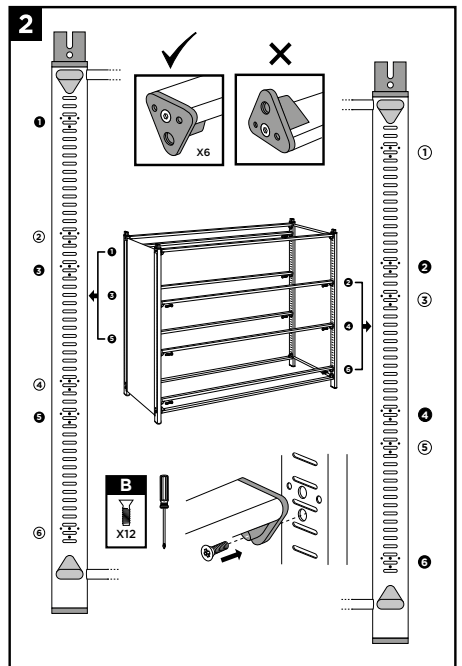
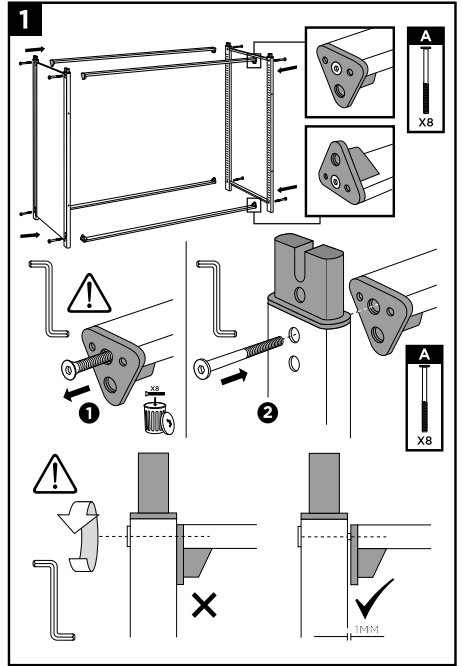
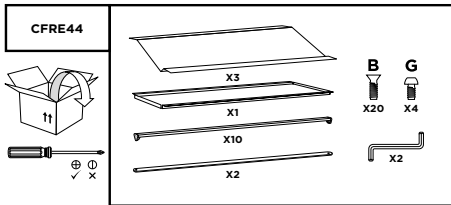
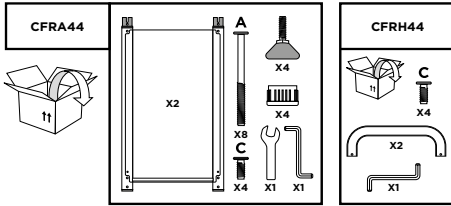

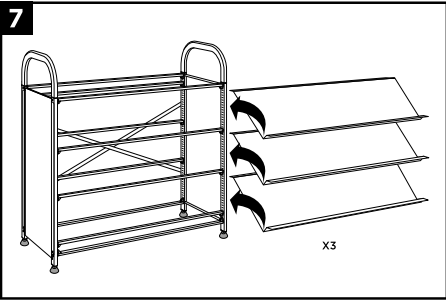
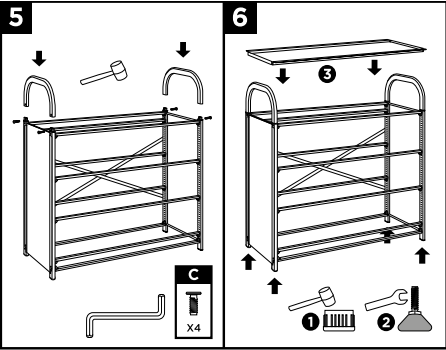
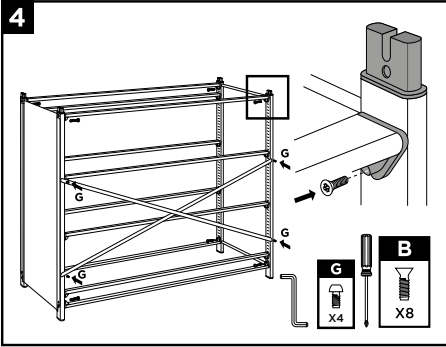
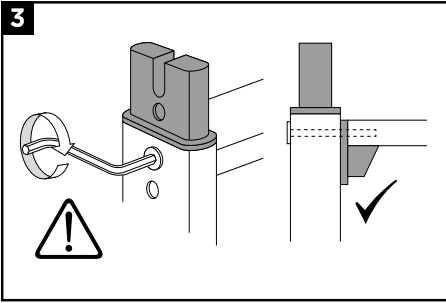

Maker unit

Dimensions: 995(H) x 1025(W) x 430mm(D)

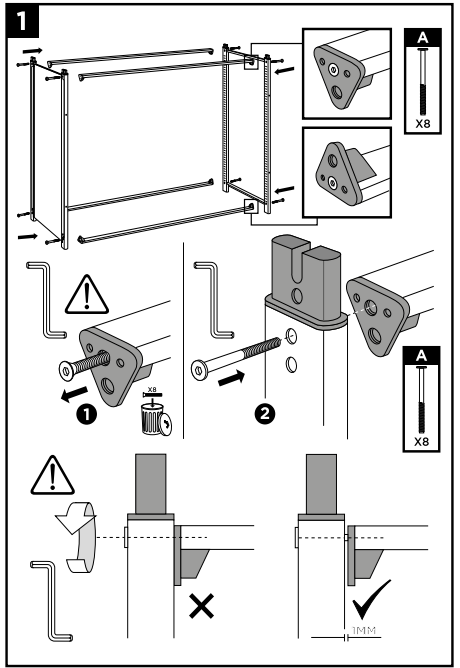
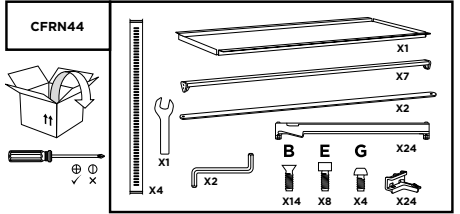
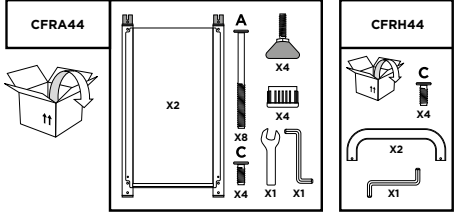

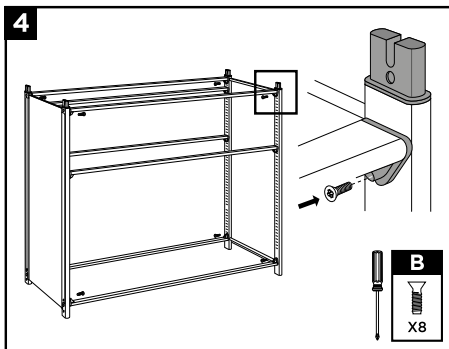
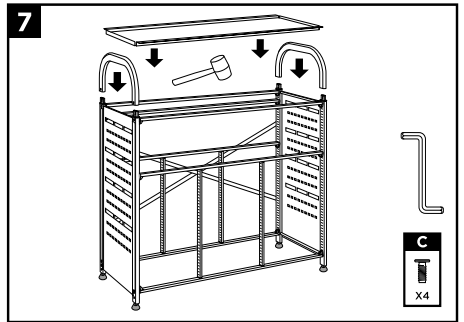
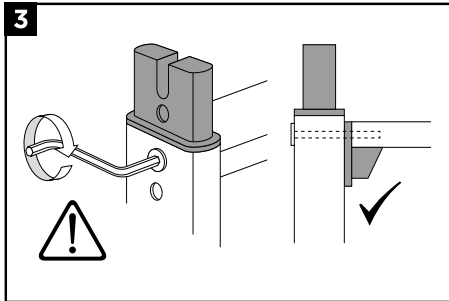
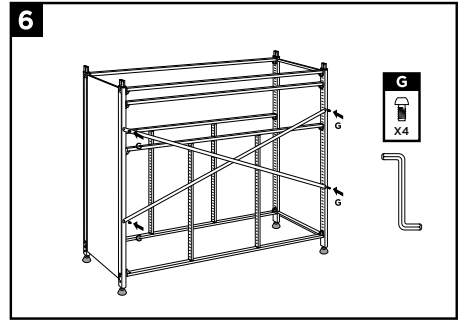
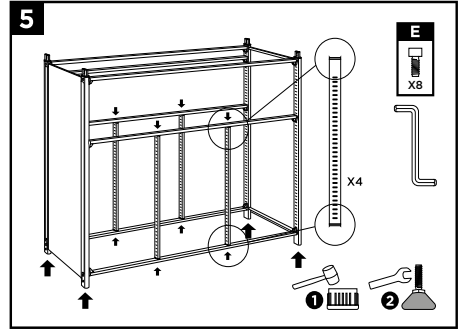
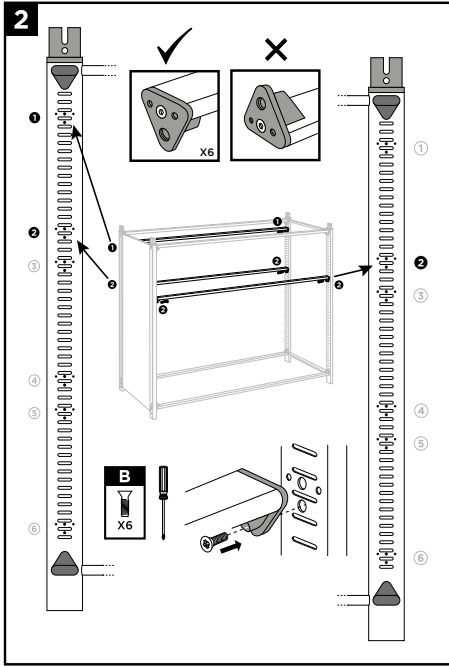

Double column unit

Dimensions: 995(H) x 690(W) x 430mm(D)



CFRB44 x 1
CFRF44 x 1

CFRB44

CFRF44

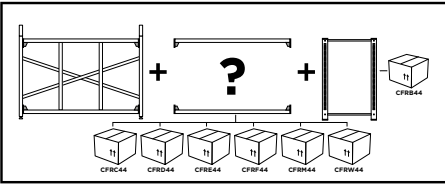
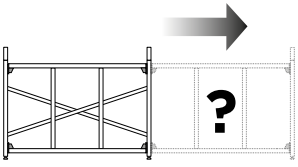

1

2

4

5

6



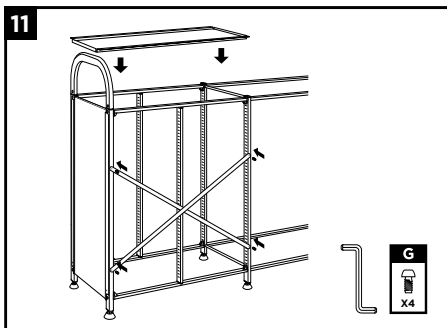
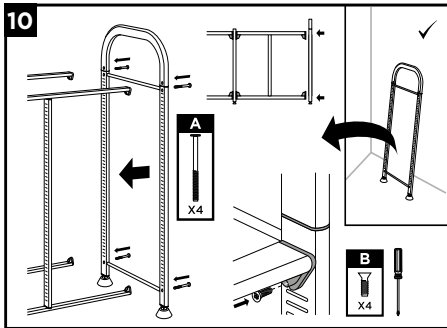
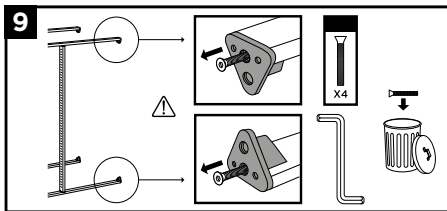
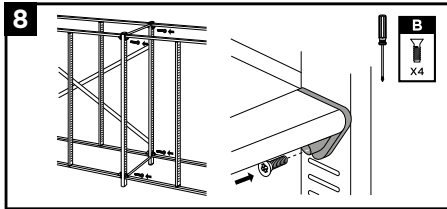
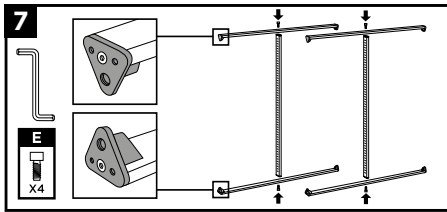

Treble column unit

Dimensions: 995(H) x 1025(W) x 430mm(D)

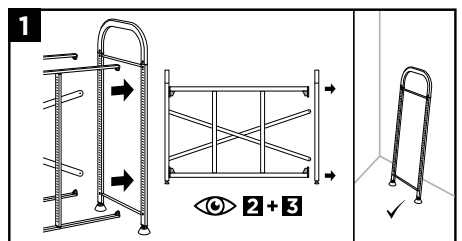
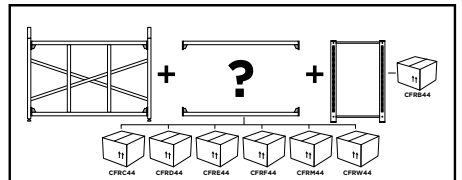
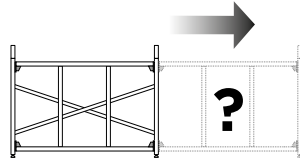
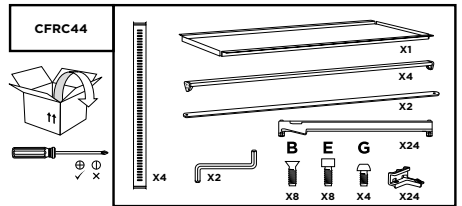
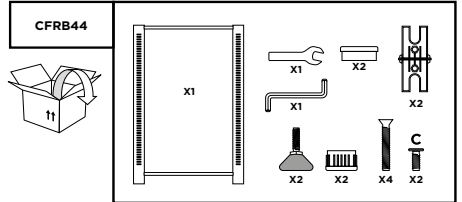
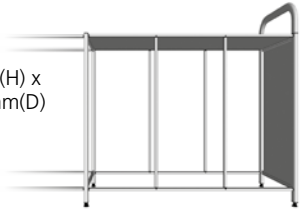

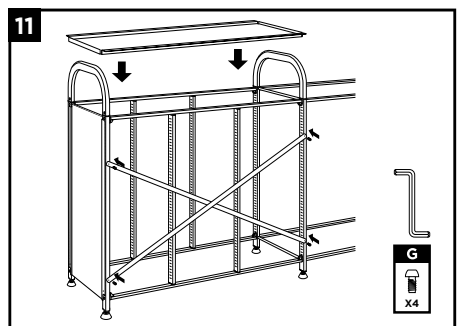
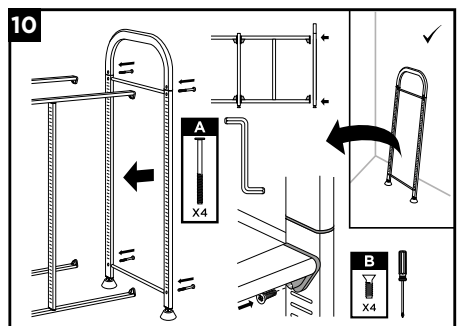
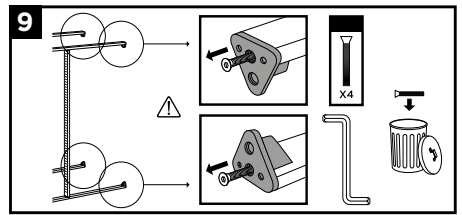
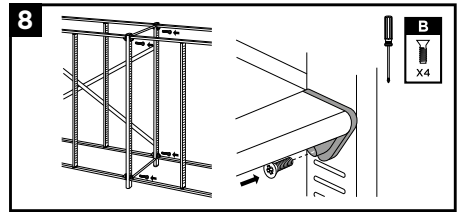
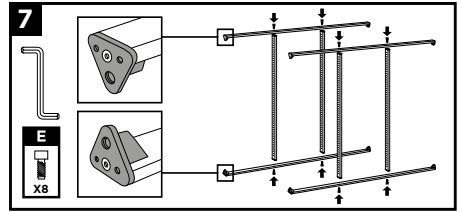
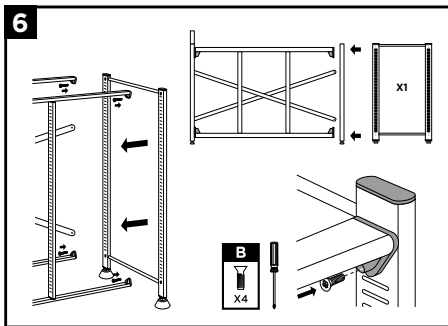
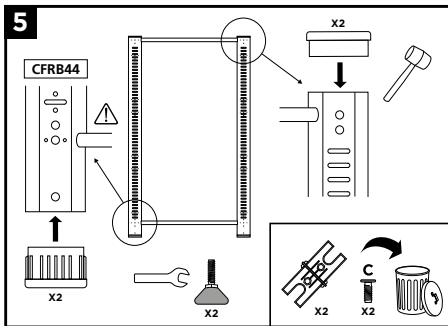
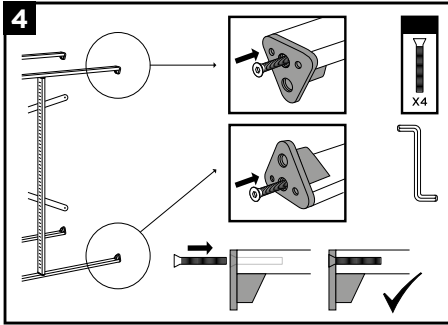
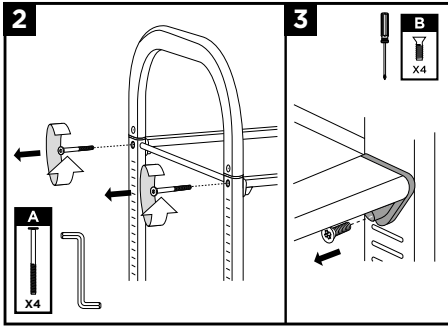

Flat shelf unit

Dimensions: 995(H) x 1025(W) x 430mm(D)



CFRB44

CFRM44

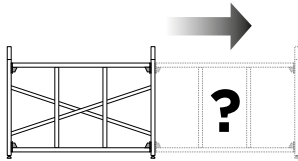

1

2

4

5

6



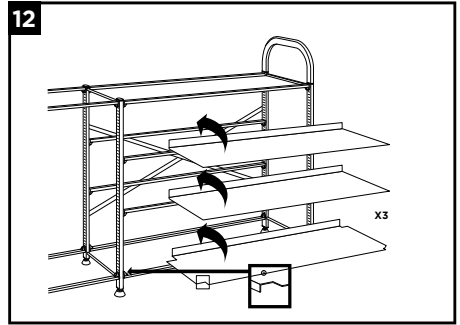
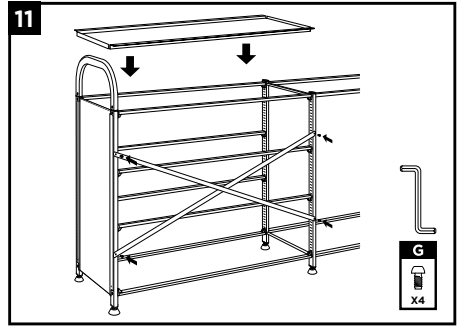
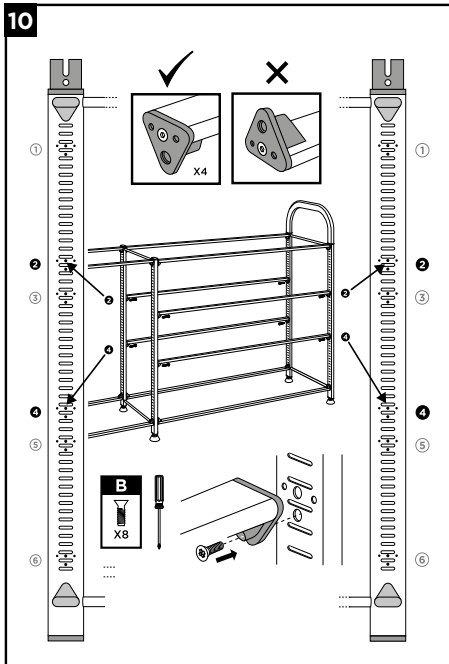
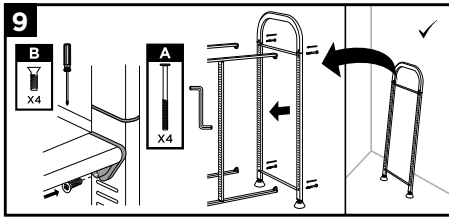
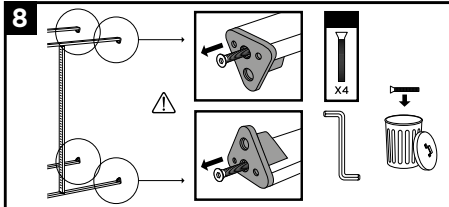
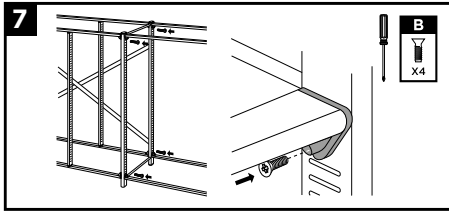

Tilted tray unit

Dimensions: 995(H) x 1025(W) x 430mm(D)

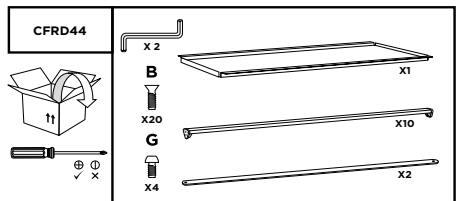
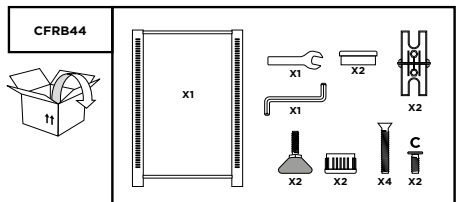
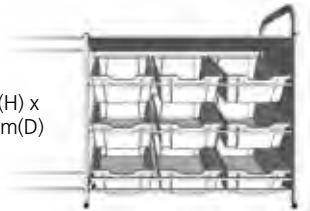

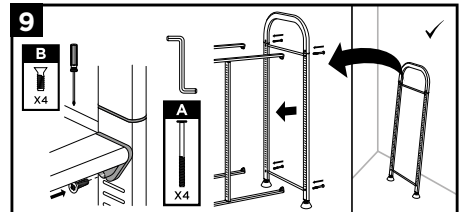
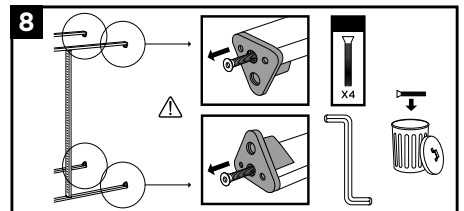
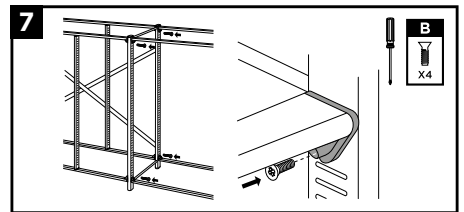
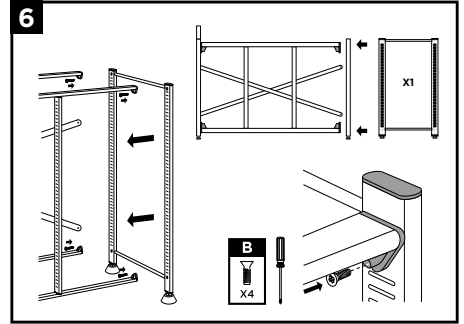
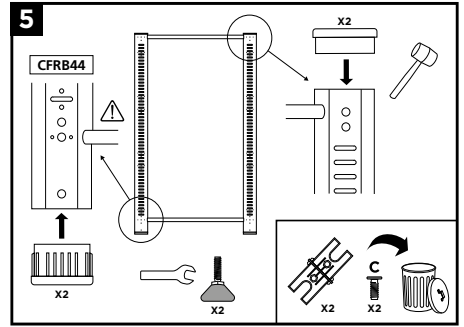
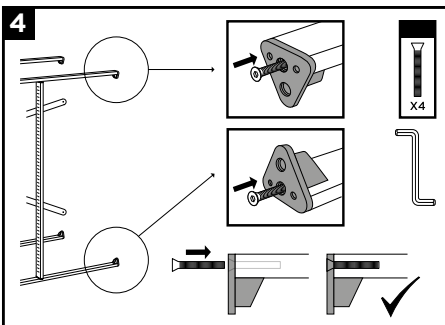
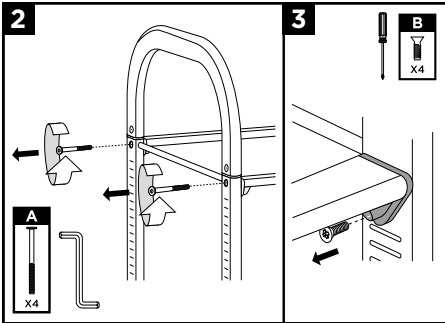
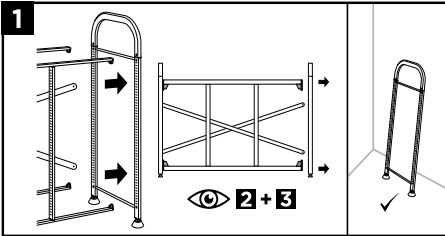
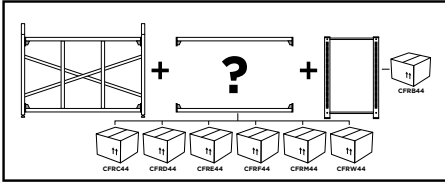
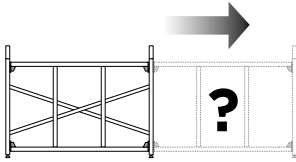

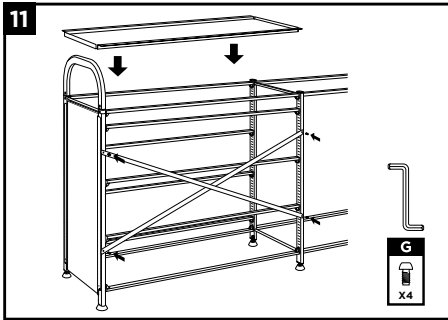
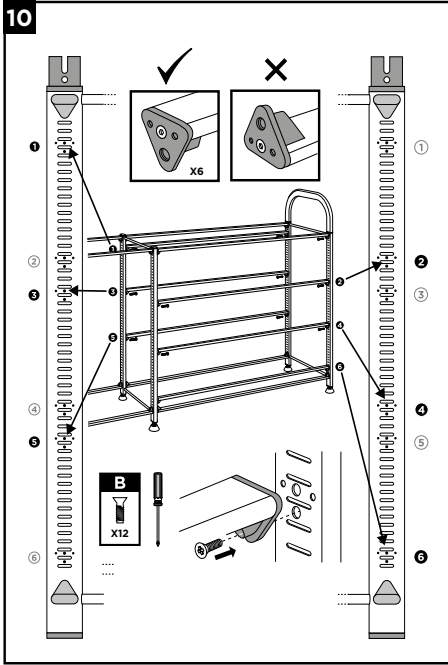

Tilted shelf unit

Dimensions: 995(H) x 1025(W) x 430mm(D)

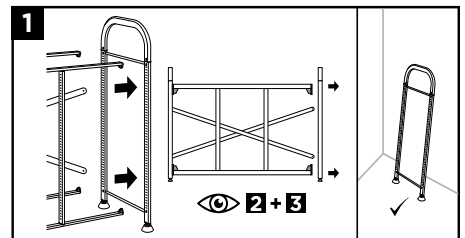
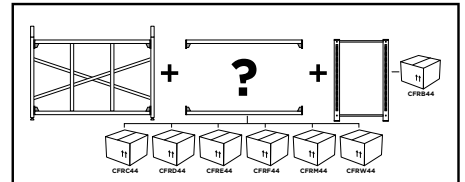
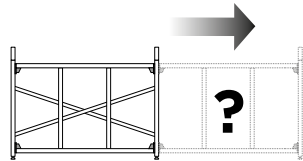
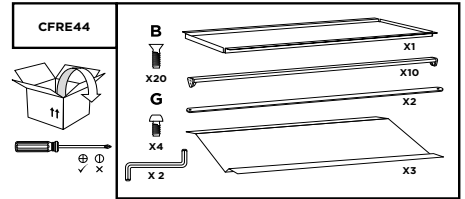
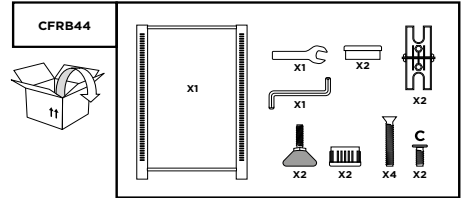

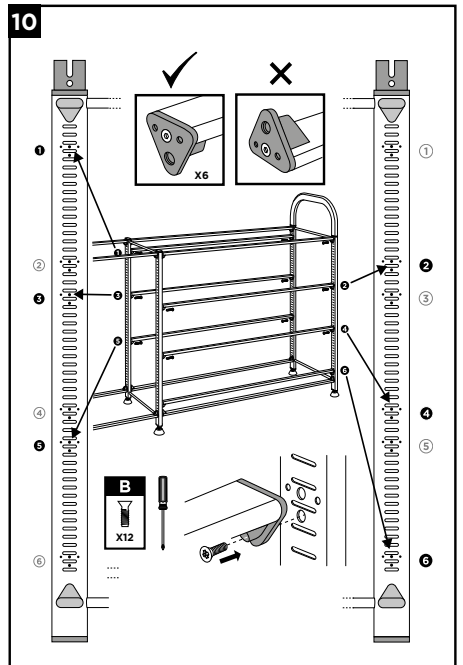
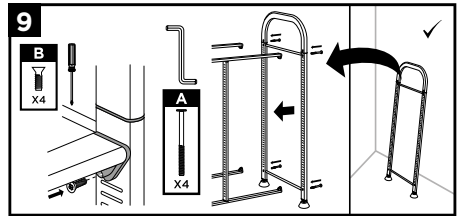
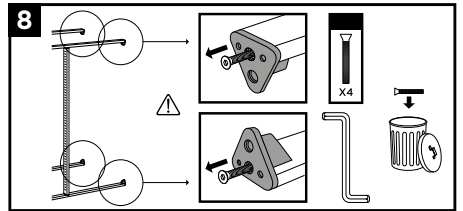
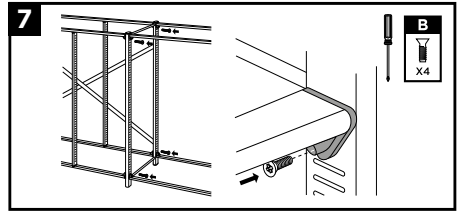
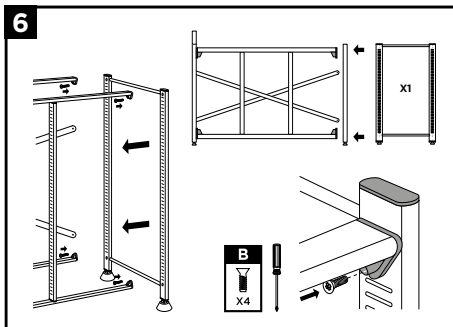
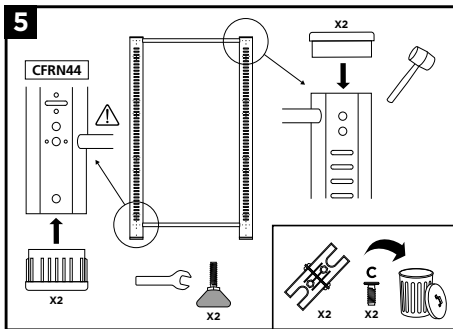
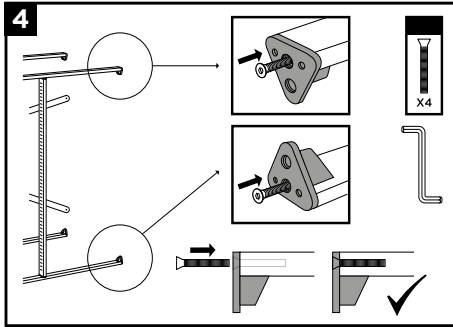
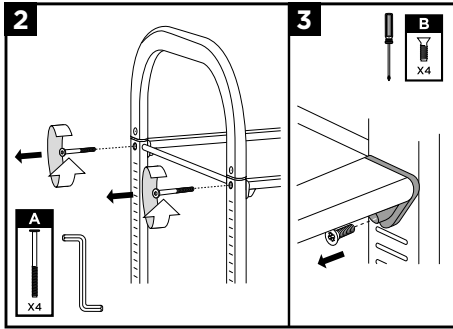

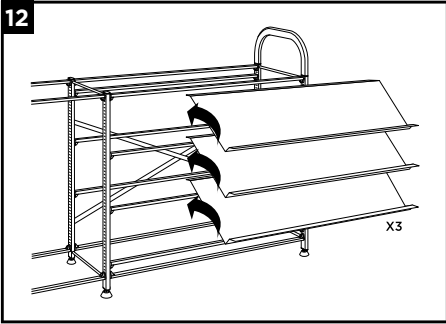
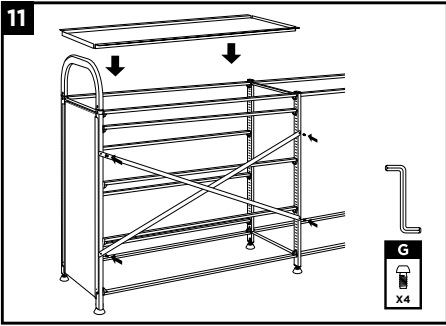

Maker unit

Dimensions: 995(H) x 1025(W) x 430mm(D)

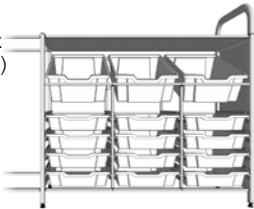

1t
CFRB44 x 1
CFRN44 x 1

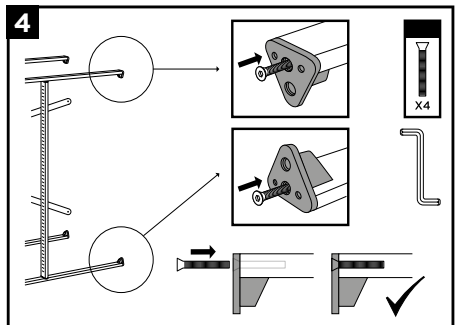
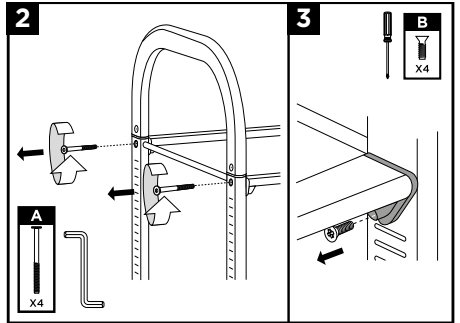
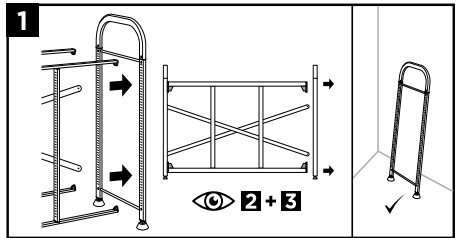
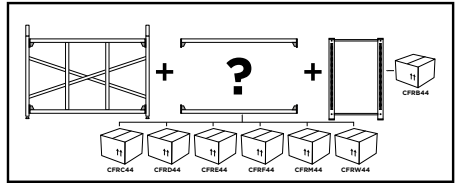
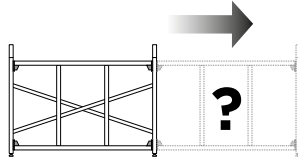
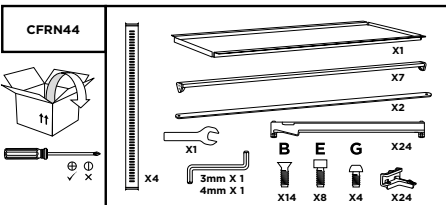
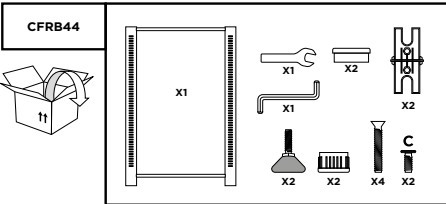

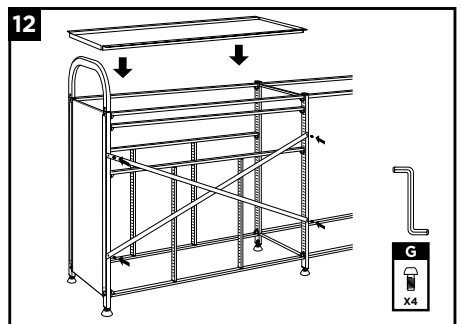
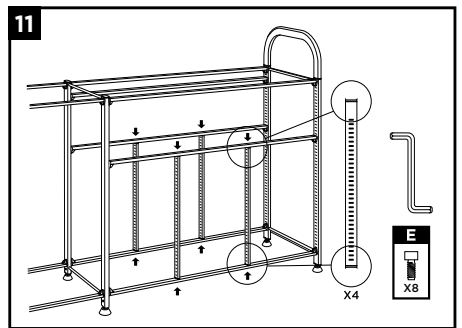
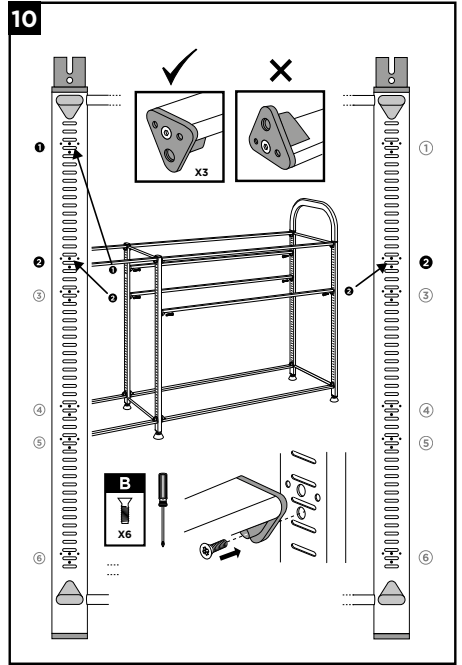
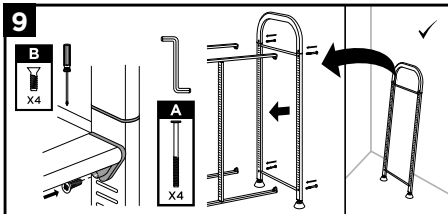
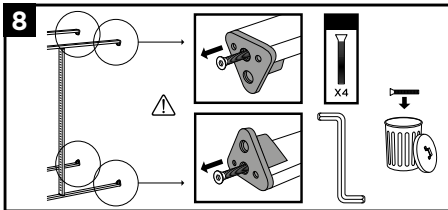
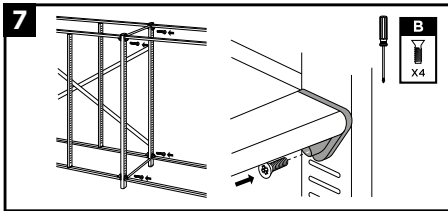
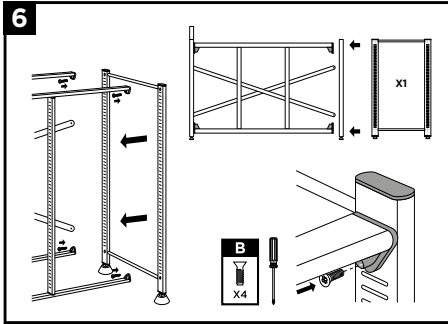
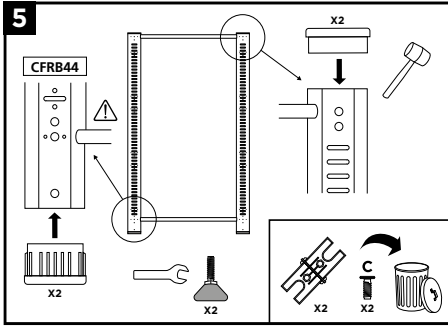

Low adder workstation

Dimensions: 995(H) x 690(W) x 430mm(D)



CFRB44 x 1
CFRW44 x 1

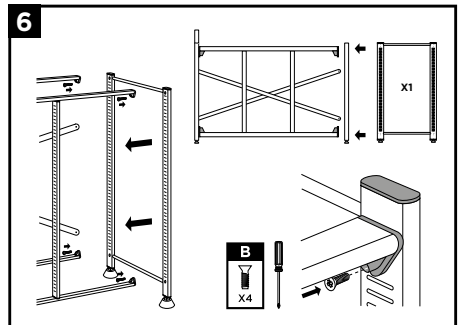
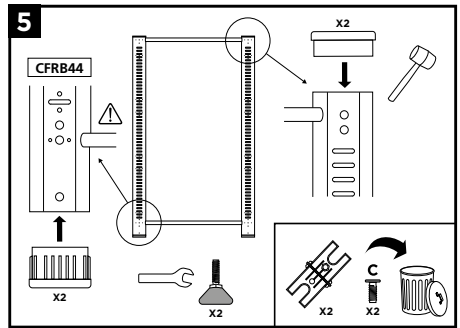
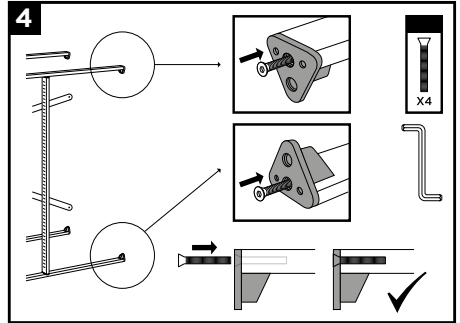
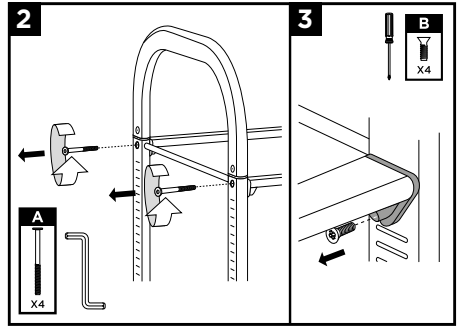
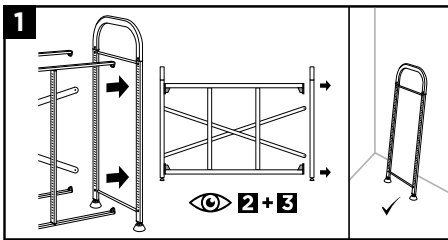
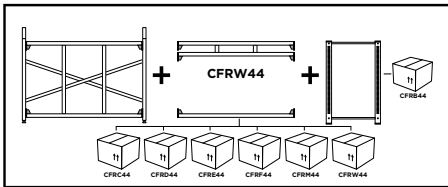
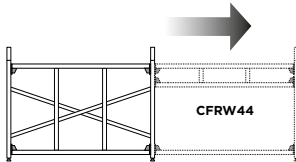
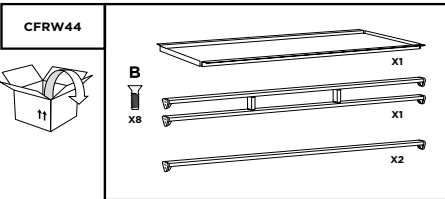
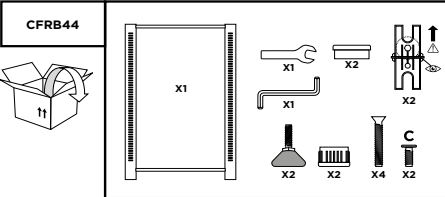

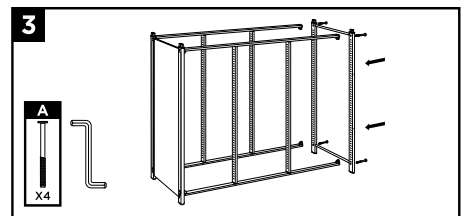
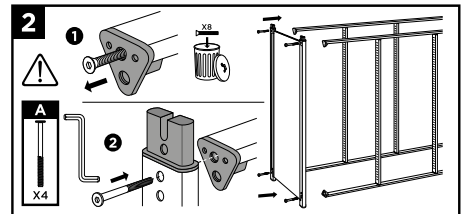
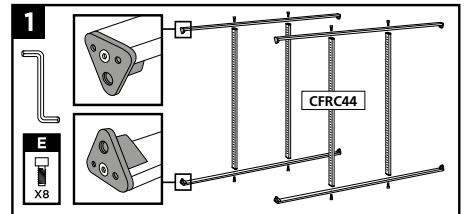
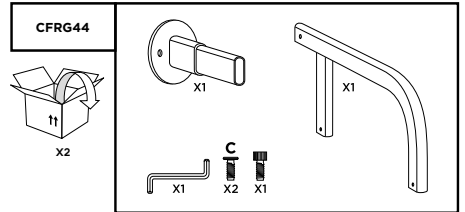
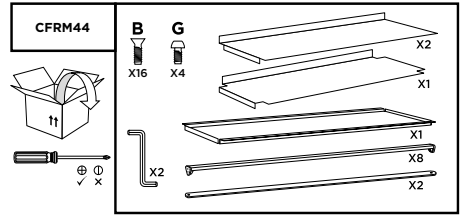
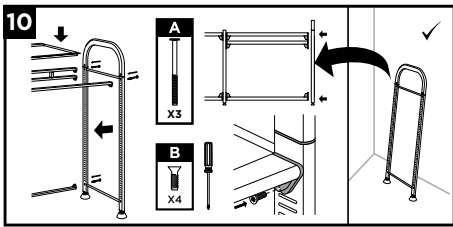
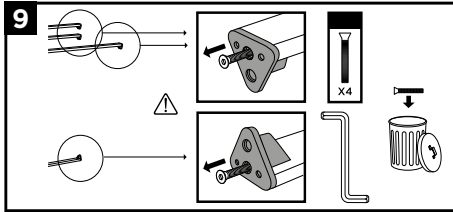
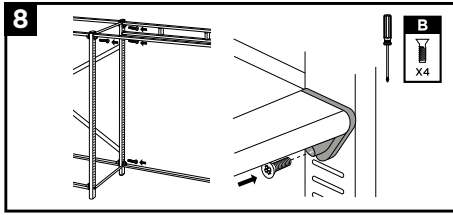

Display-store unit

Dimensions: 1806(H) x
1025(W) x 430mm(D)



1t
CFRA44 x 2
CFRC44 x 1
CFRM44 x 1
CFRG44 x 2

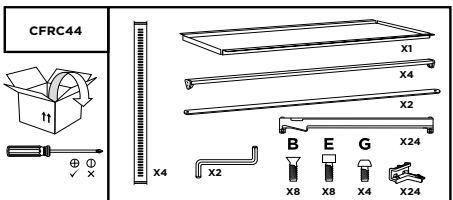
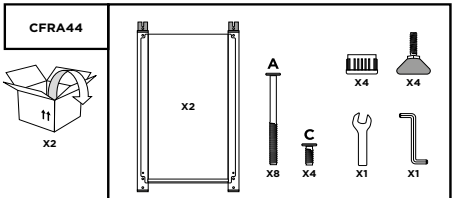

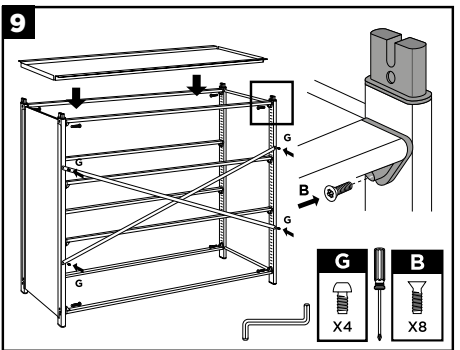
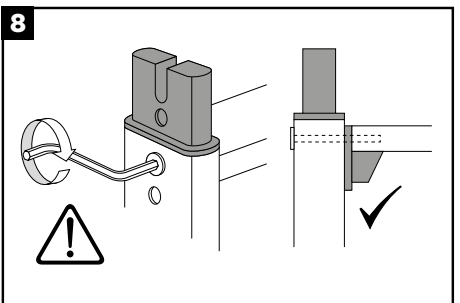
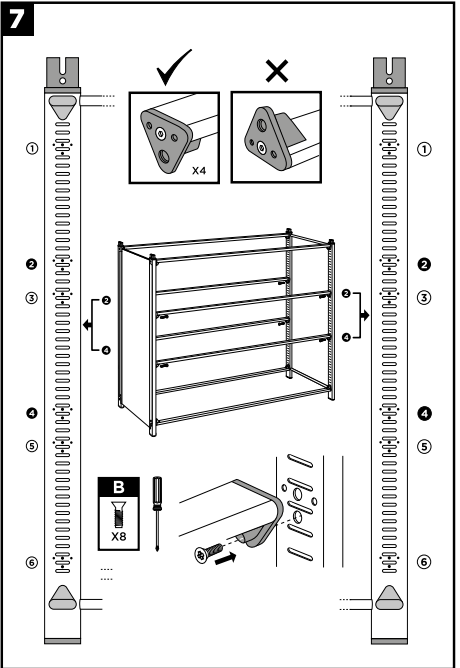
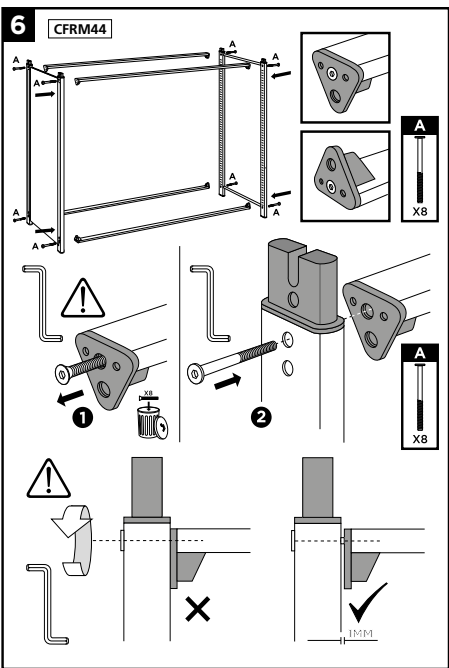
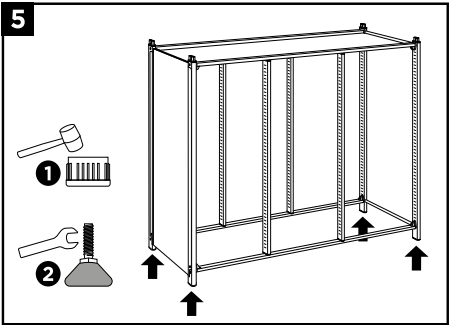
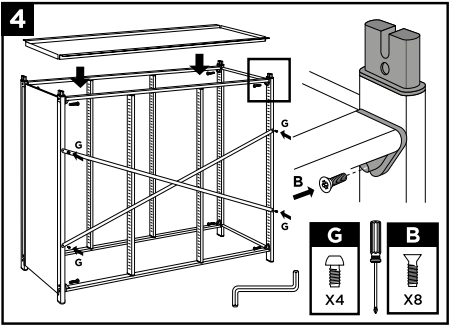

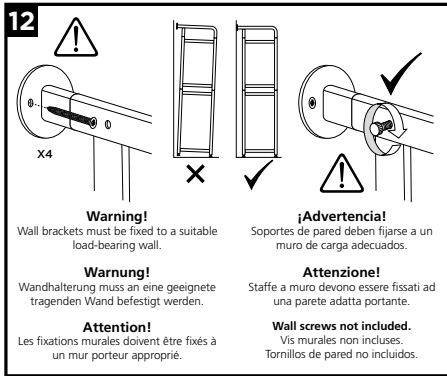
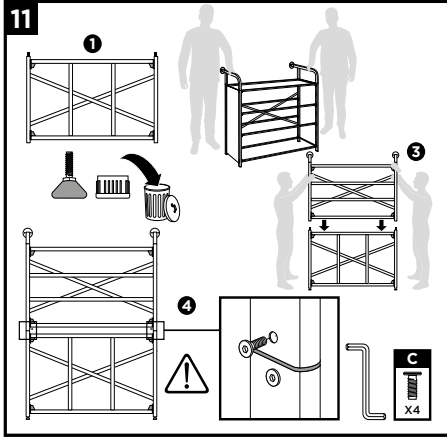
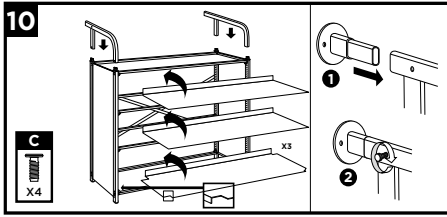

Tall-store unit and Flexi-store unit

Dimensions: 1806(H) x 1025(W) x 430mm(D)



CFRA44 x 2
CFRC44 x 2
CFRG44 x 2

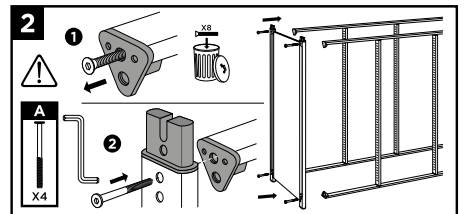
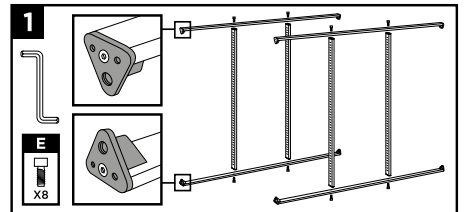
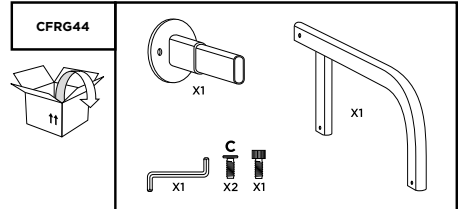
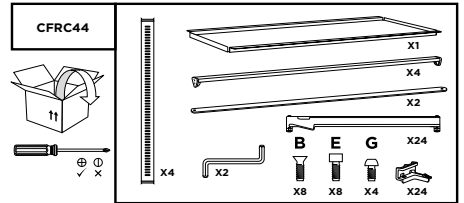
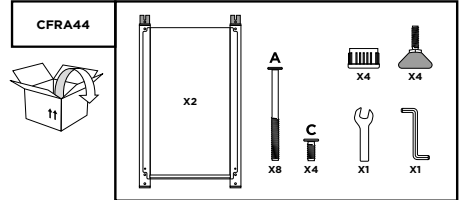

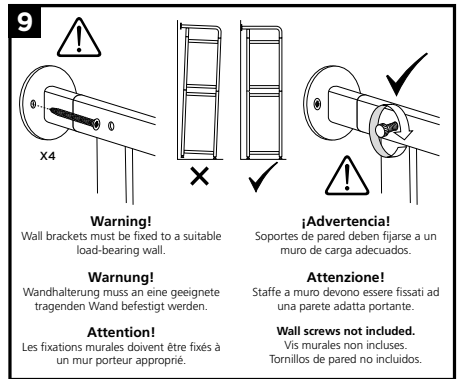
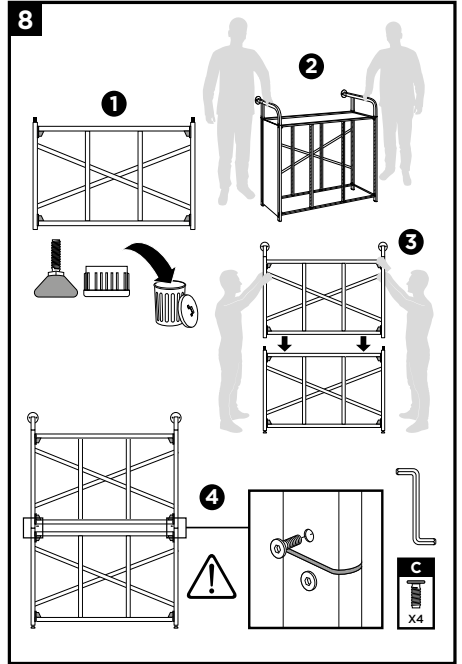
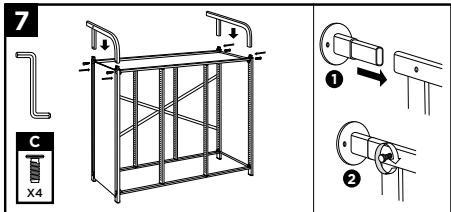
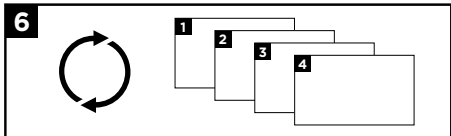
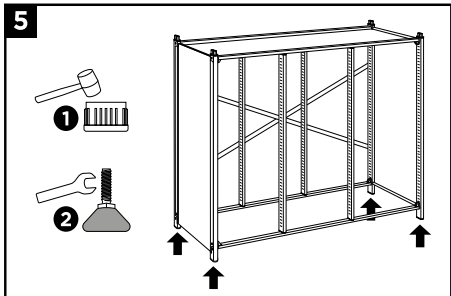
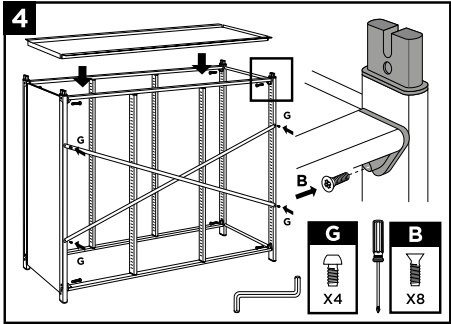
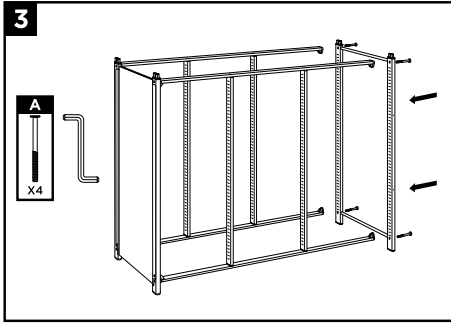

Maker-store unit and Maker-tall unit

Dimensions: 1806(H) x
1025(W) x 430mm(D)



CFRA44 x 2
CFRC44 x 1
CFRG44 x 2
CFRN44 x 1

CFRA44

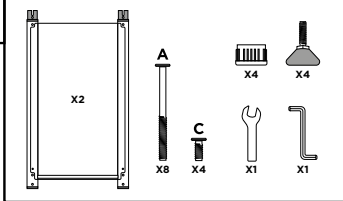

CFRC44

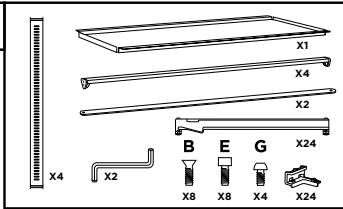
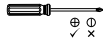

CFRA44 x 2
CFRC44 x 1
CFRG44 x 2
CFRN44 x 1

CFRG44

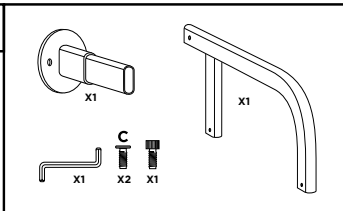

CFRN44

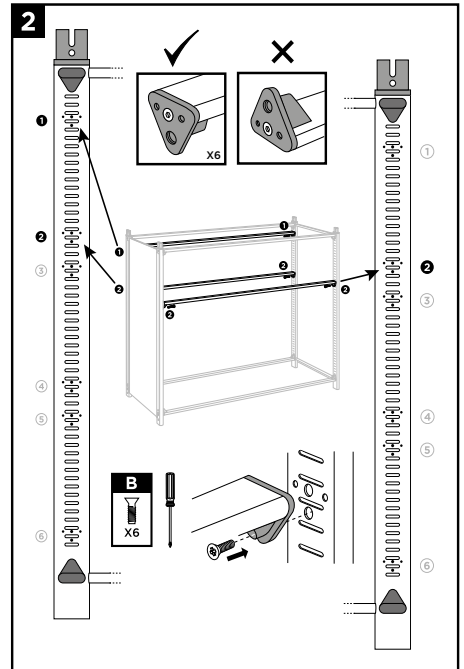
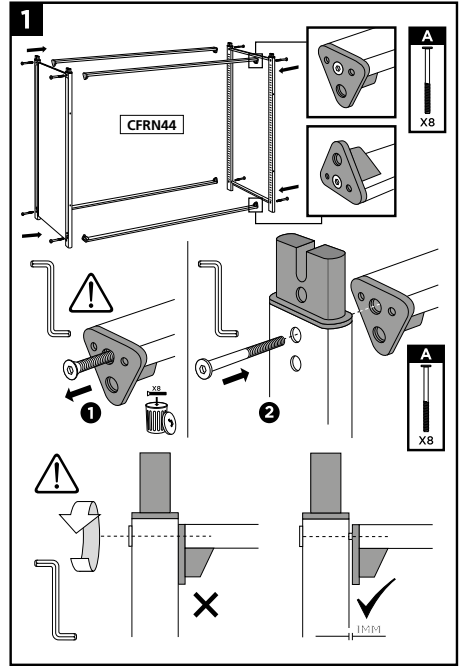
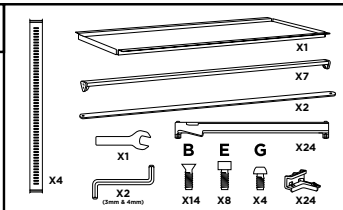
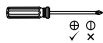

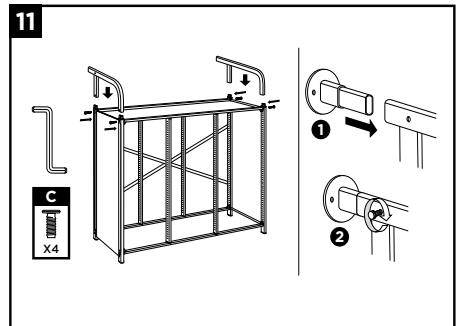
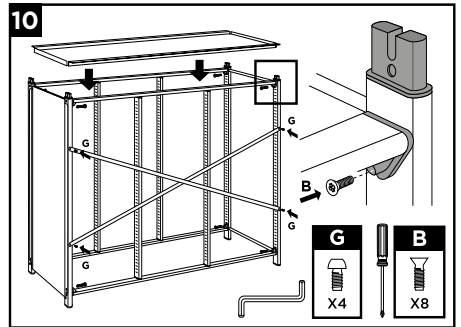
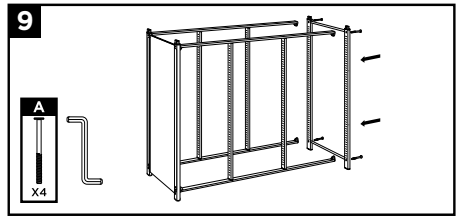
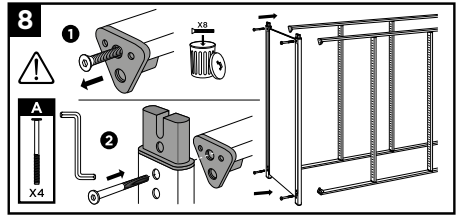
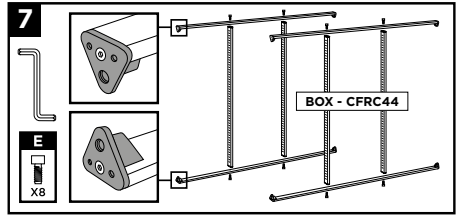
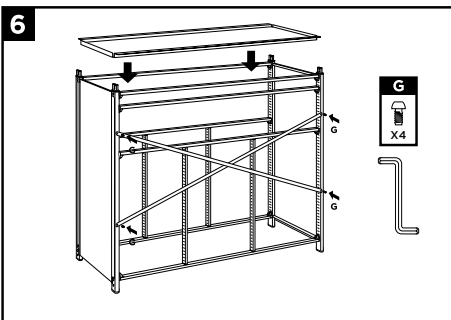
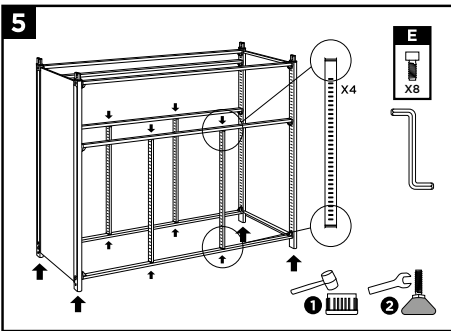
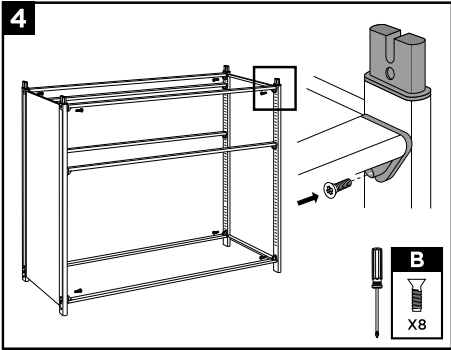
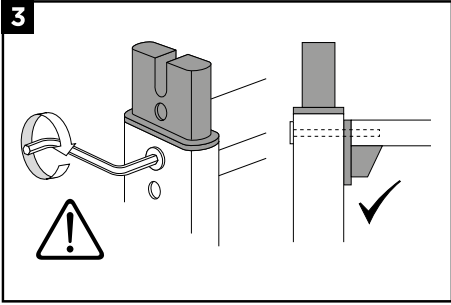

12

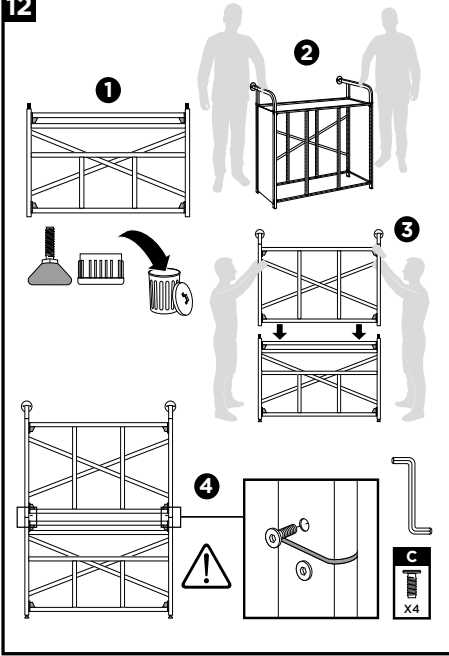

13

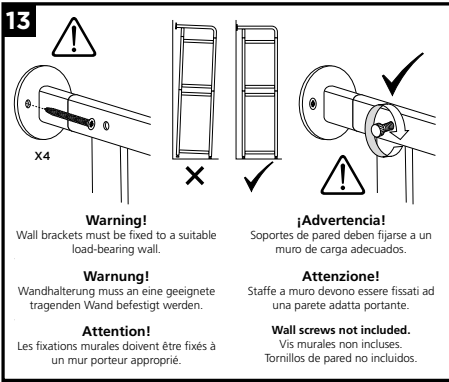

Pick-store unit

Dimensions: 1806(H) x 1025(W) x 430mm(D)



CFRA44 x 2
CFRC44 x 1
CFRD44 x 1
CFRG44 x 2

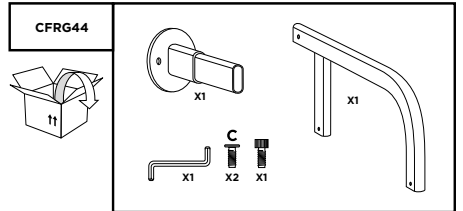
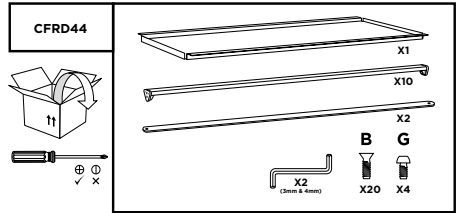
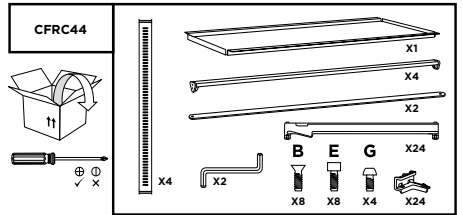
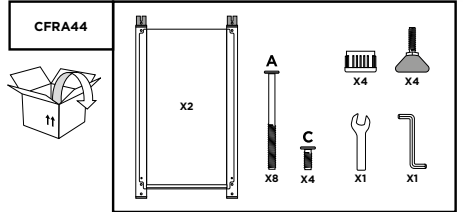

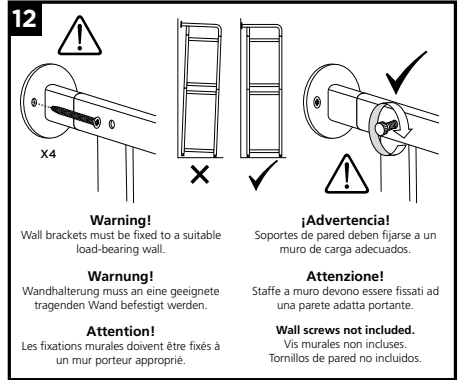
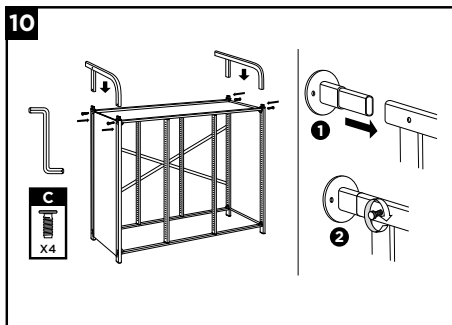
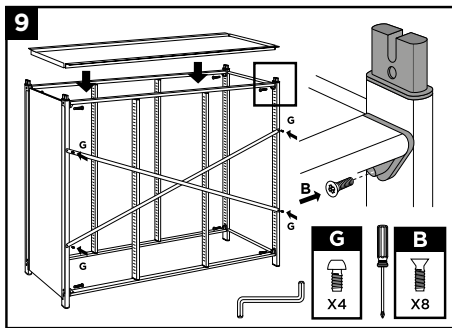
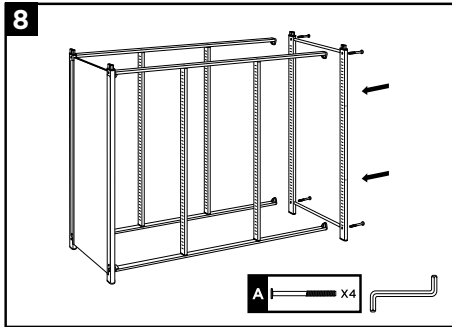
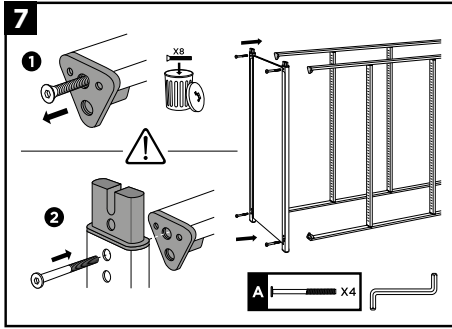

Slim-store unit

Dimensions: 1806(H) x 695(W) x 430mm(D)



CFRA44 x 2
CFRF44 x 2
CFRG44 x 2

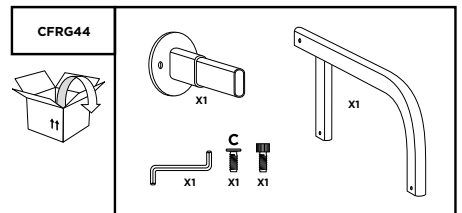
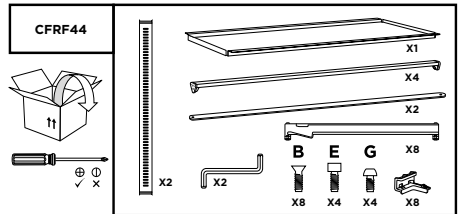
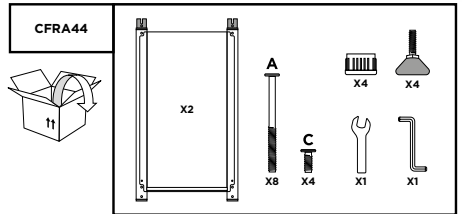

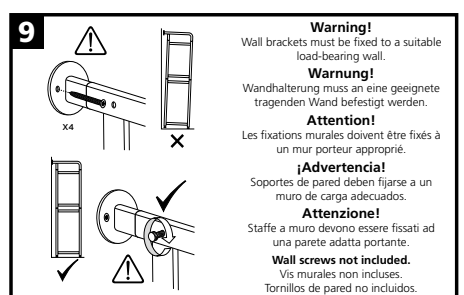
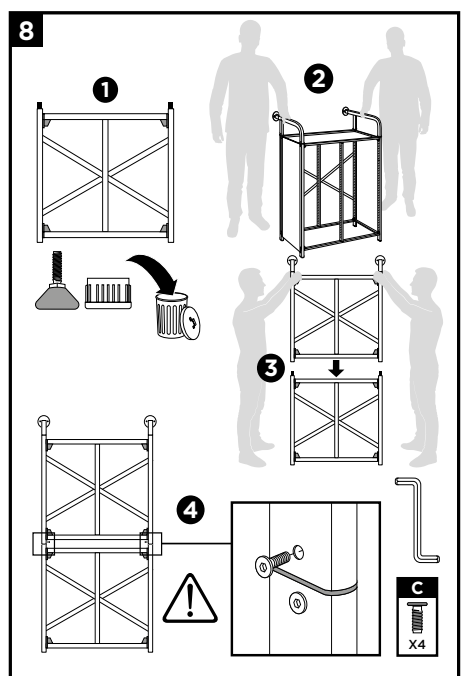
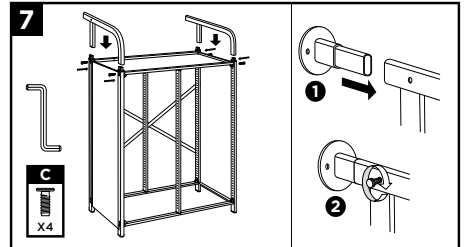
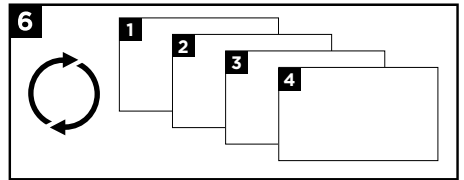
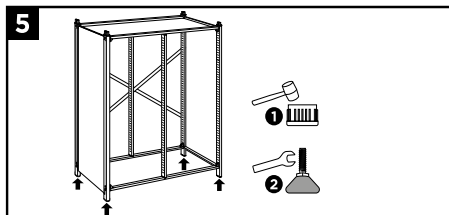
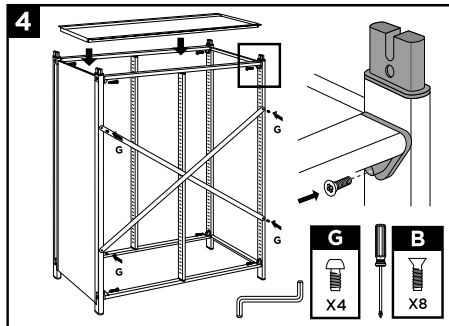
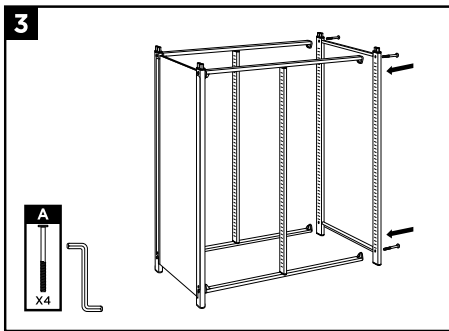
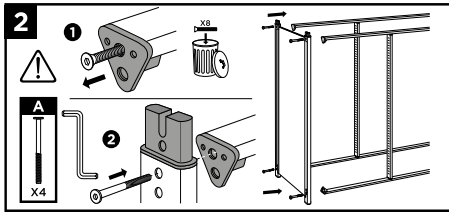
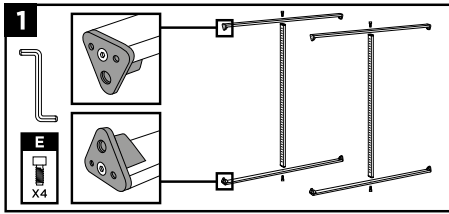

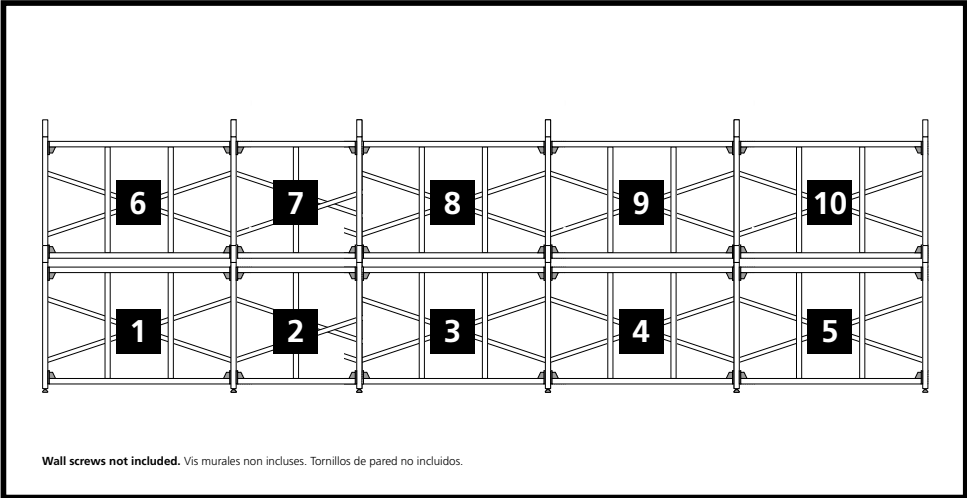
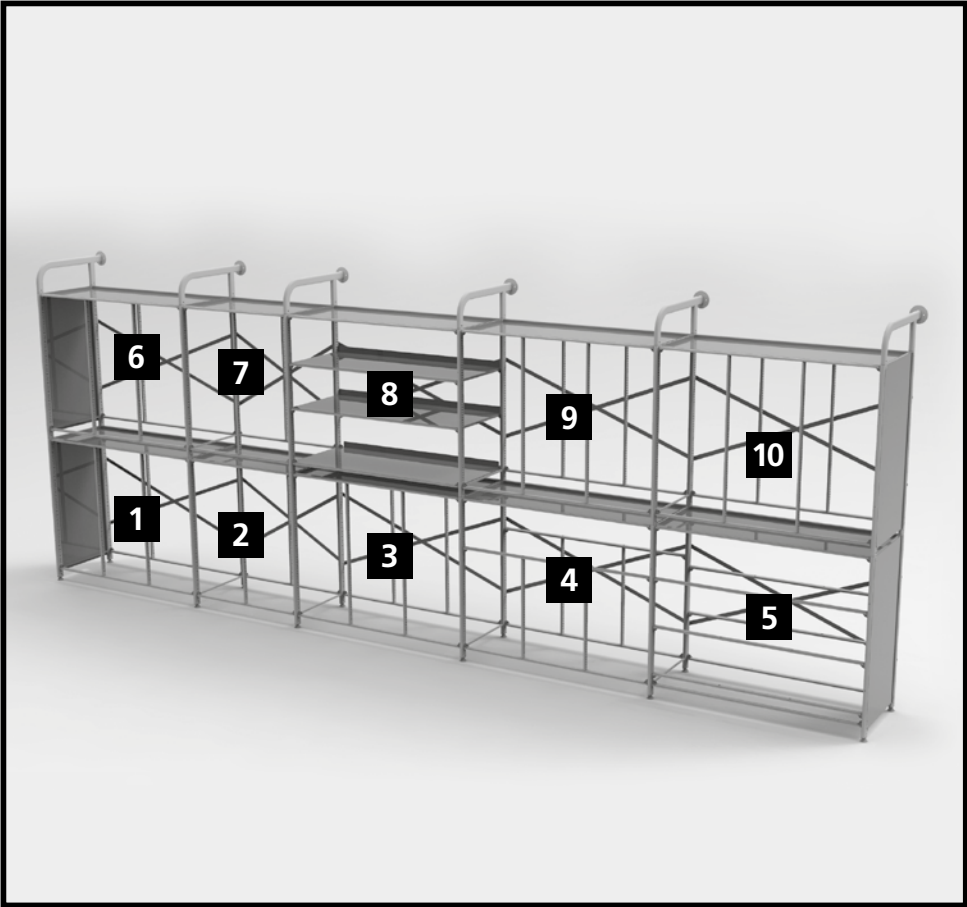

Wall screws not included. Vis murales non incluses. Tornillos de pared no incluidos.



1. Treble column unit

CFRA44 + CFRC44
+ CFRB44

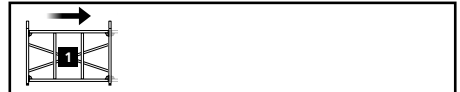
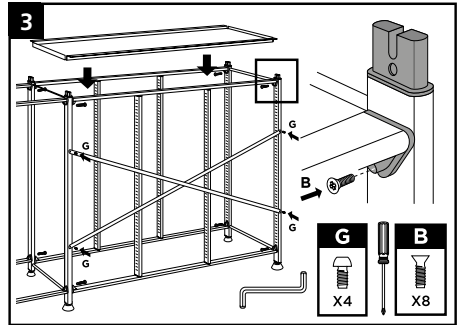
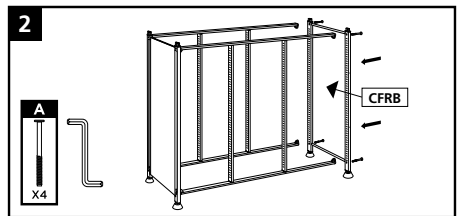
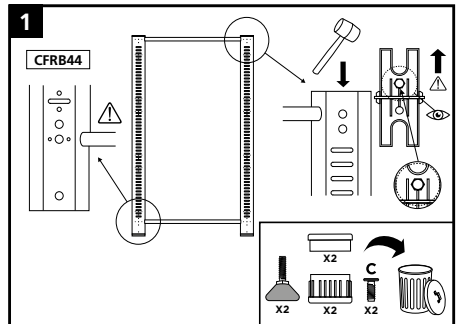
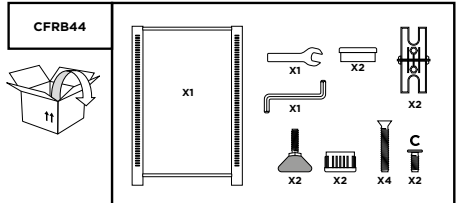
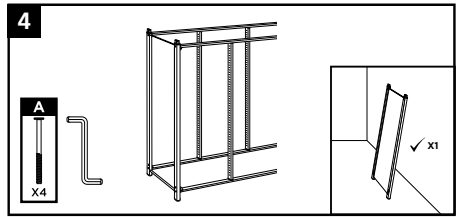
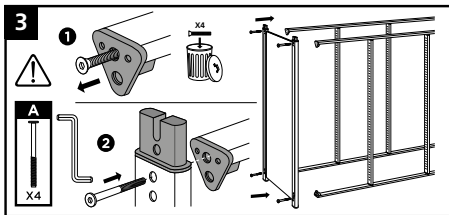
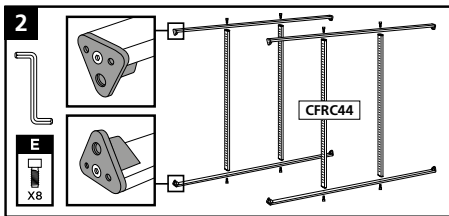
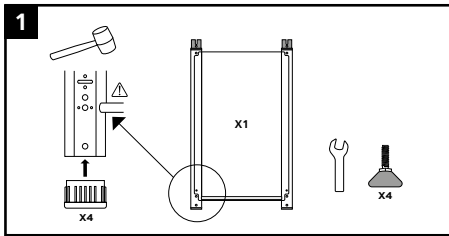
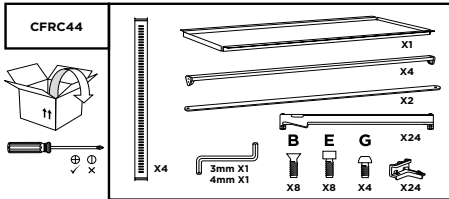
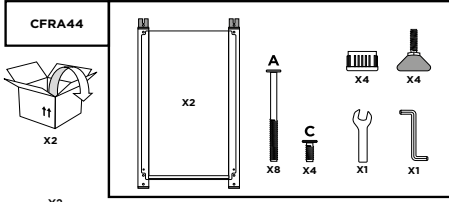

2. Double column

CFRF44 + CFRB44

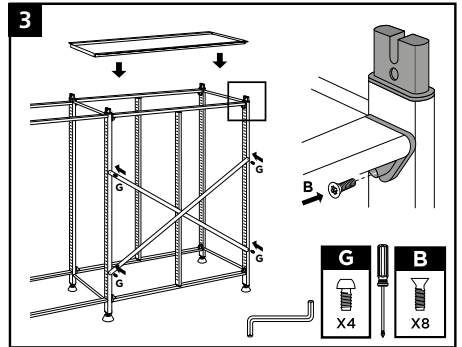
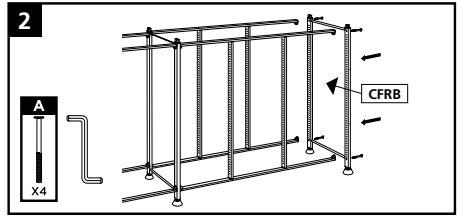
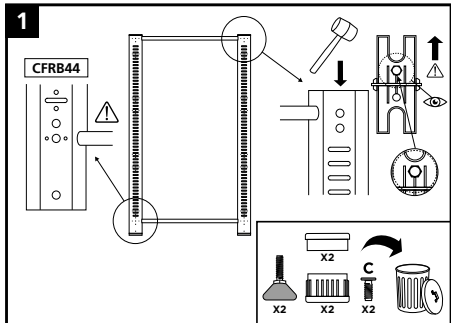
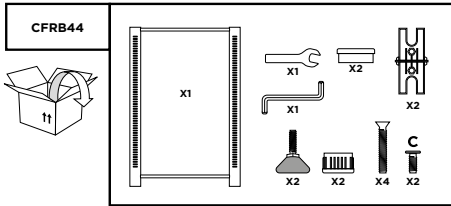
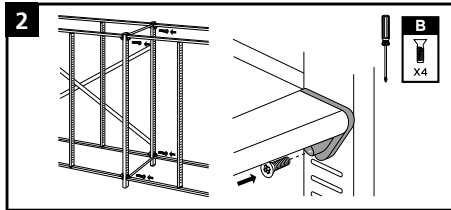
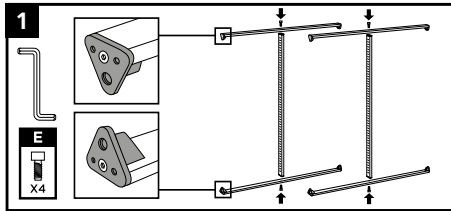
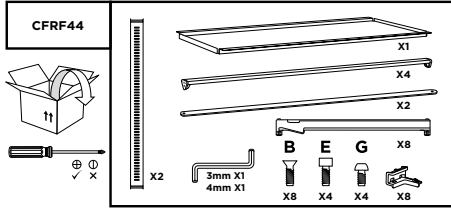

3. Treble column unit

CFRC44 + CFRB44

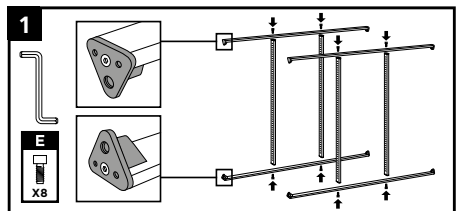
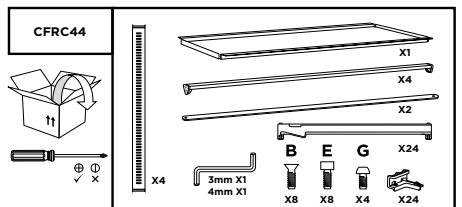

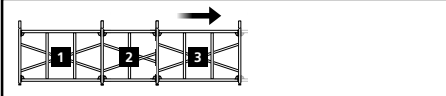
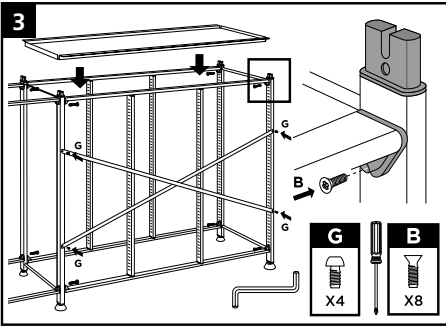
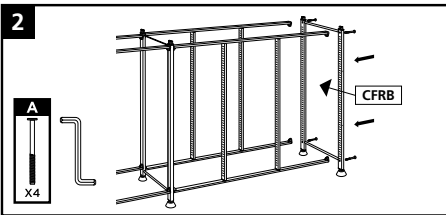
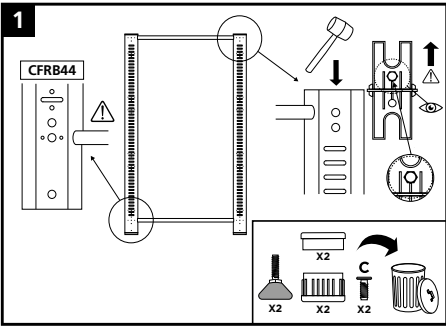
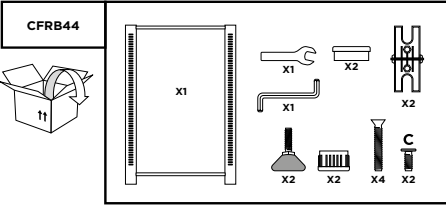
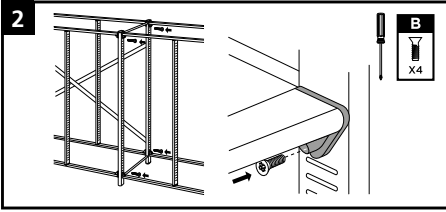

4. Maker unit

CFRN44 + CFRB44

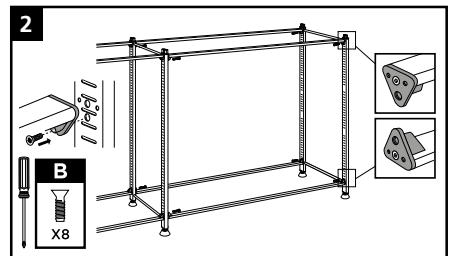
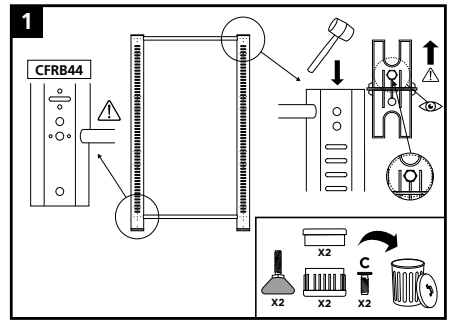
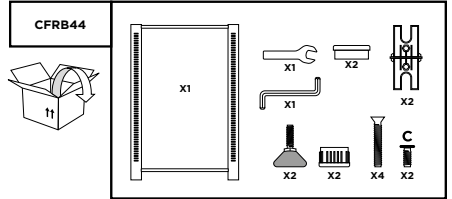
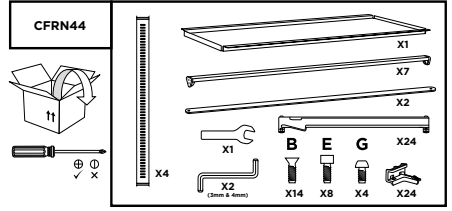
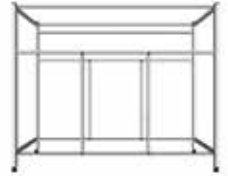

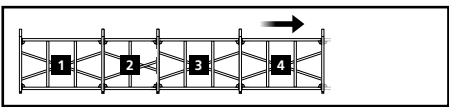
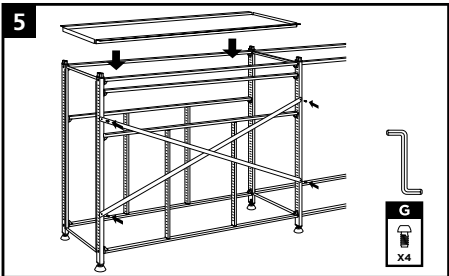
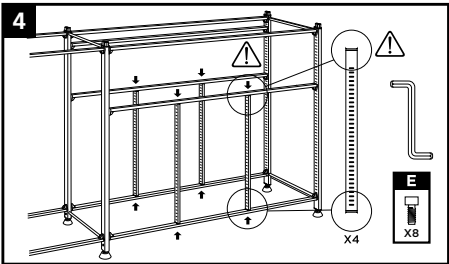
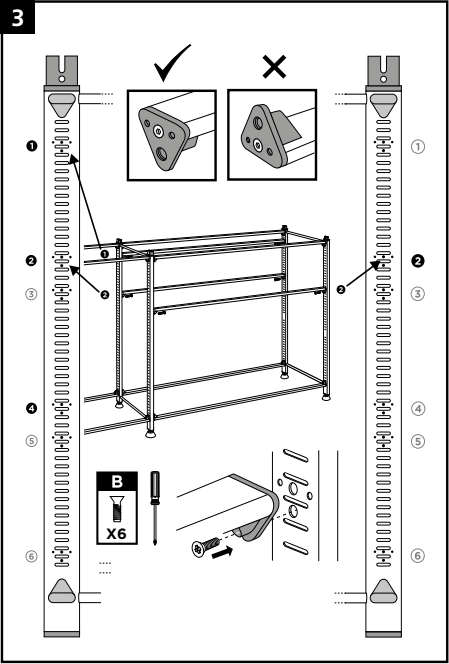

5. Tilted tray unit

CFRD44 + CFRB44

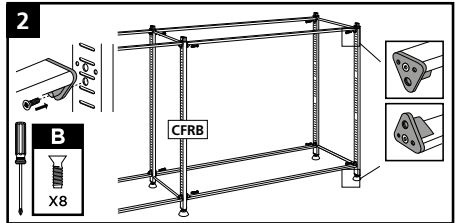
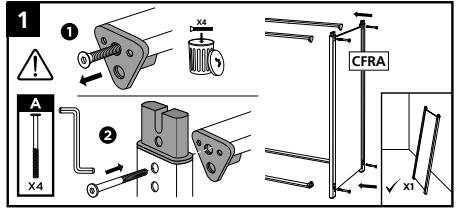
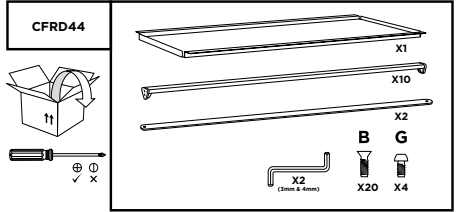

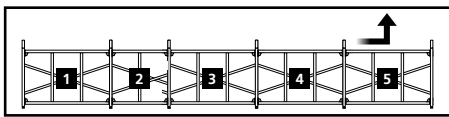
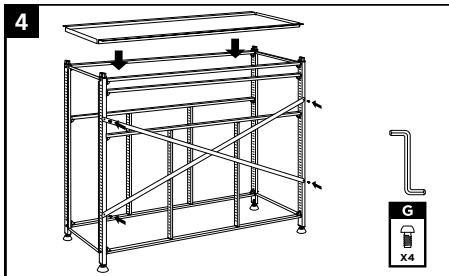
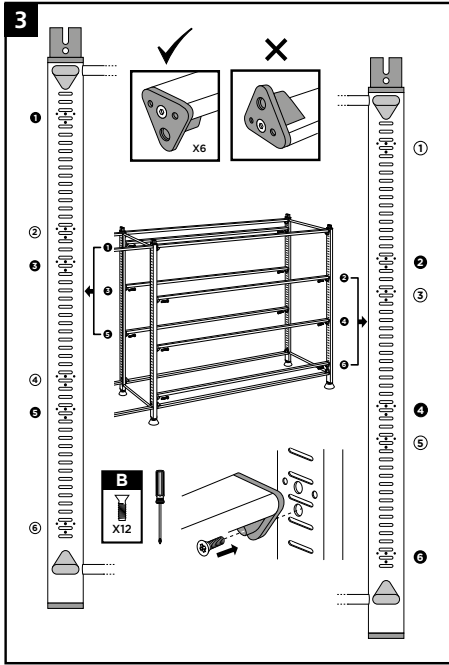

6. Treble column unit
CFRA44 + CFRC44
+ CFRB44

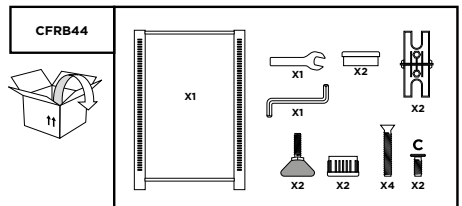
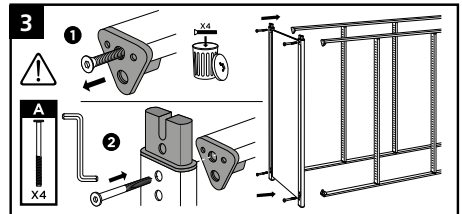
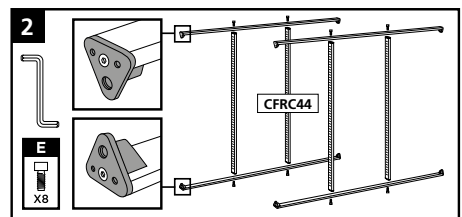
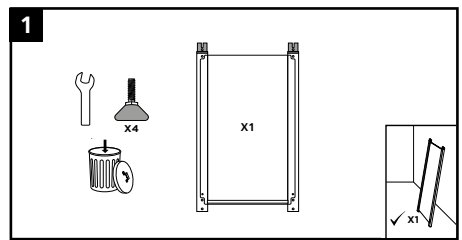
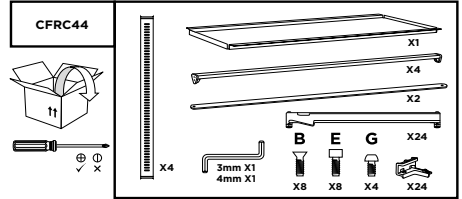
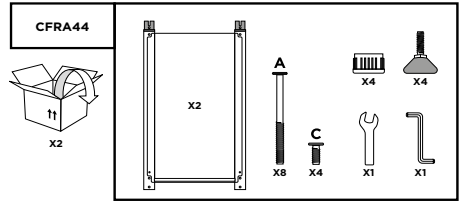

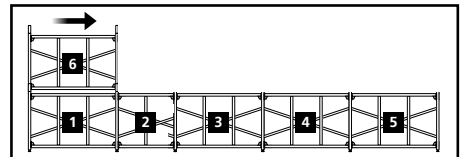
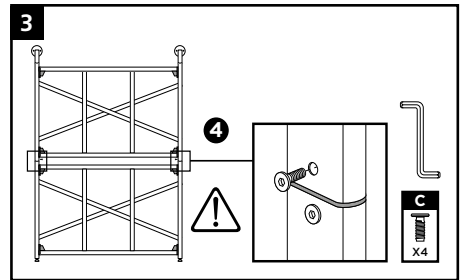
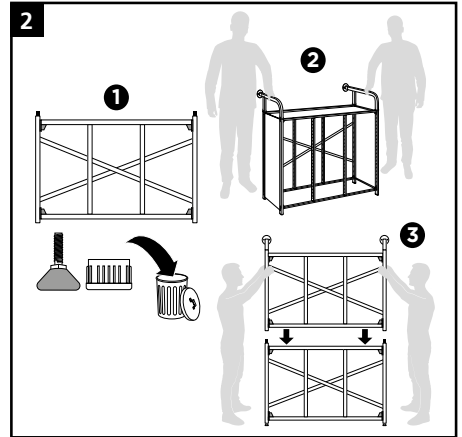
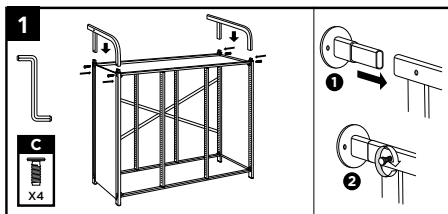
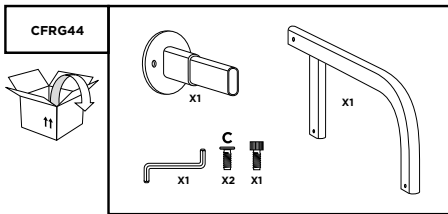
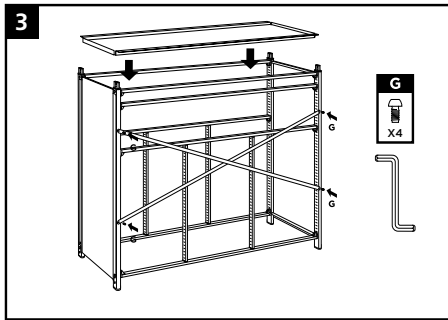
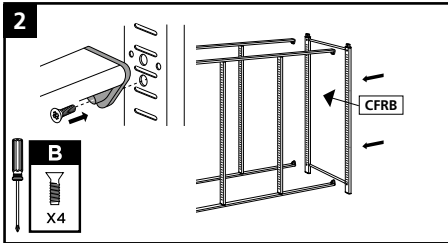
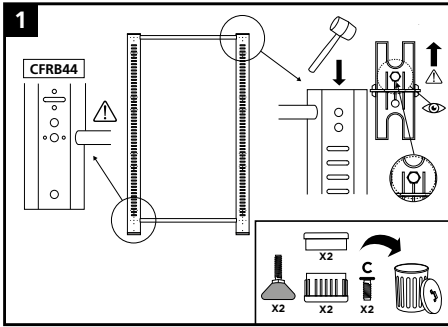

7. Double column unit

CFRF44 = CFRB44

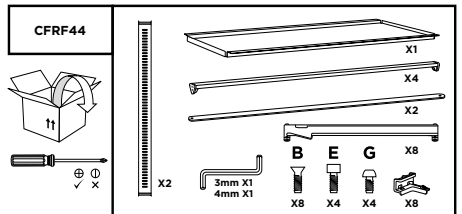

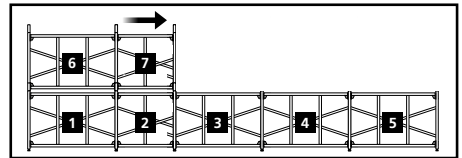
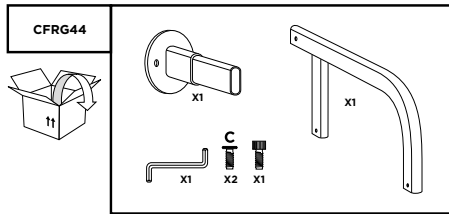
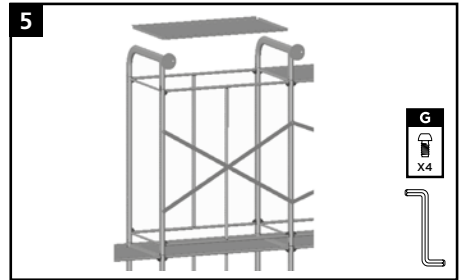
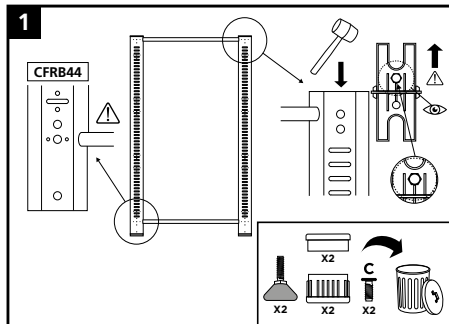
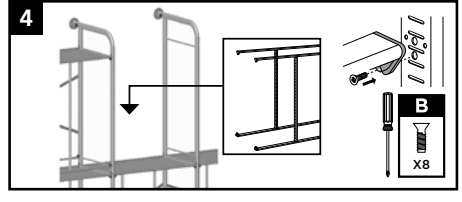
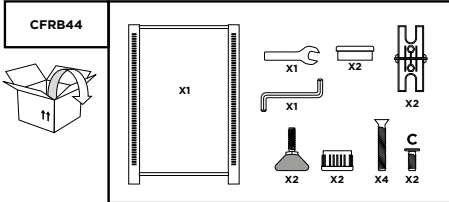
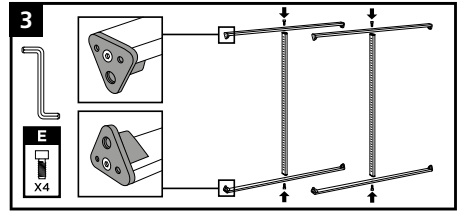
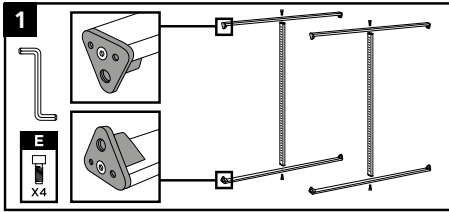

8. Flat shelf unit

CFRM44 + CFRB44

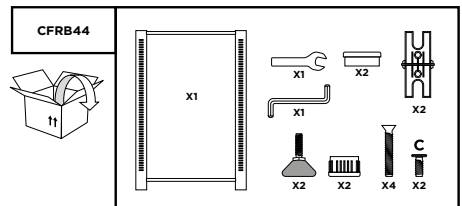
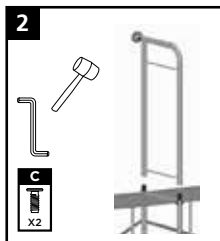
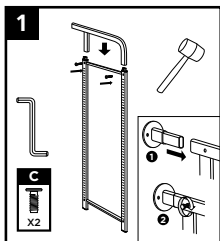

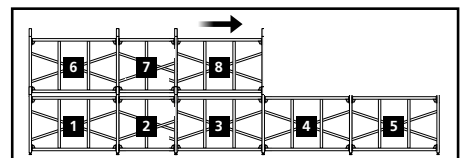
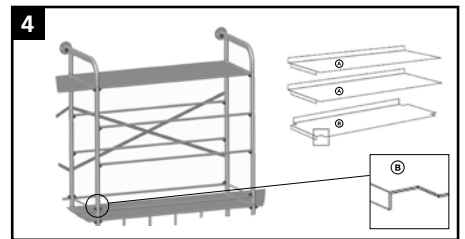
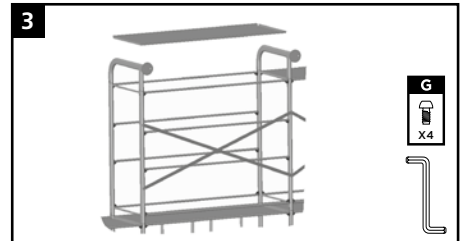
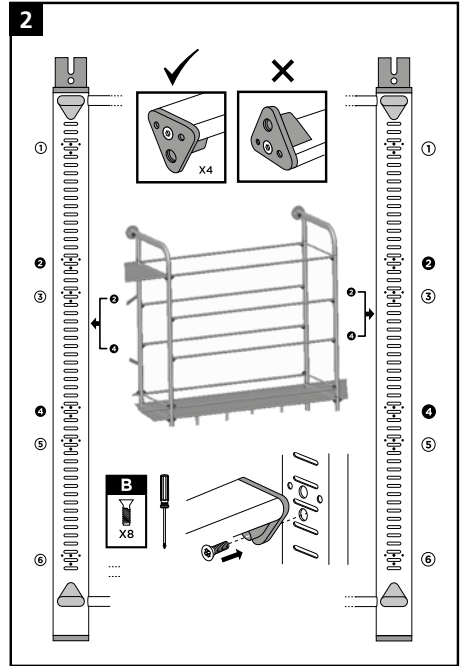
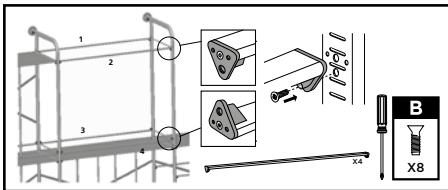
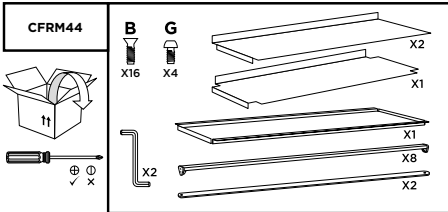
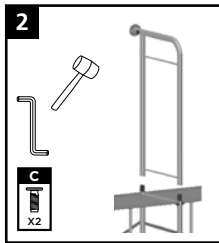
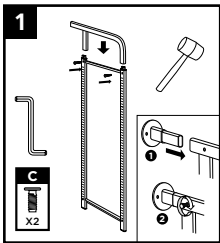
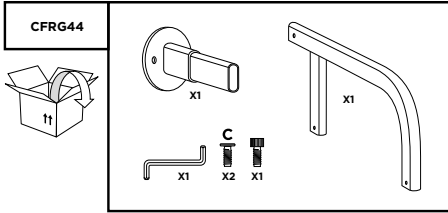
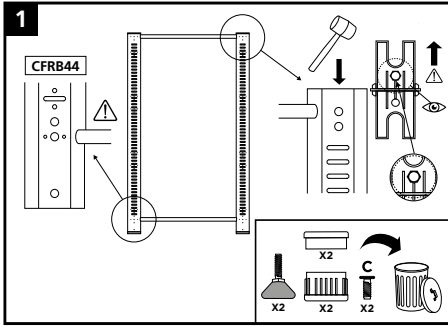

9. Treble column unit

CFRC44 + CFRB44

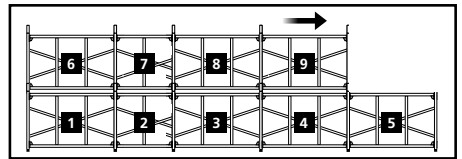
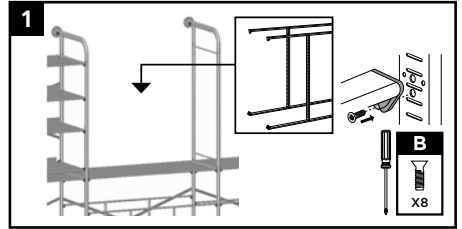
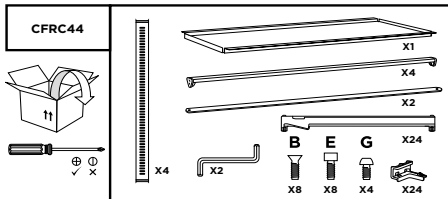
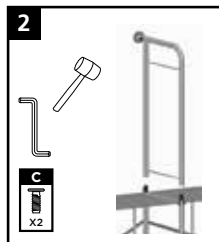
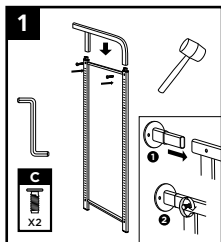
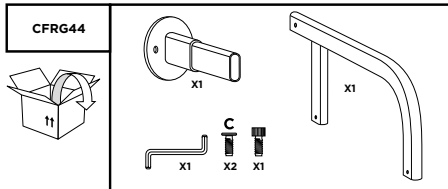
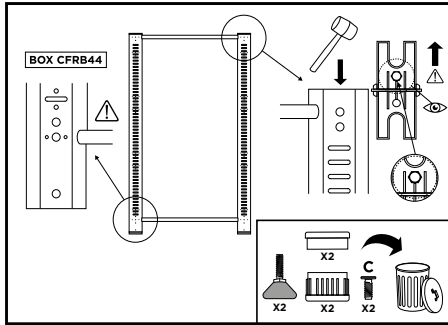
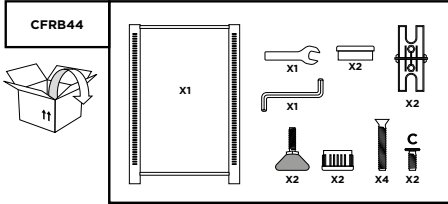

10. Treble column unit

CFRA44 + CFRC44 + CFRB44

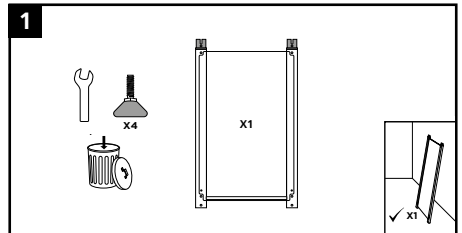
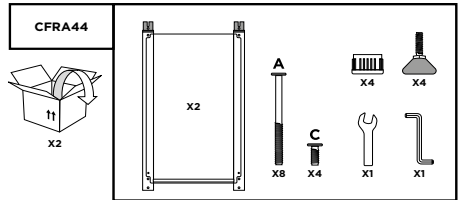

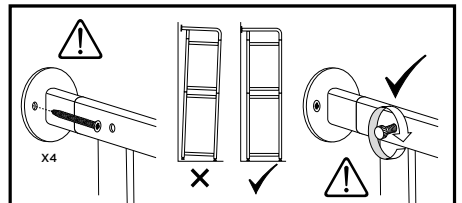
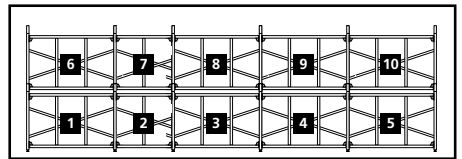
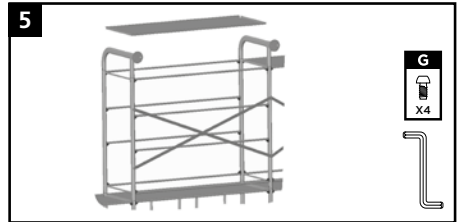
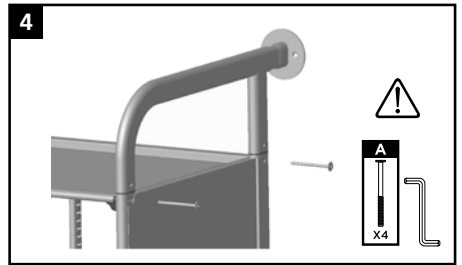
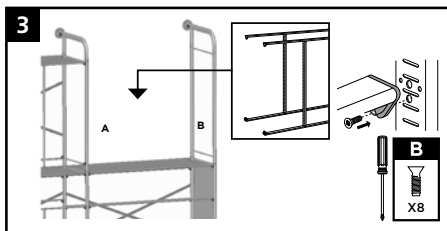
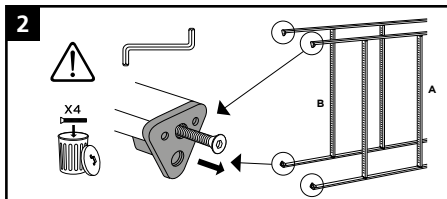
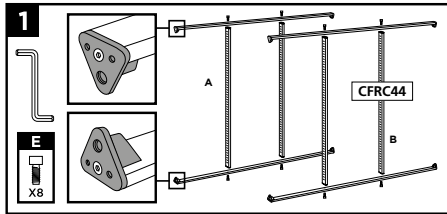
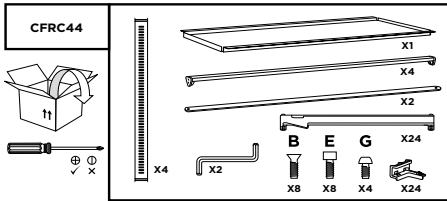
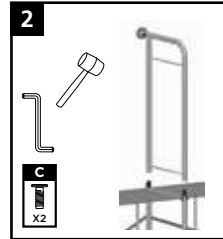
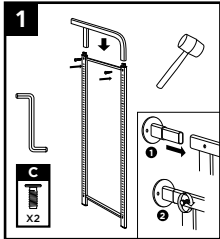
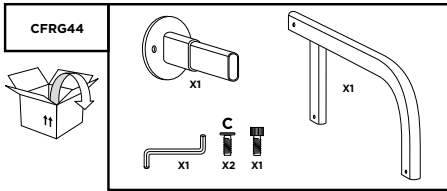

Warning!
Wall brackets must be fixed to a suitable load-bearing wall.

¡Advertencia!
Soportes de pared deben fijarse a un muro de carga adecuados.

Warnung!
Wandhalterung muss an eine geeignete tragenden Wand befestigt werden.

Attenzione!
Staffe a muro devono essere fissati ad una parete adatta portante.

Attention!
Les fixations murales doivent être fixés à un mur porteur approprié.



Runners and Tray spacing guide

