



# Assembly instructions

Instrucciones de montaje  
Instructions de montage





# Contents / Contenu / Contenido

P4 - P10 : Starter units / unités initiales / unidades iniciales

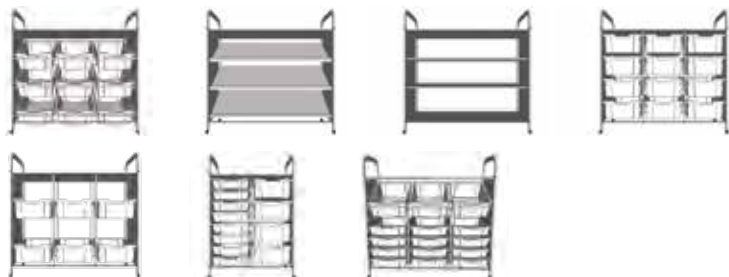

P11 - P22 : Additional units / unités supplémentaires / unidades adicionales



P22 - P31 : Tall starter units / unités hautes initiales / unidades altas iniciales

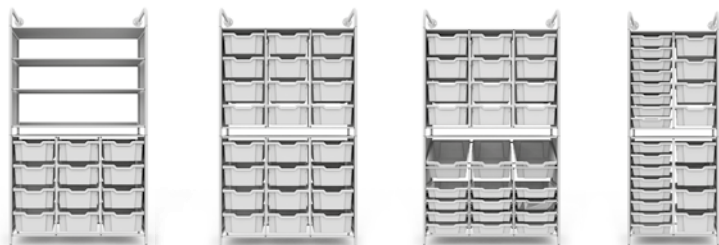

P32 - P42 : Additional tall units / unités hautes supplémentaires / unidades altas adicionales

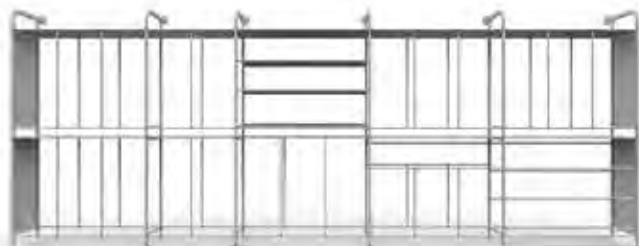

P43 : Supplementary information / Information supplémentaire / Información suplementaria

[StoreMoreStore.com](http://StoreMoreStore.com) | 855-786-7667 | [sales@storemorestore.com](mailto:sales@storemorestore.com)

# Double column unit

Dimensions: 995(H) x 690(W) x 430mm(D)



11  
CFRA44 x 1  
CFRF44 x 1  
CFRH44 x 1

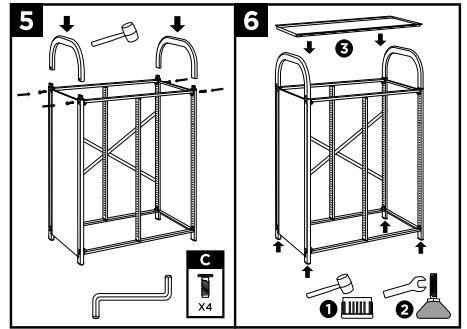
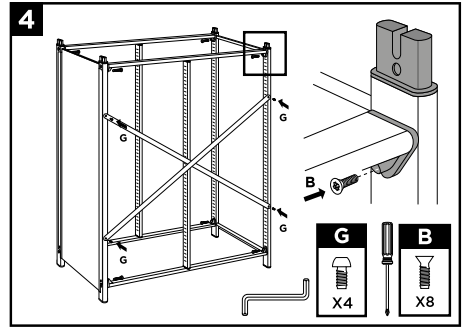
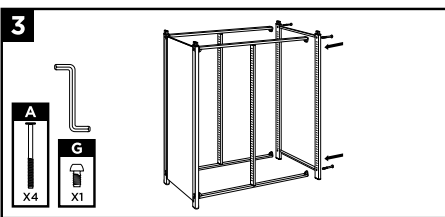
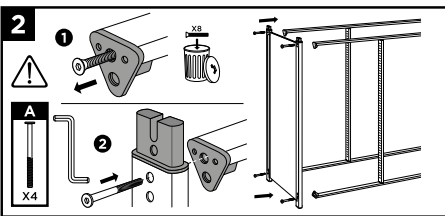
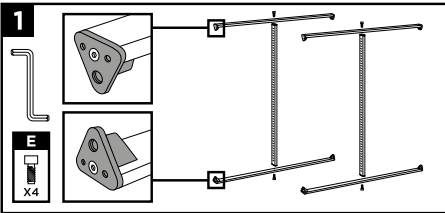
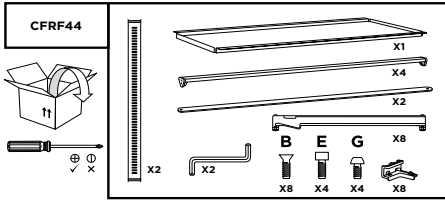
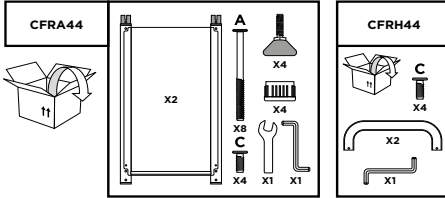

# Treble Column Unit

Dimensions: 995(H) x 1025(W) x 430mm(D)

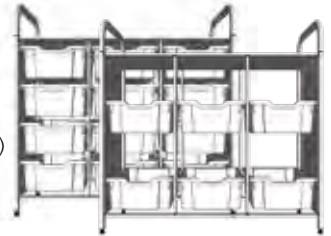

11  
CF.....  
CFRC44 x 1  
CFRH44 x 1

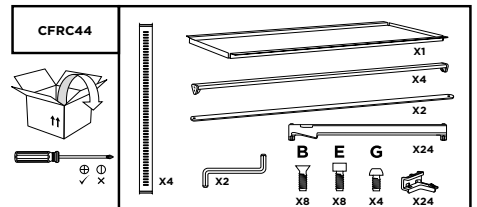
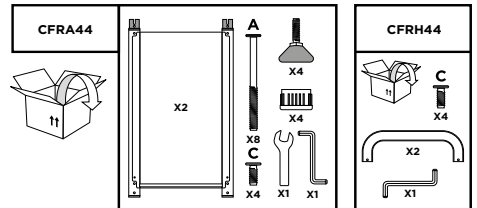

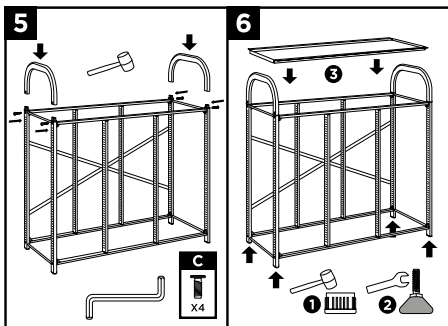
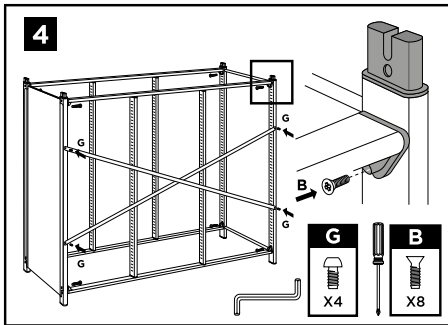
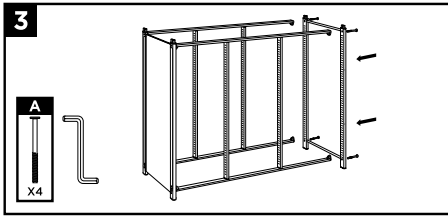
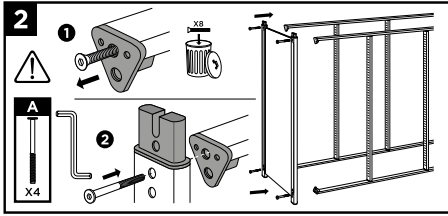
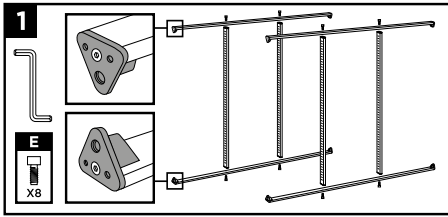

## Flat shelf unit

Dimensions: 995(H) x  
1025(W) x 430mm(D)

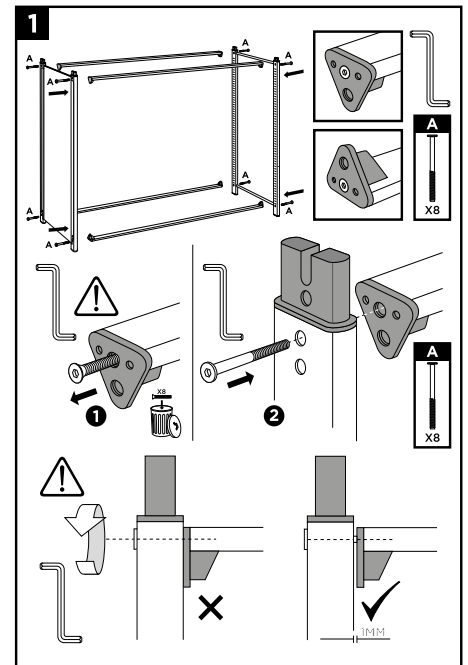
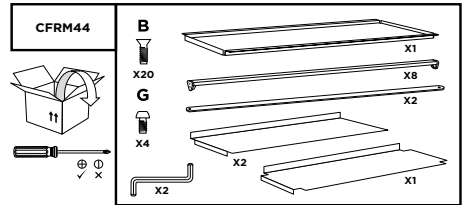
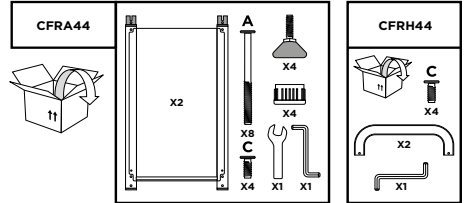

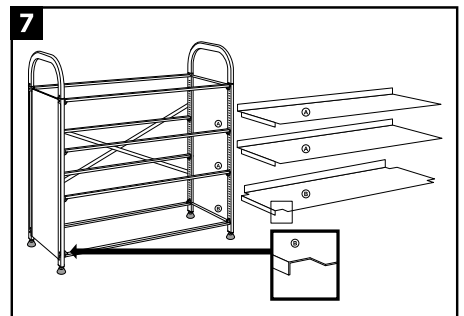
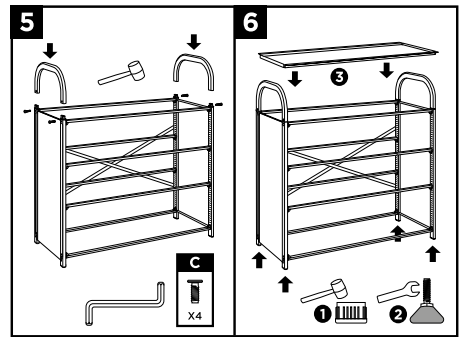
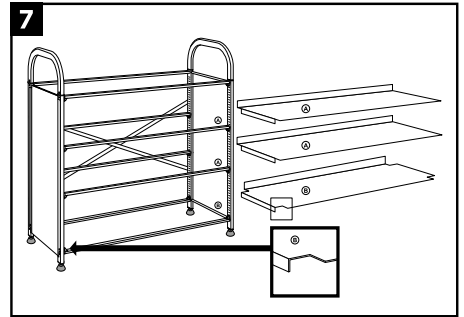
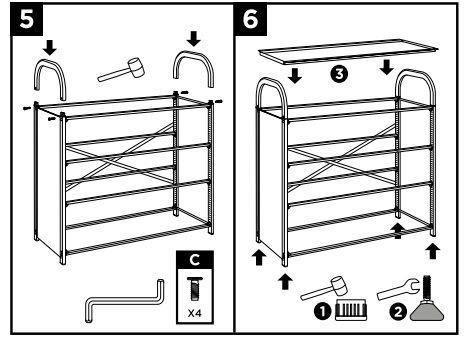
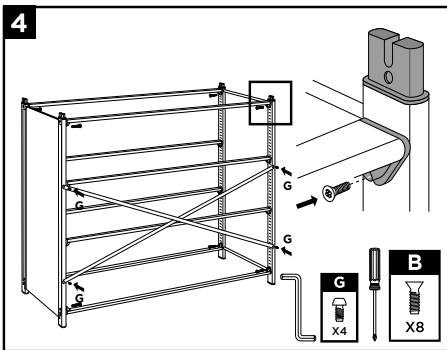
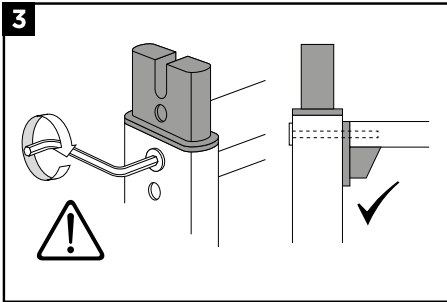
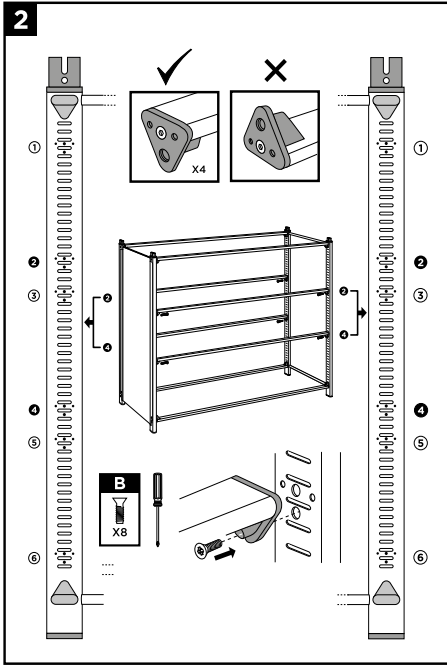

# Titled shelf unit

Dimensions: 995(H) x 1025(W) x 430mm(D)



11  
CFRA44 x 1  
CFRD44 x 1  
CFRH44 x 1

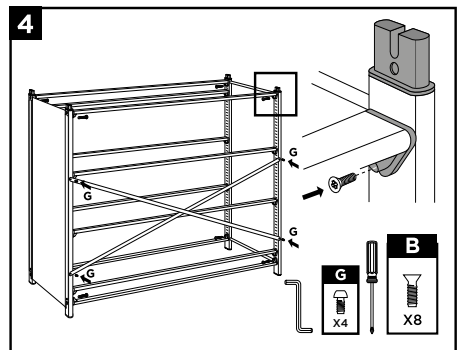
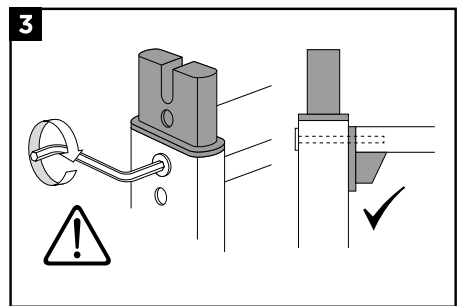
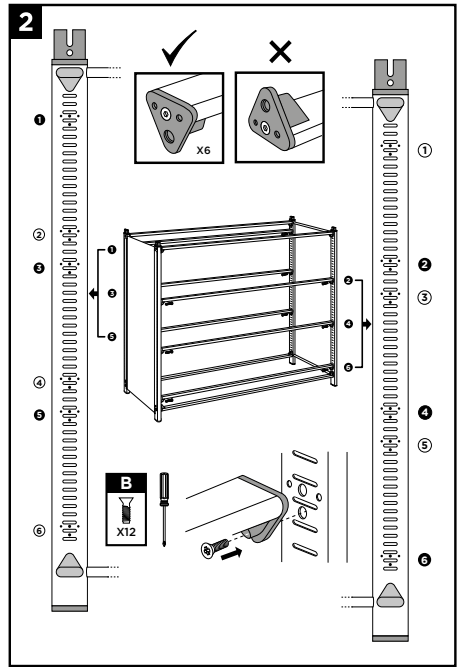
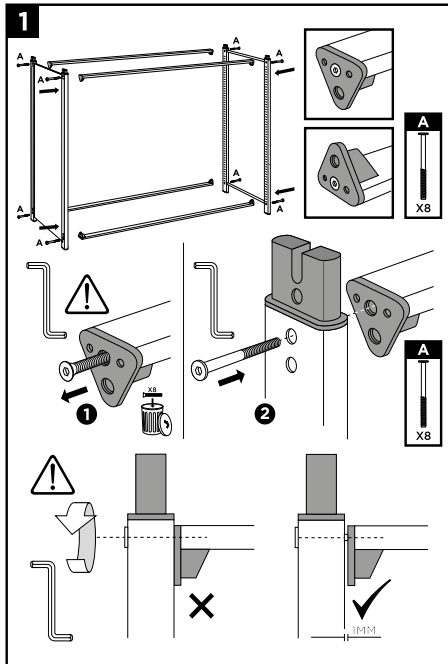
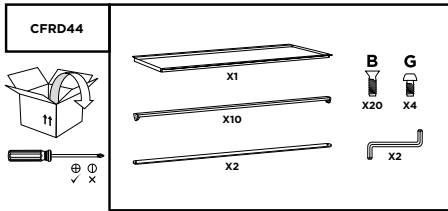
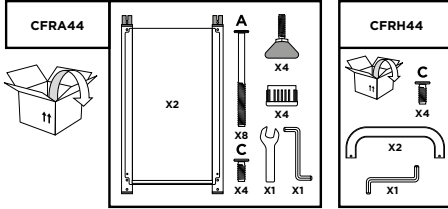

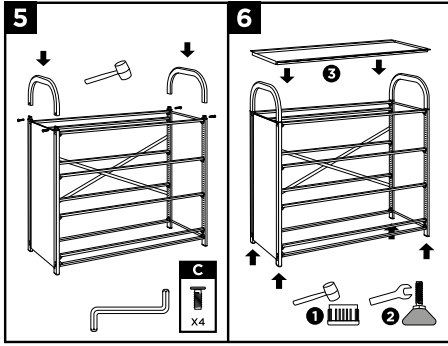

### Titled tray unit

Dimensions: 995(H) x 1025(W) x 430mm(D)

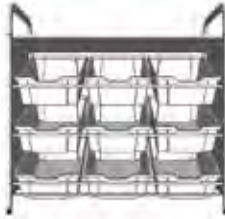

 CFRA44 x 1  
 CFRE44 x 1  
 CFRH44 x 1

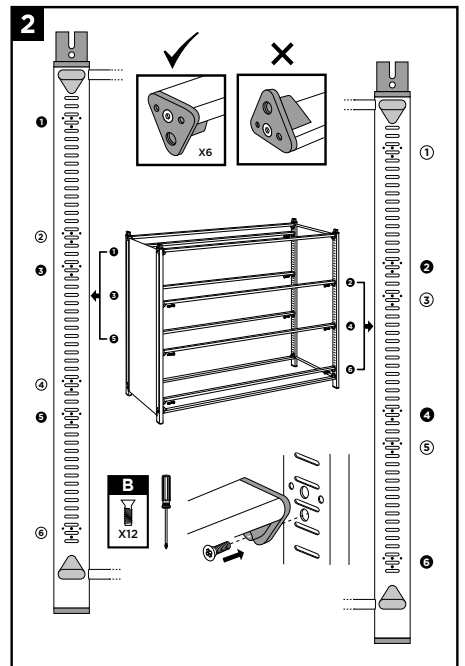
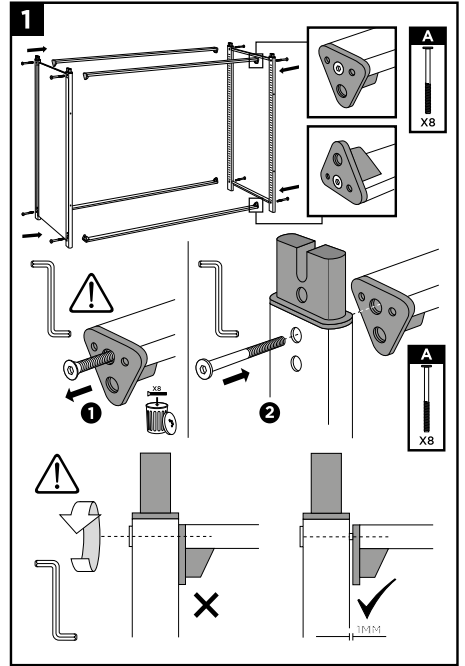
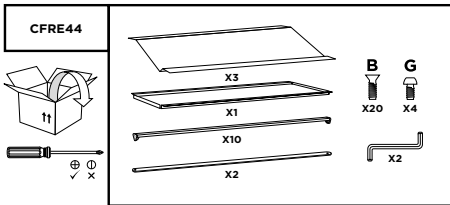
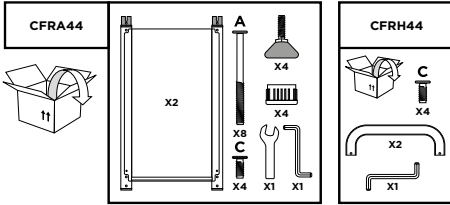





## Maker unit

Dimensions: 995(H) x 1025(W) x 430mm(D)



CFRA44 x 1  
CFRN44 x 1  
CFR44 x 1

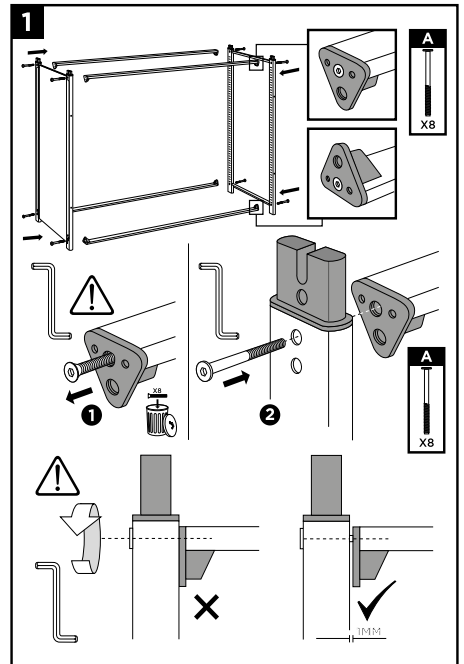
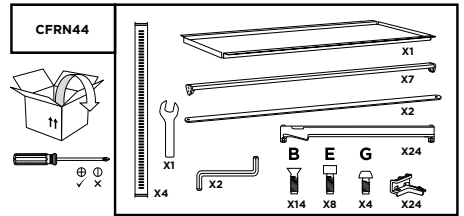
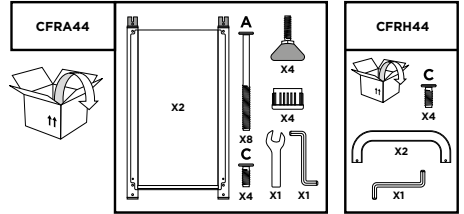
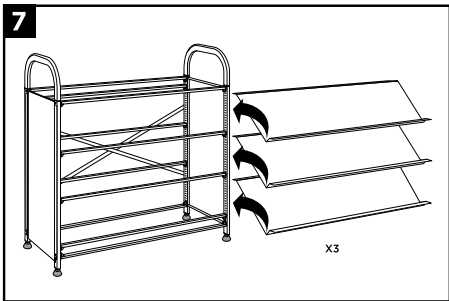
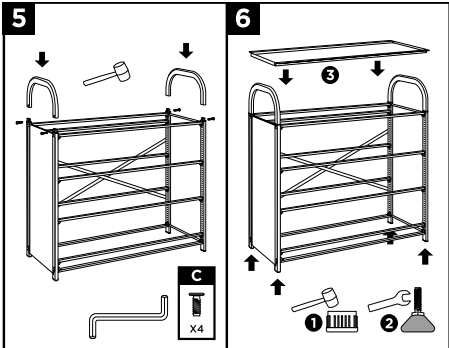
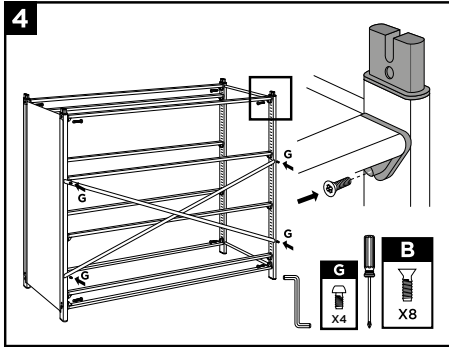
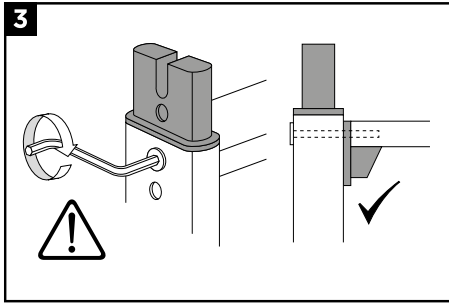

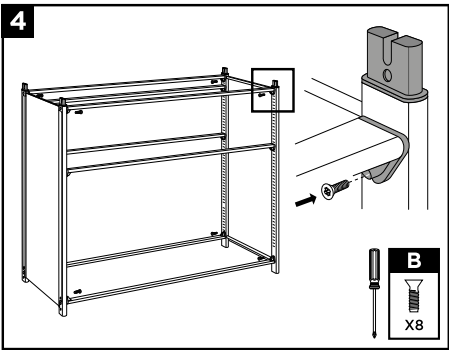
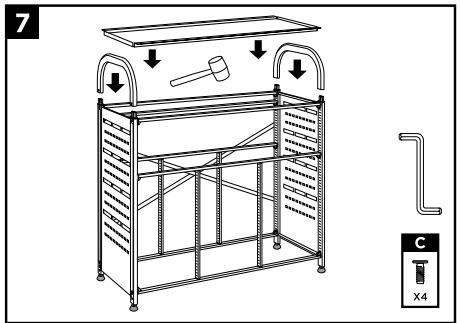
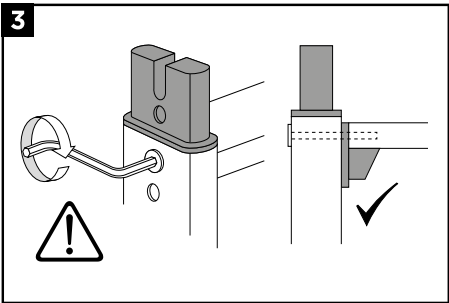
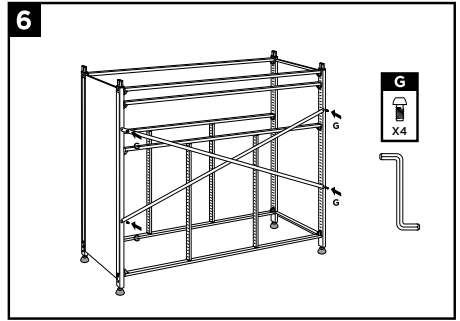
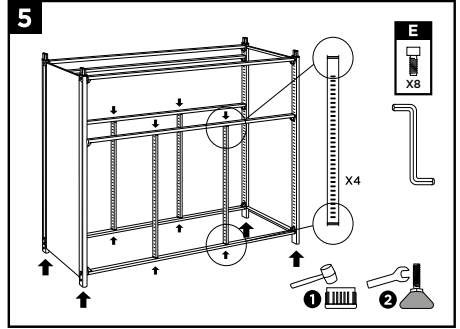
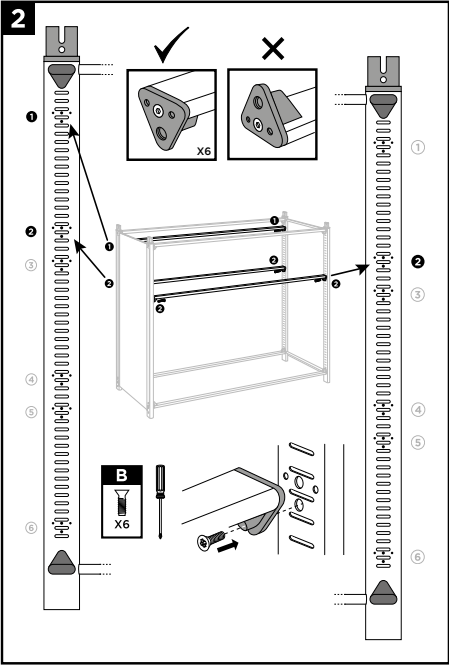

# Double column unit

Dimensions: 995(H) x 690(W) x 430mm(D)



**CFRB44 x 1**  
**CFRF44 x 1**

**CFRB44**

**CFRF44**

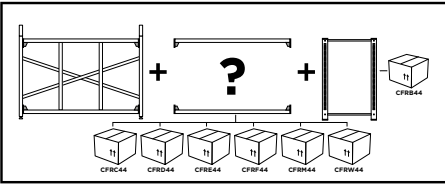
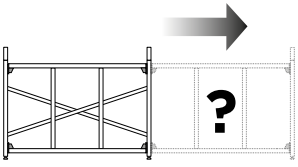

**1**

**2**

**3**

**4**

**5**

**6**



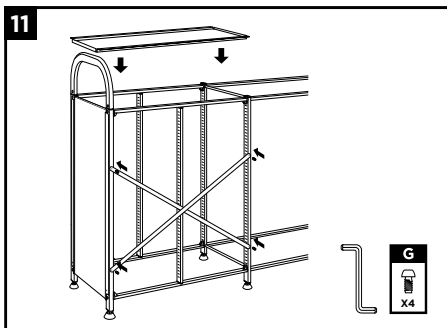
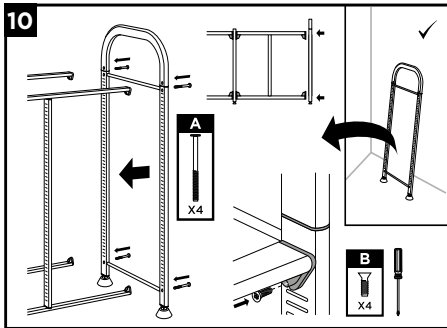
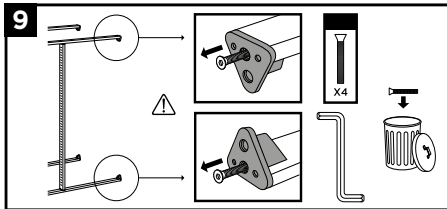
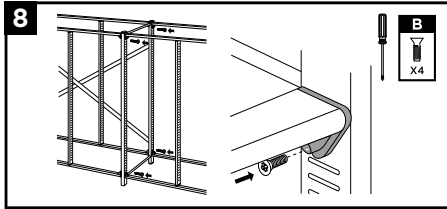
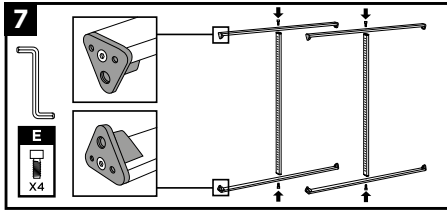

## Treble column unit

Dimensions: 995(H) x 1025(W) x 430mm(D)

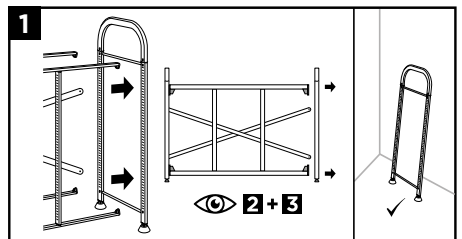
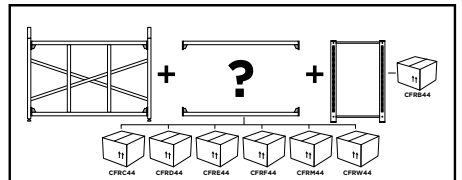
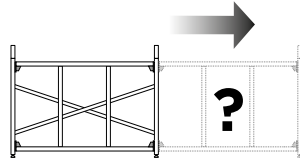
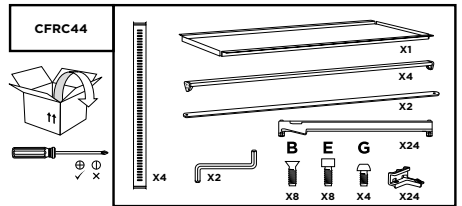
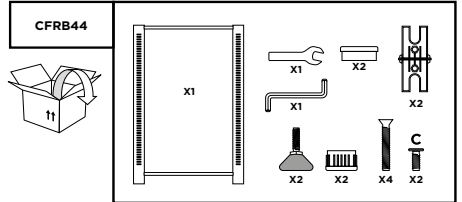
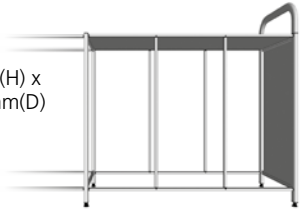

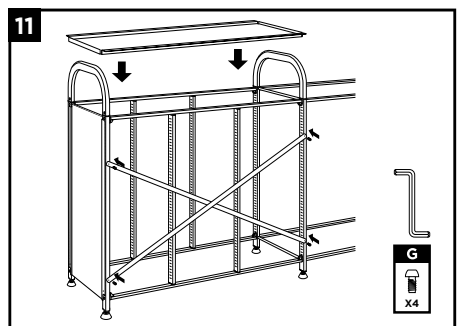
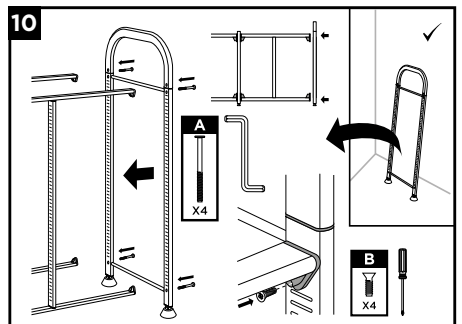
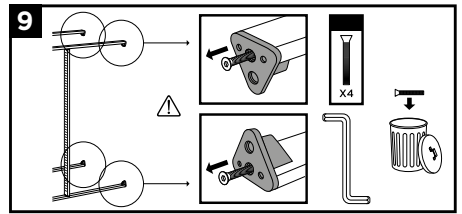
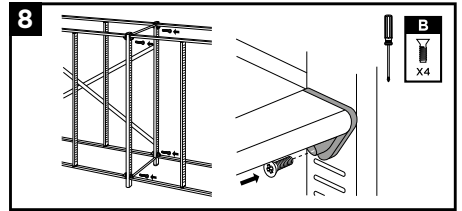
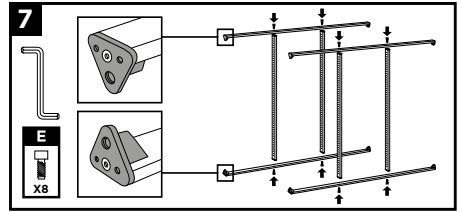
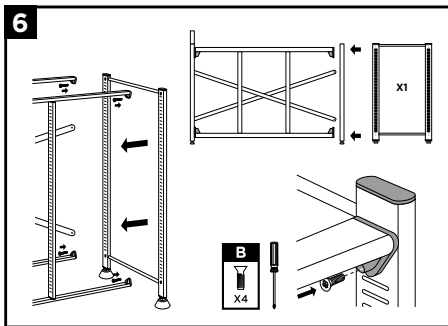
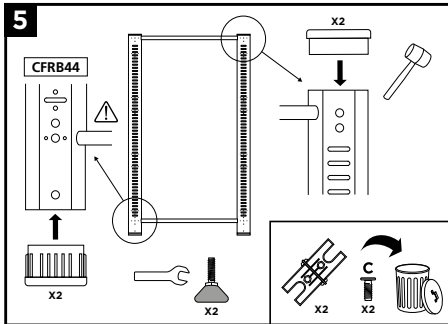
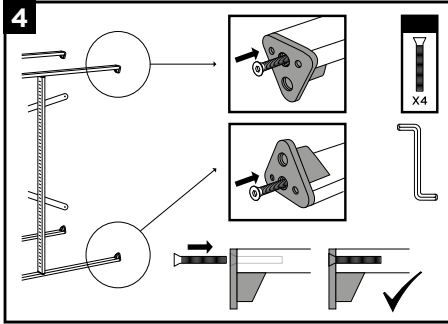
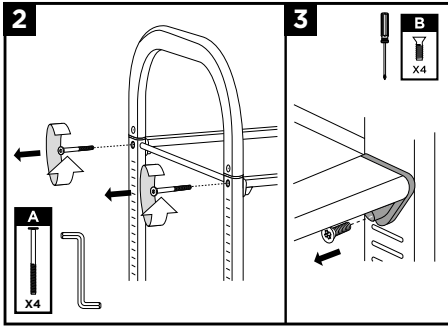

# Flat shelf unit

Dimensions: 995(H) x 1025(W) x 430mm(D)

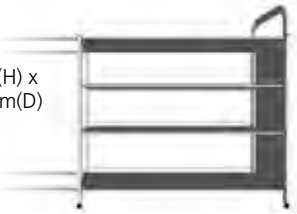

CFRB44 x 1  
CFRM44 x 1

**CFRB44**

**CFRM44**

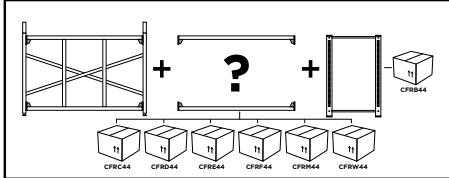
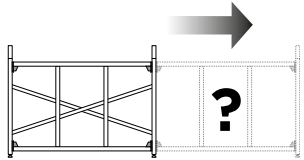

**1**

**2**

**3**

**4**

**5**

**6**

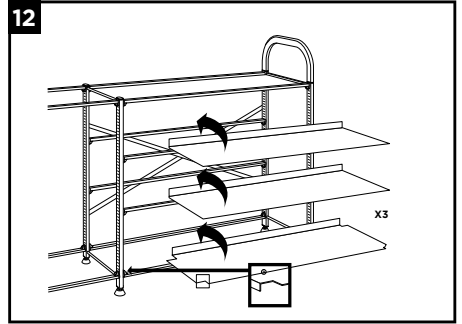
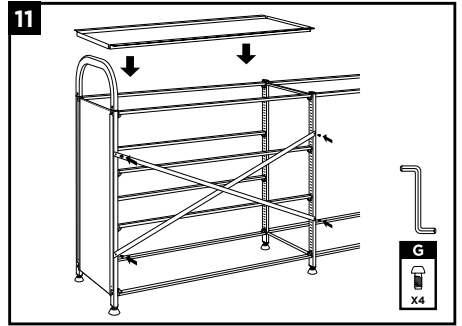
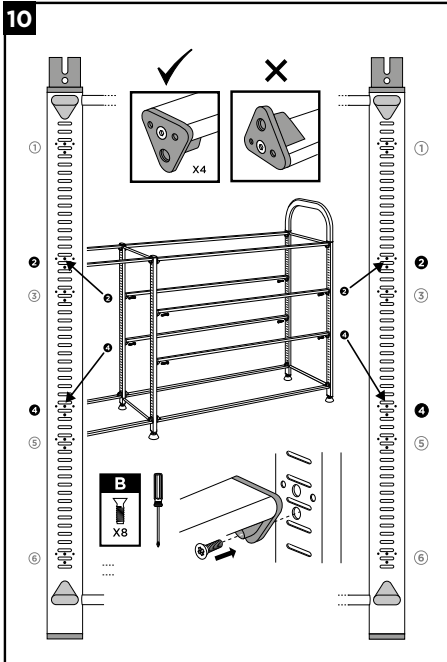
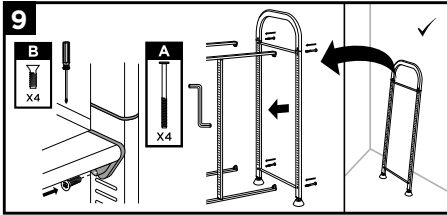
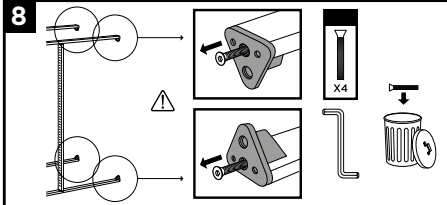
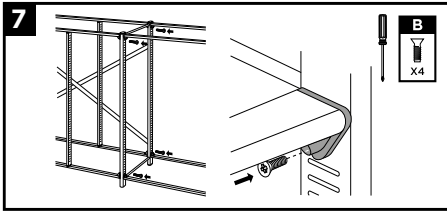

## Tilted tray unit

Dimensions: 995(H) x 1025(W) x 430mm(D)

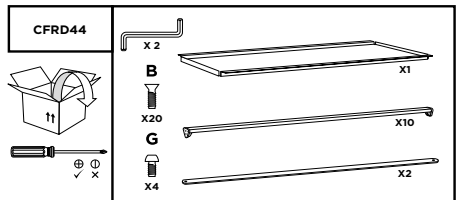
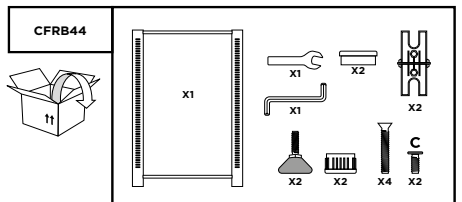
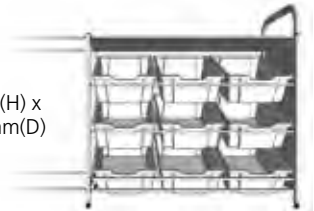

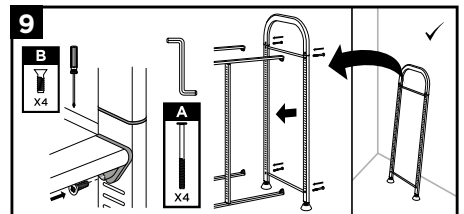
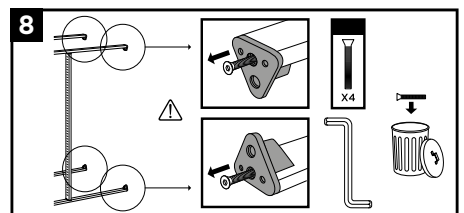
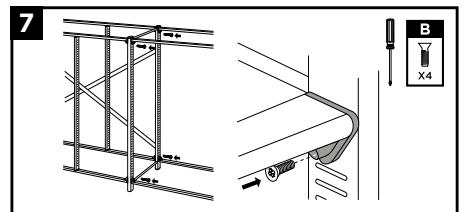
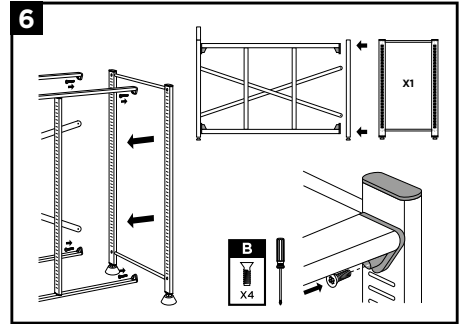
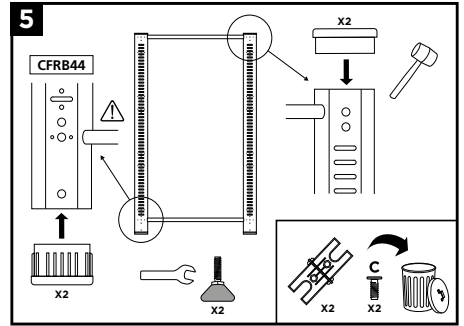
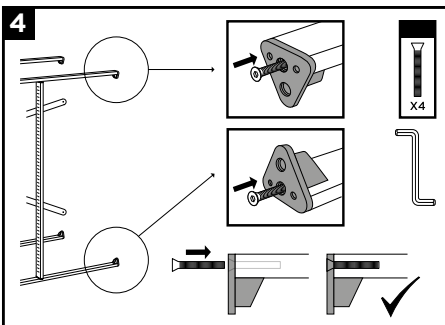
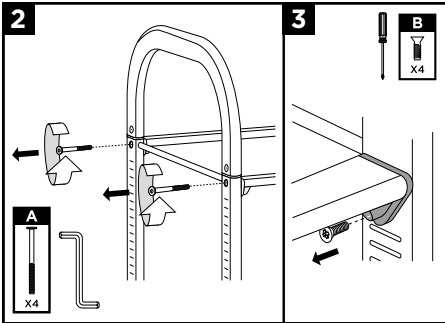
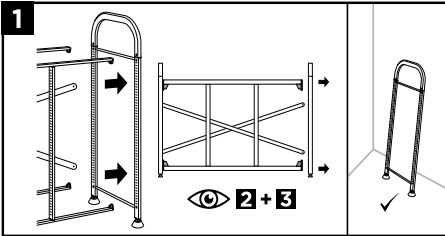
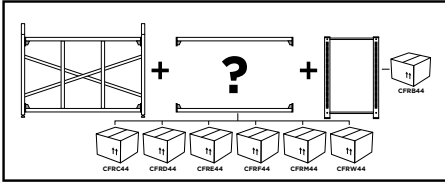
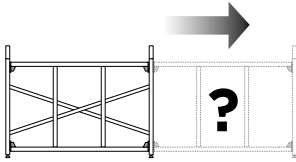



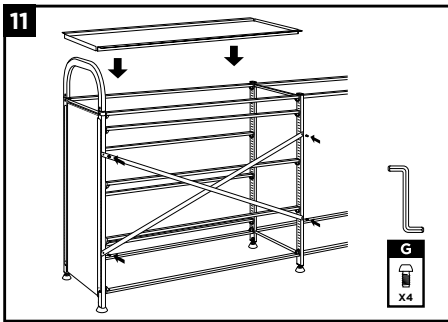
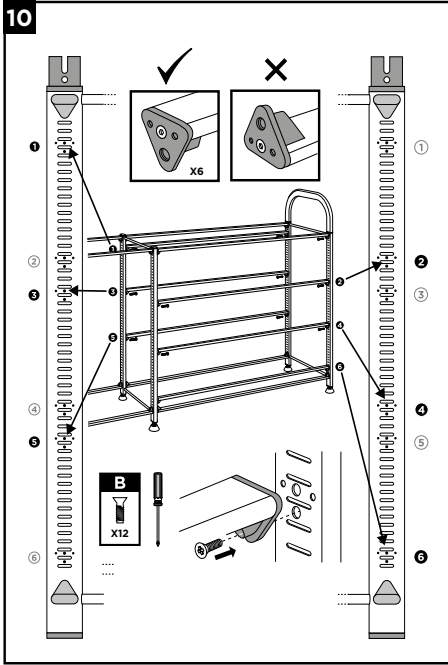

## Tilted shelf unit

Dimensions: 995(H) x 1025(W) x 430mm(D)

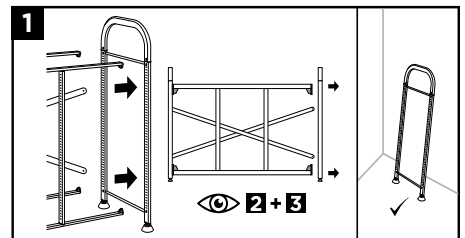
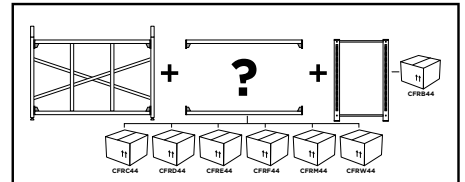
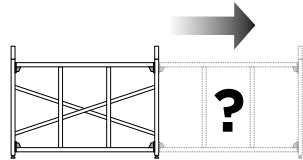
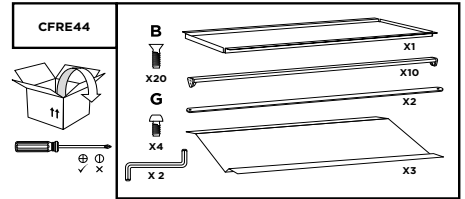
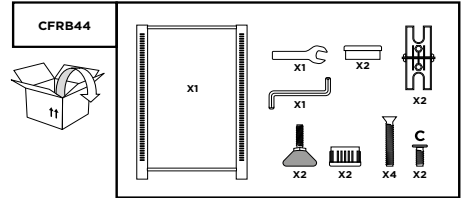

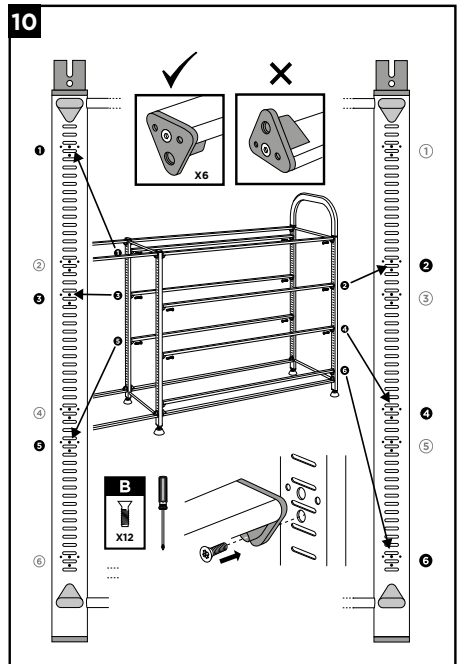
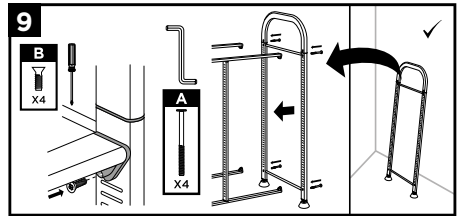
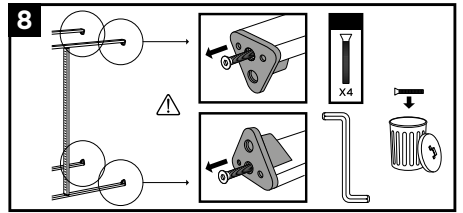
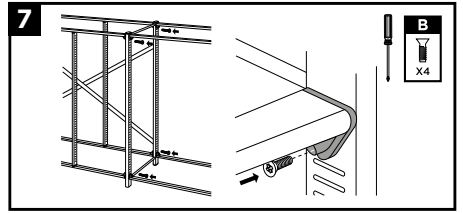
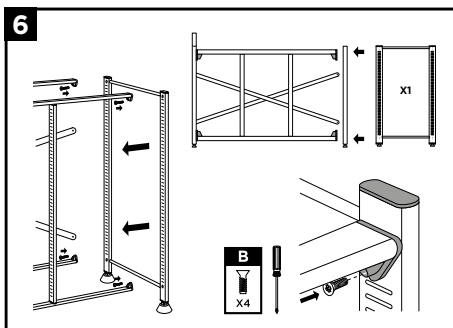
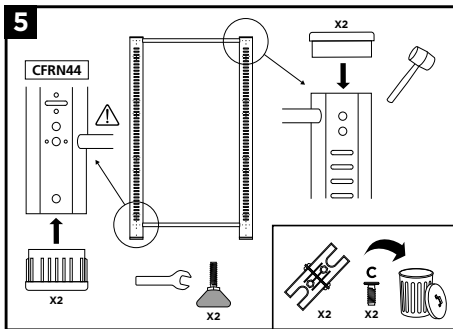
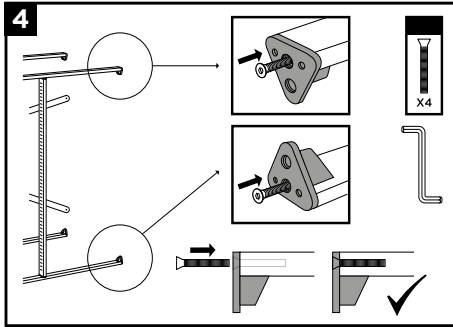
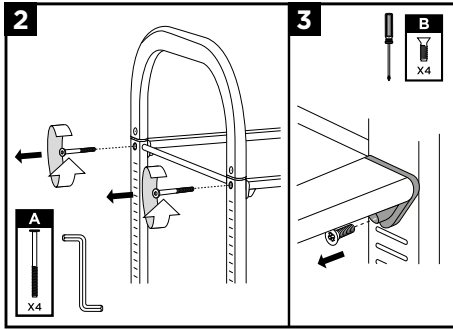

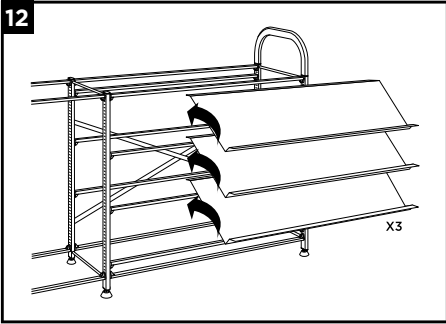
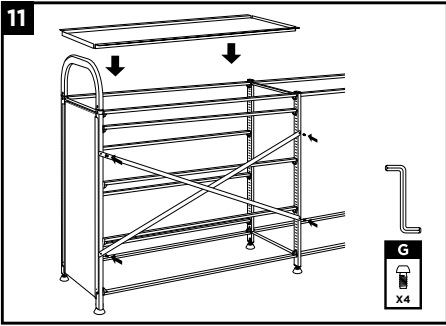

**Maker unit**

Dimensions: 995(H) x 1025(W) x 430mm(D)

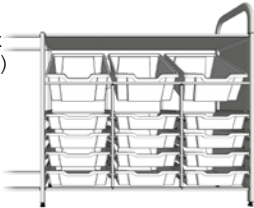

 **CFRB44 x 1**  
**CFRN44 x 1**

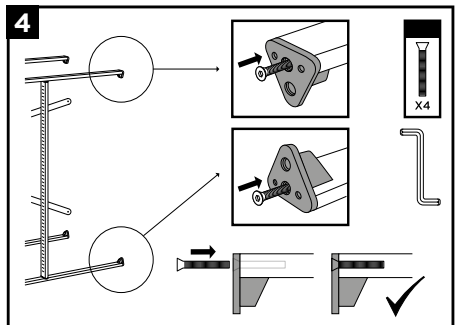
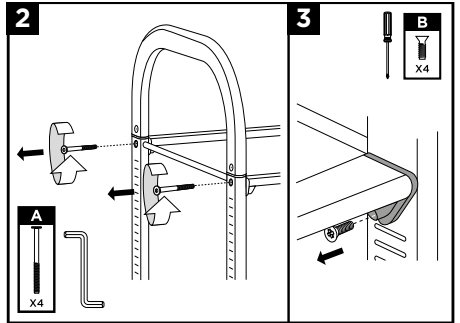
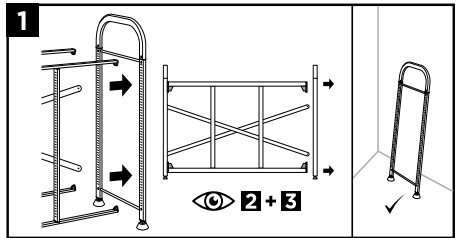
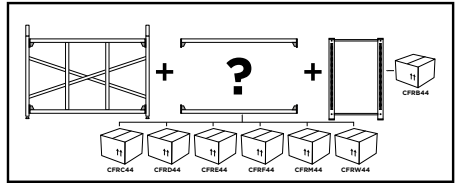
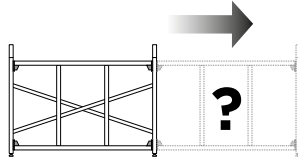
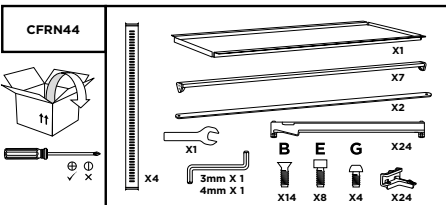
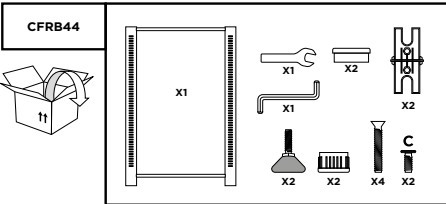

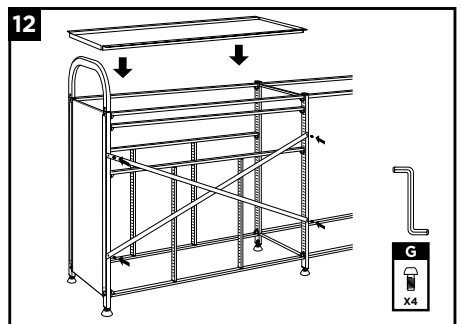
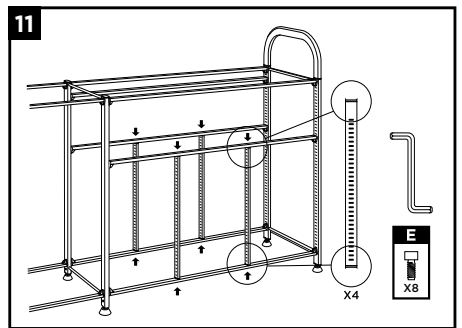
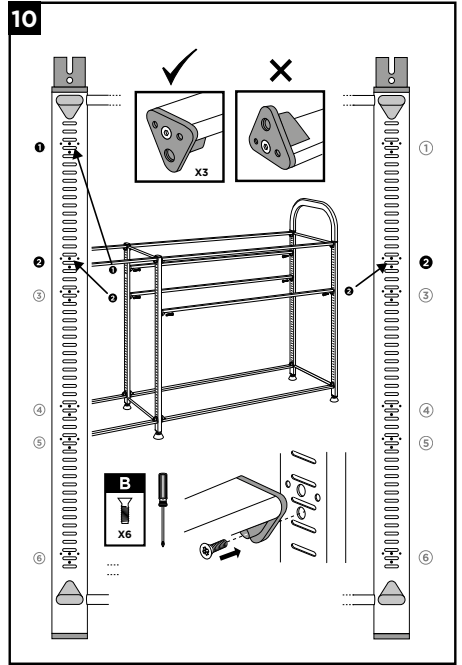
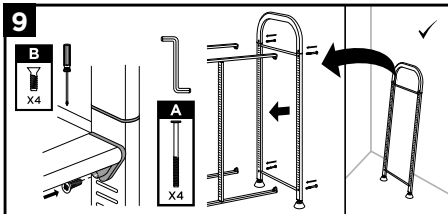
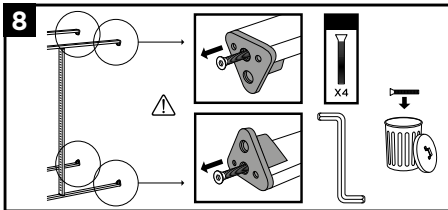
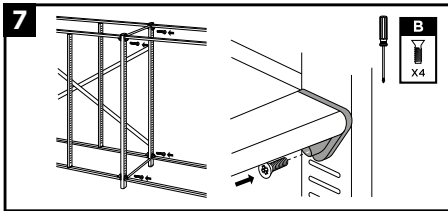
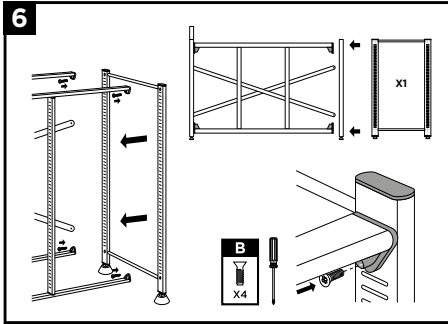
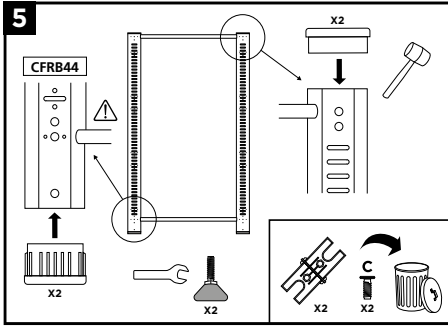

# Low adder workstation

Dimensions: 995(H) x 690(W) x 430mm(D)

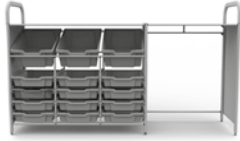

CFRB44 x 1  
CFRW44 x 1

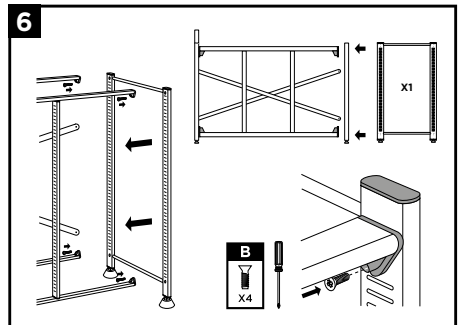
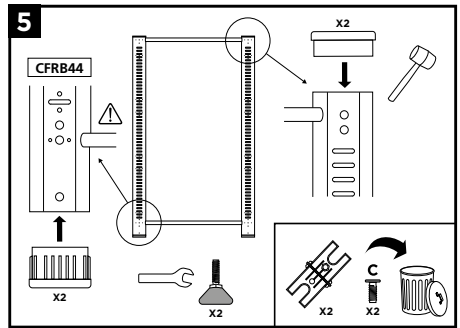
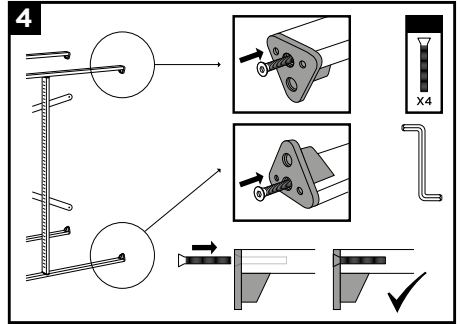
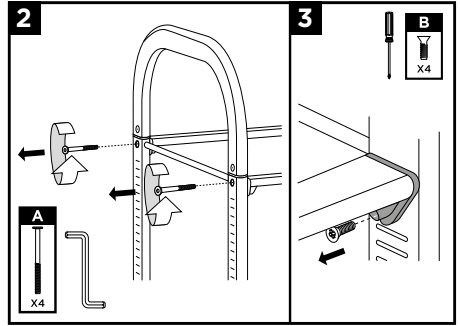
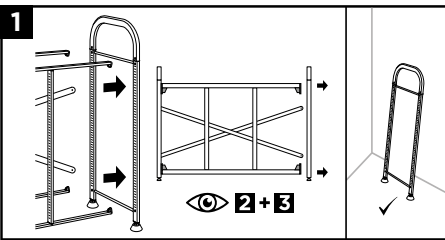
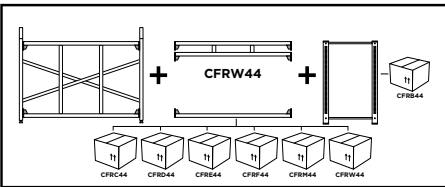
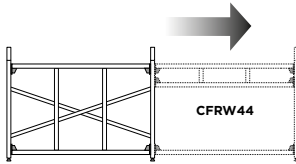
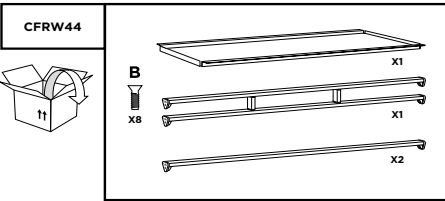
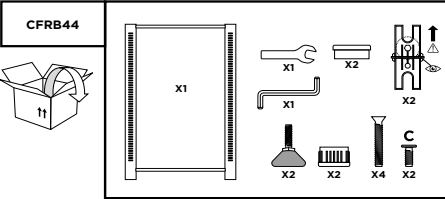

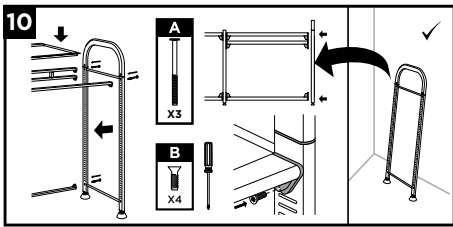
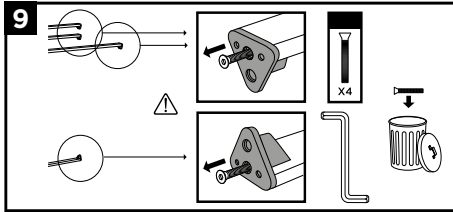
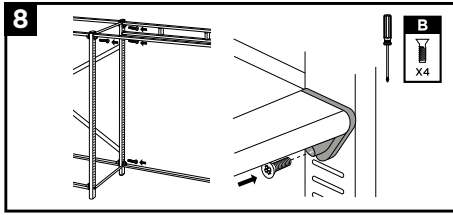

## Display-store unit

Dimensions: 1806(H) x  
1025(W) x 430mm(D)



**1t**  
CFRA44 x 2  
CFRC44 x 1  
CFRM44 x 1  
CFRG44 x 2

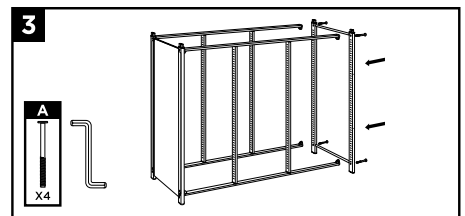
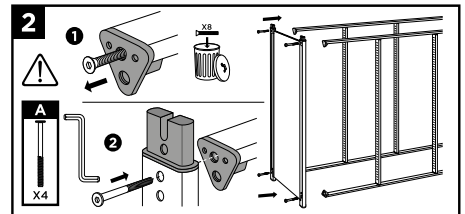
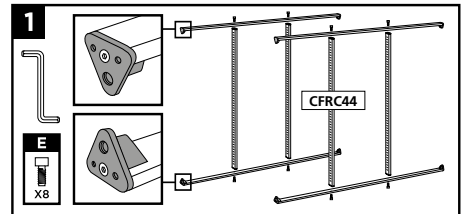
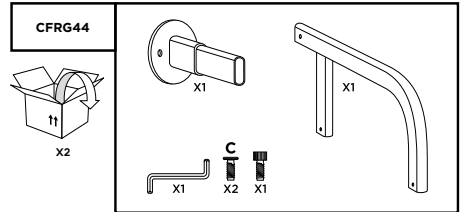
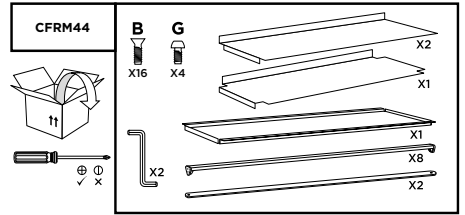
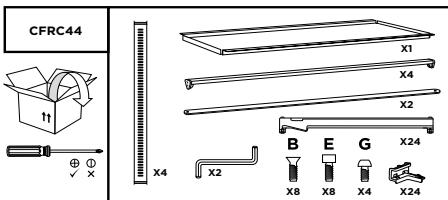
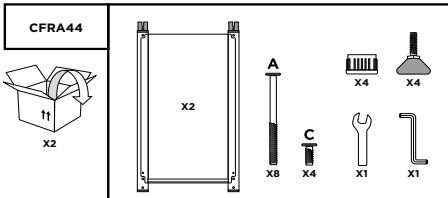

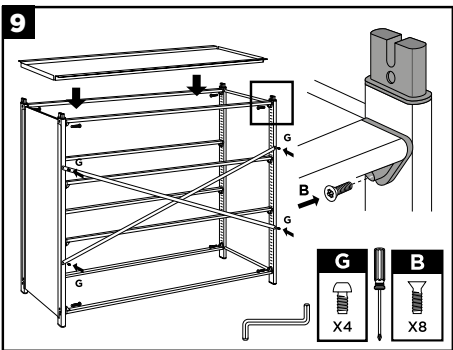
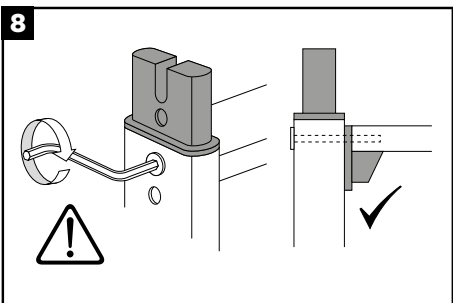
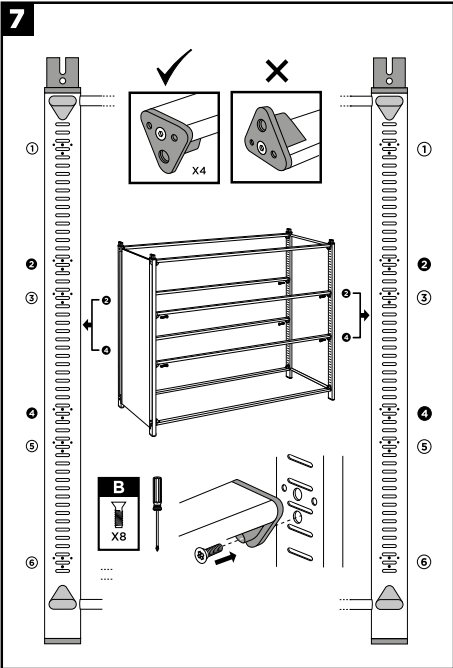
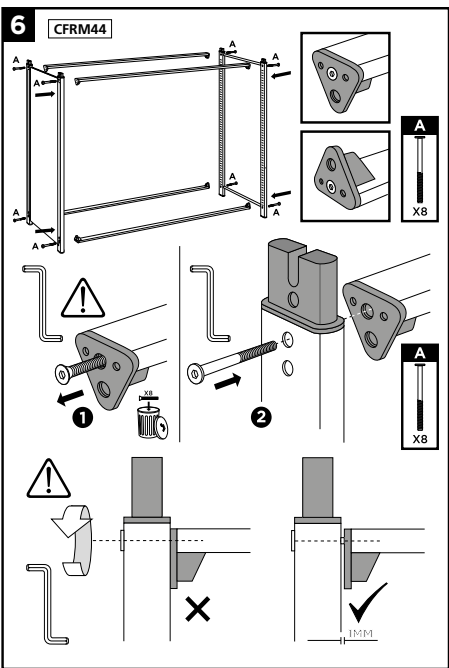
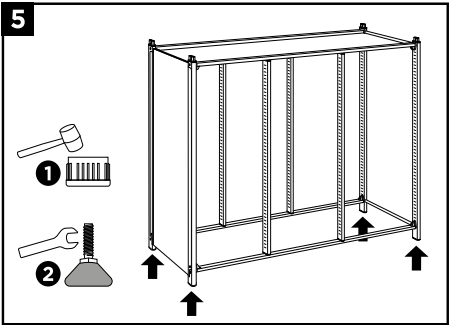
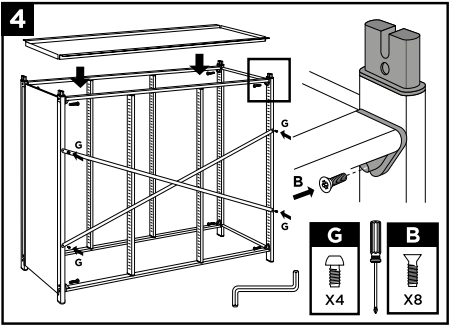

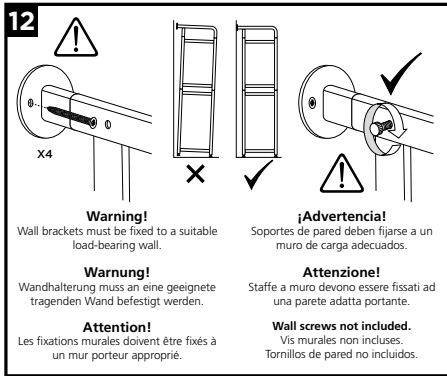
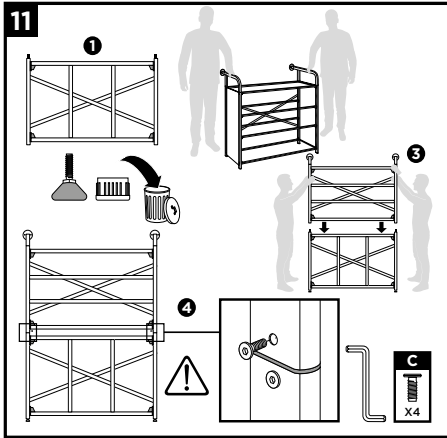
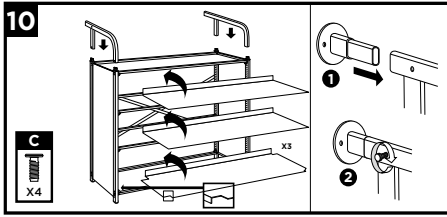

## Tall-store unit and Flexi-store unit

Dimensions: 1806(H) x  
1025(W) x 430mm(D)

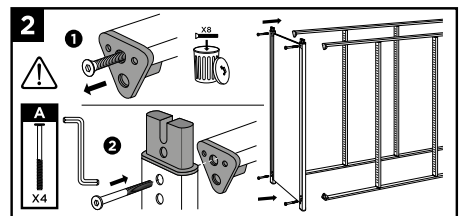
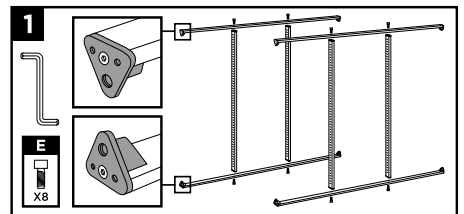
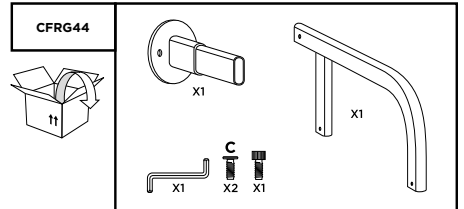
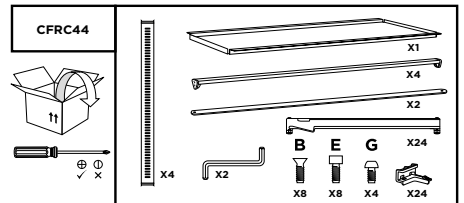
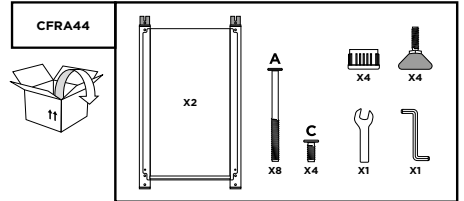



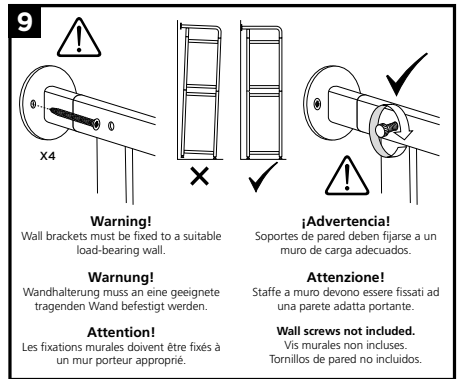
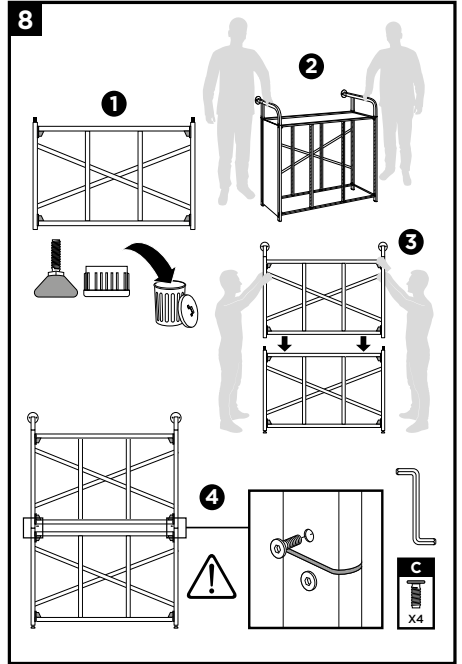
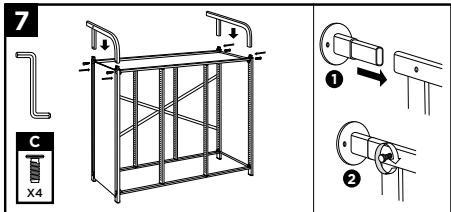
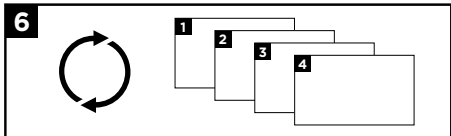
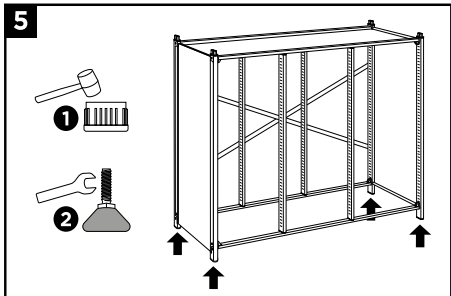
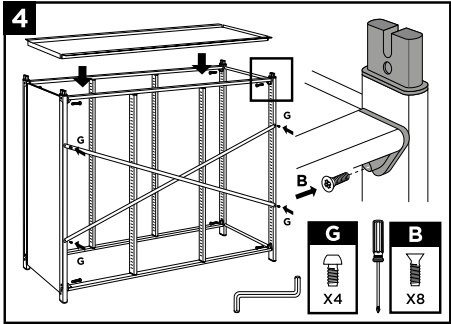
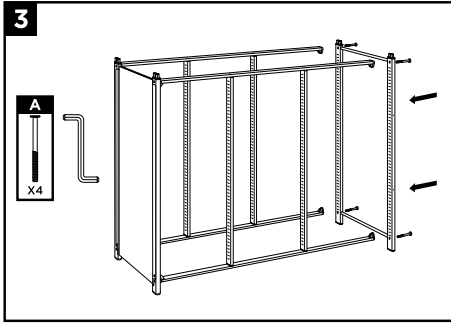

# Maker-store unit and Maker-tall unit

Dimensions: 1806(H) x  
1025(W) x 430mm(D)



CFRA44 x 2  
CFRC44 x 1  
CFRG44 x 2  
CFRN44 x 1

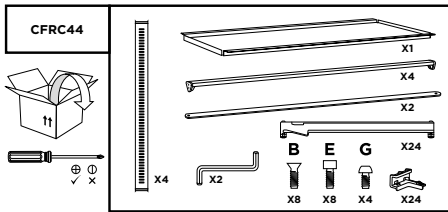
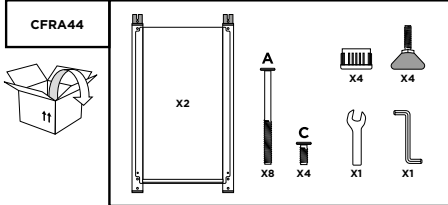

CFRA44 x 2  
CFRC44 x 1  
CFRG44 x 2  
CFRN44 x 1

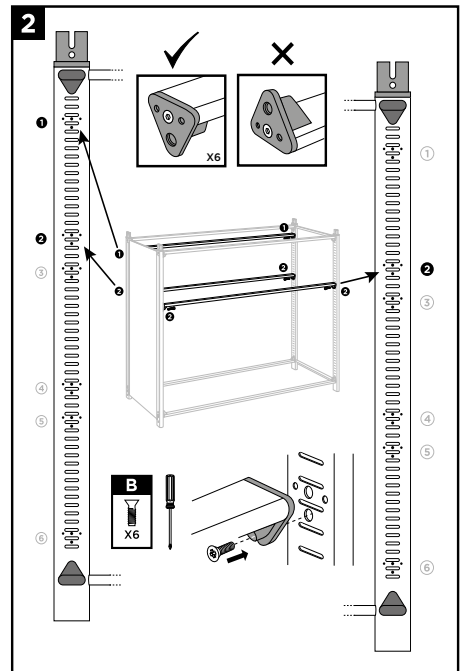
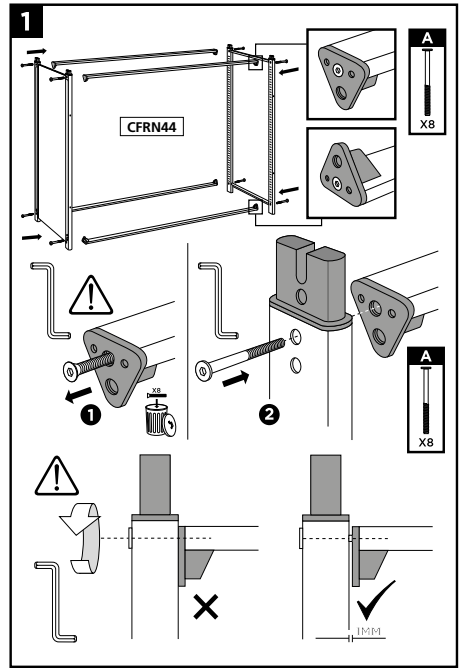
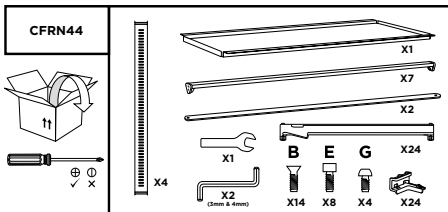
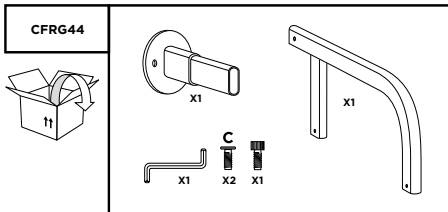

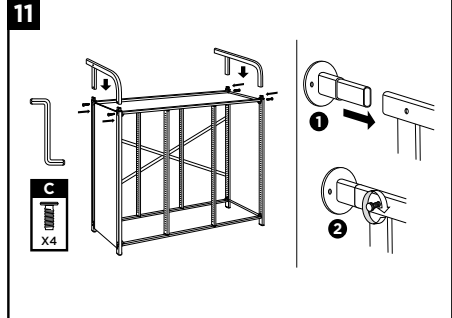
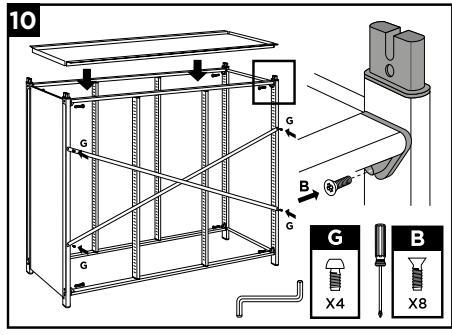
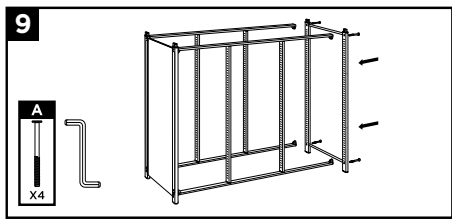
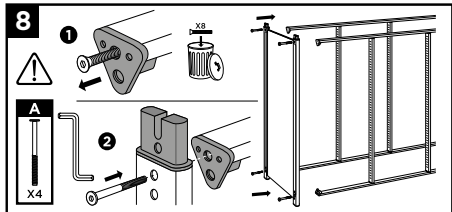
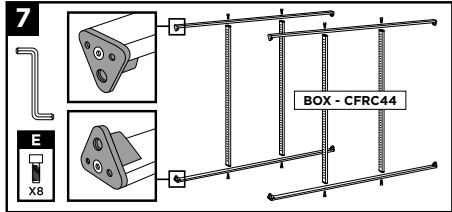
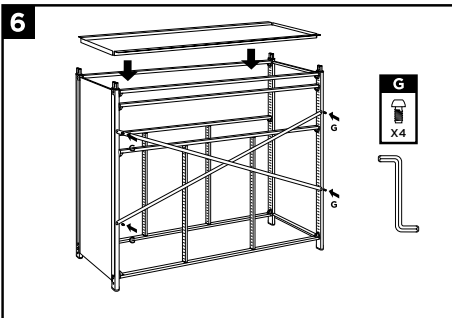
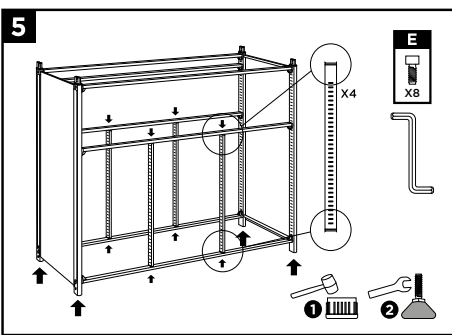
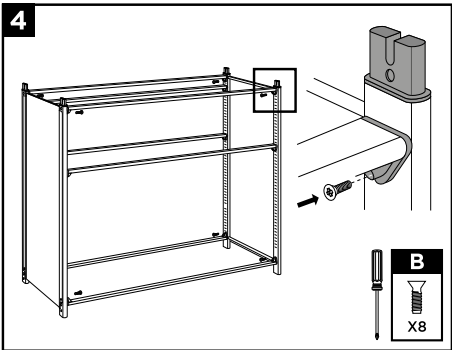
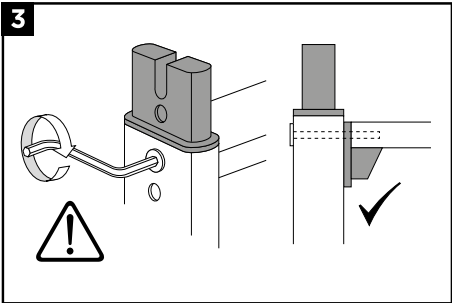

12

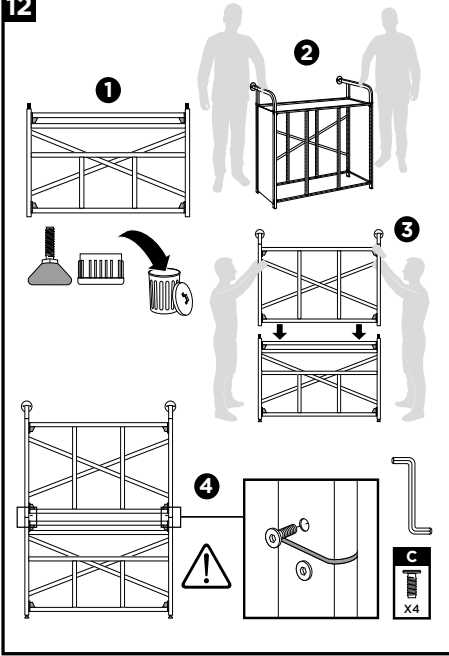

13

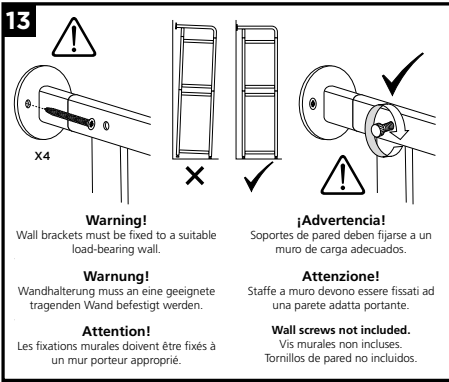

## Pick-store unit

Dimensions: 1806(H) x 1025(W) x 430mm(D)



CFRA44 x 2  
CFRC44 x 1  
CFRD44 x 1  
CFRG44 x 2

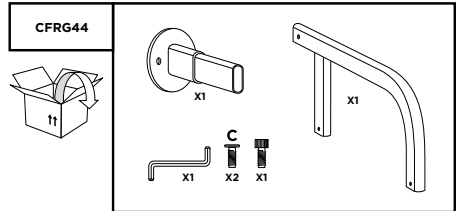
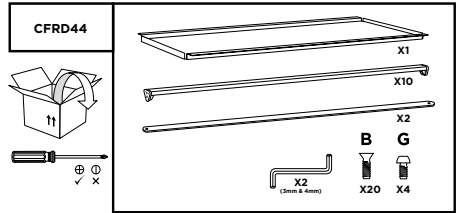
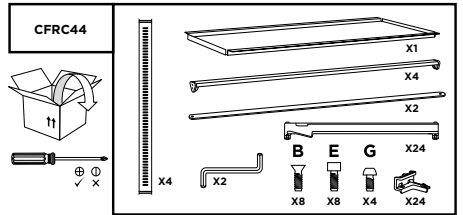
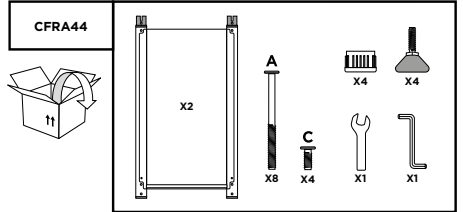

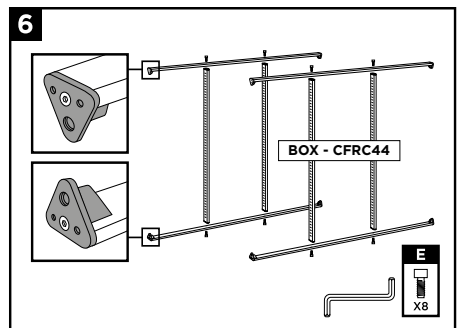
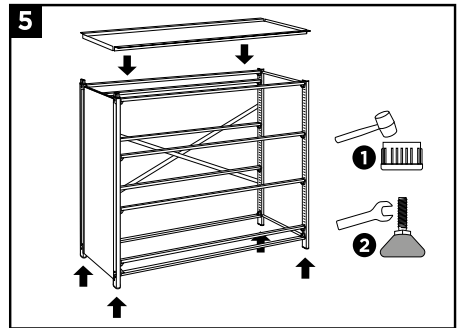
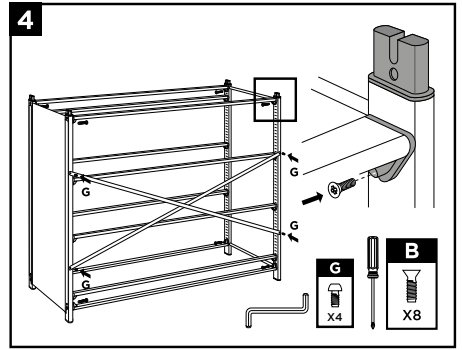
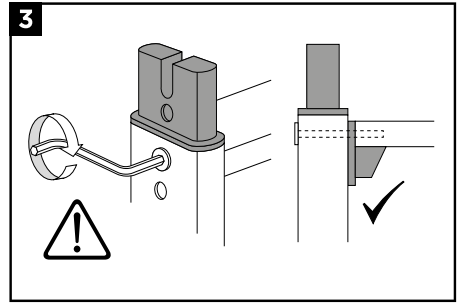
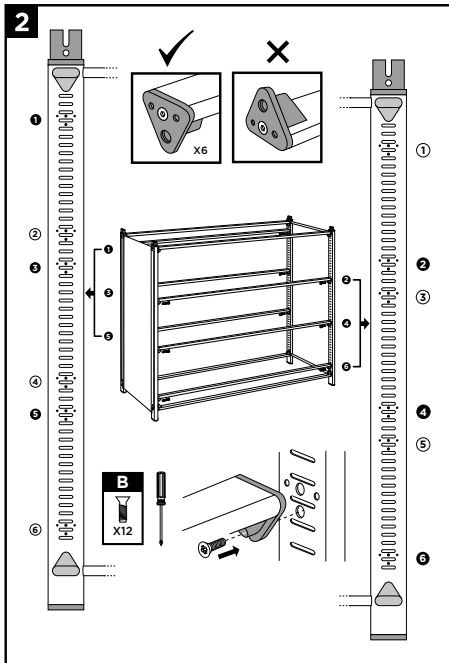
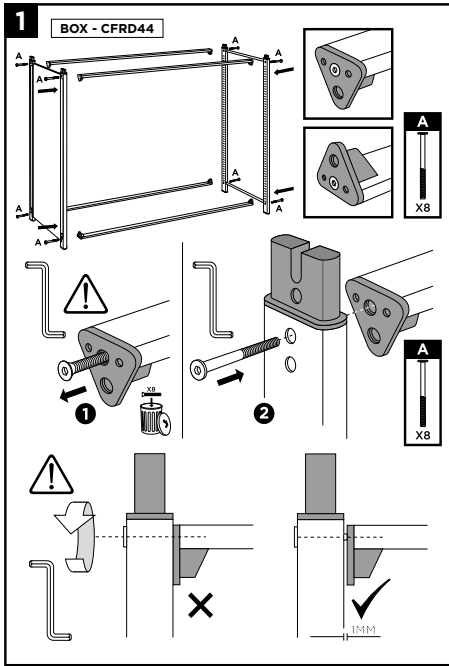

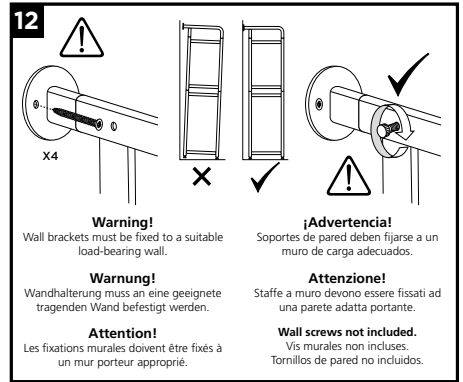
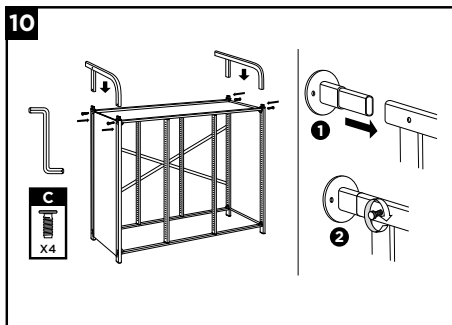
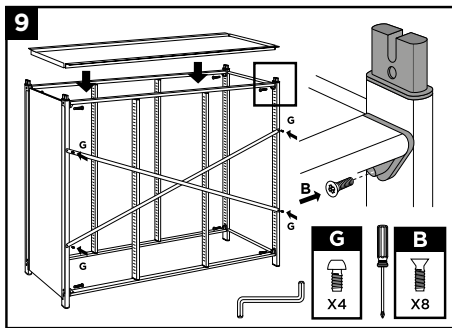
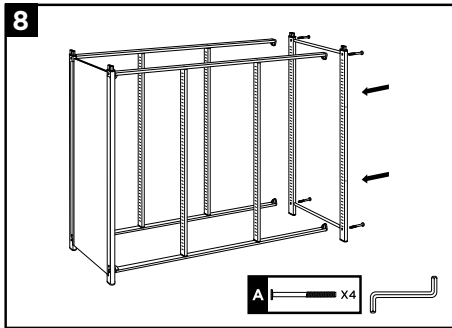
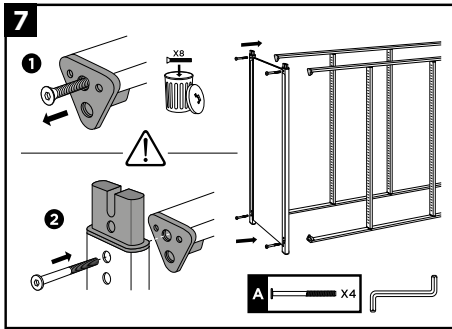

## Slim-store unit

Dimensions: 1806(H) x  
695(W) x 430mm(D)

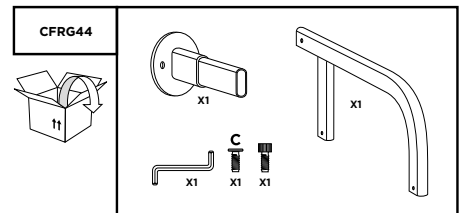
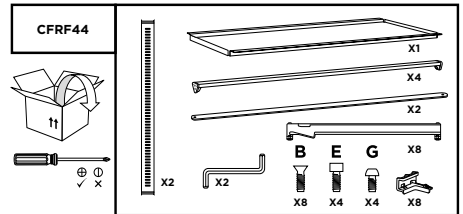
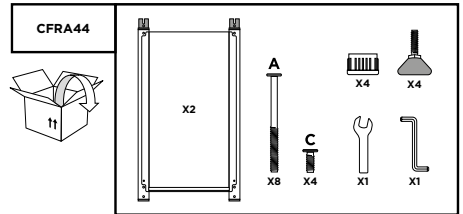

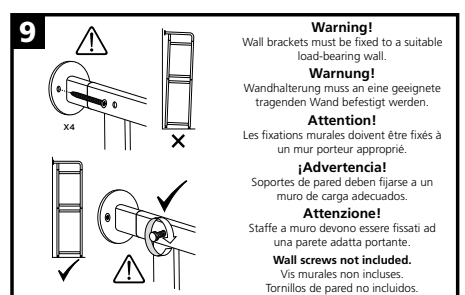
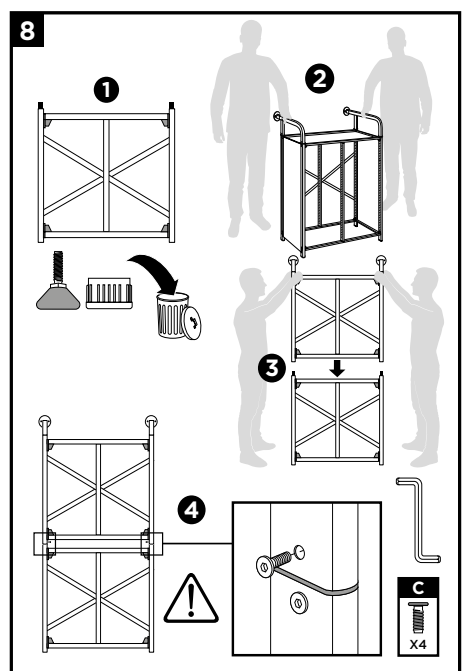
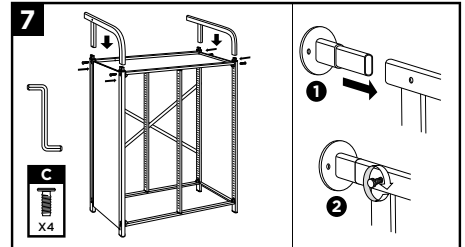
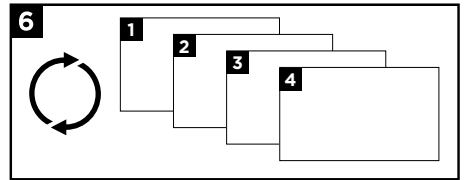
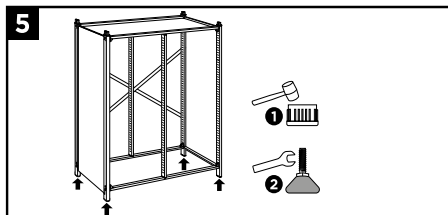
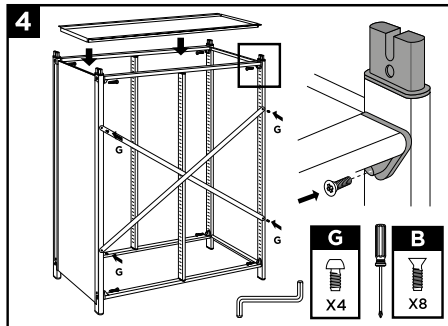
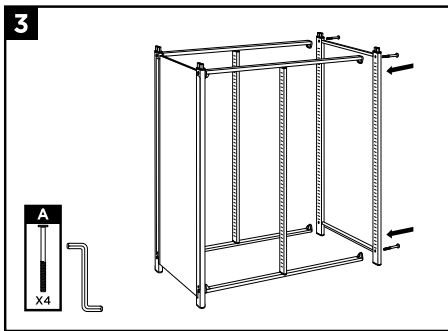
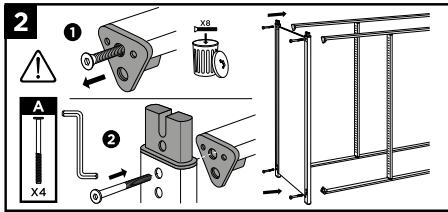
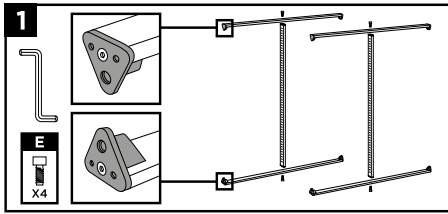

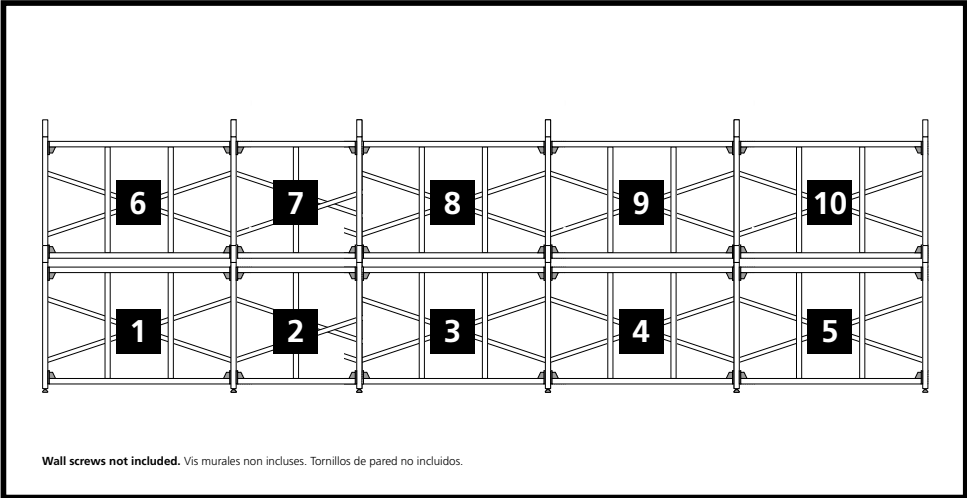
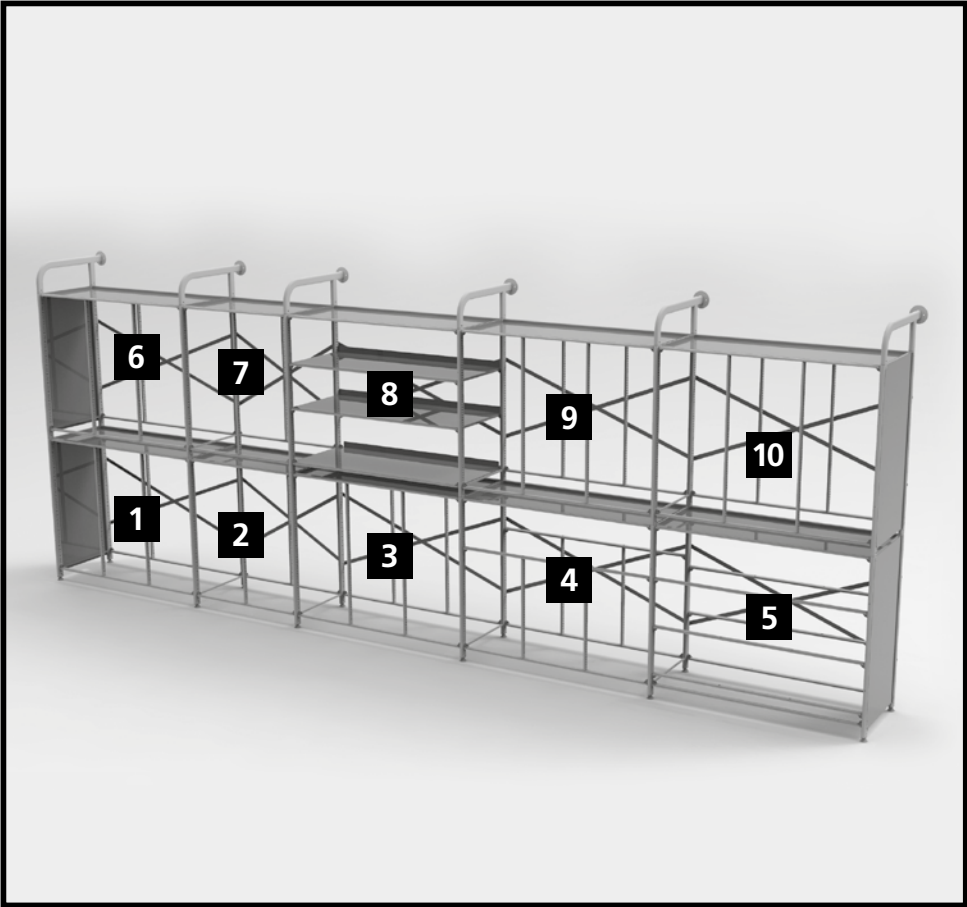

Wall screws not included. Vis murales non incluses. Tornillos de pared no incluidos.





# 1. Treble column unit

CFRA44 + CFRC44  
+ CFRB44

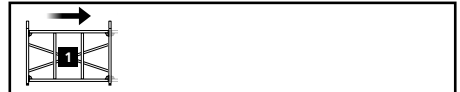
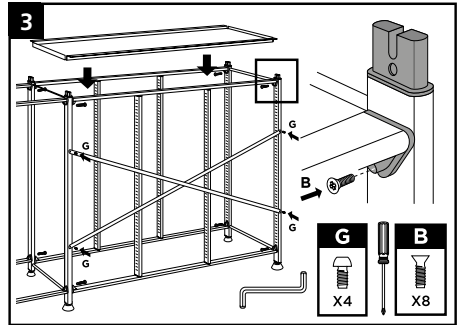
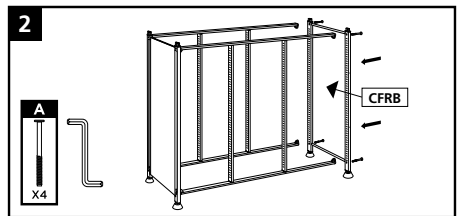
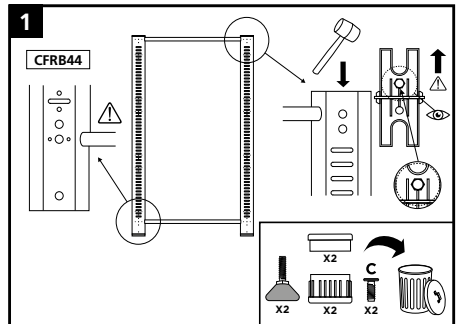
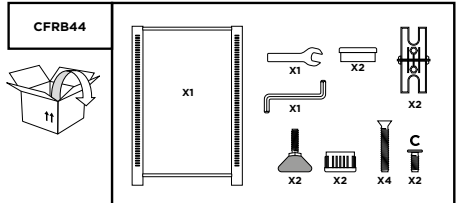
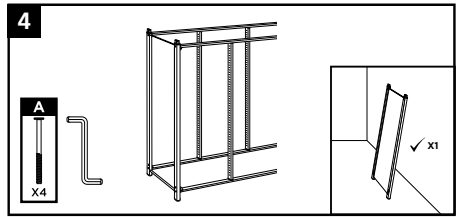
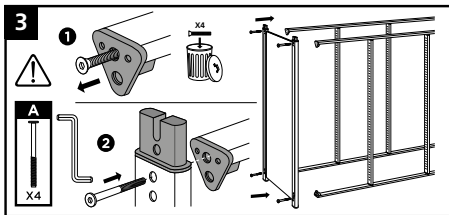
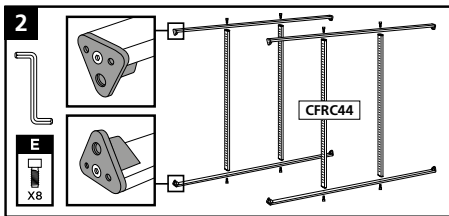
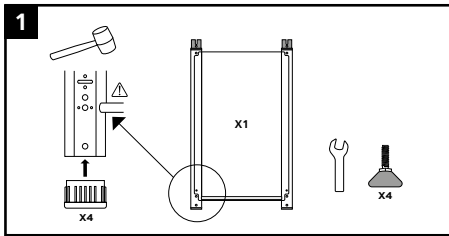
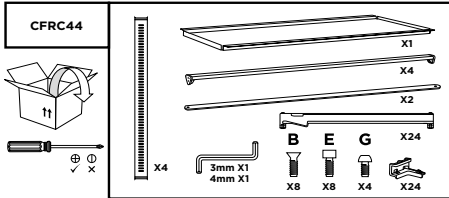
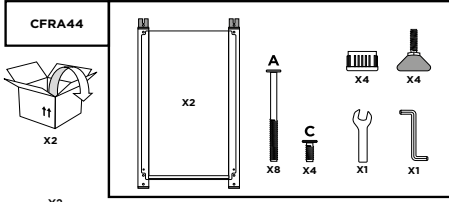

## 2. Double column

CFRF44 + CFRB44

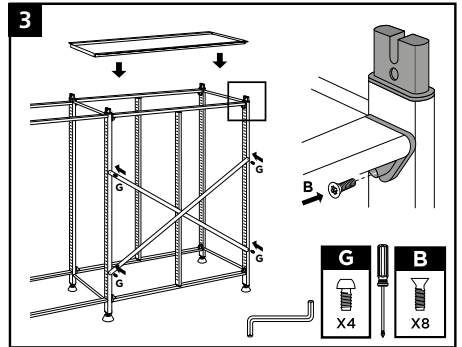
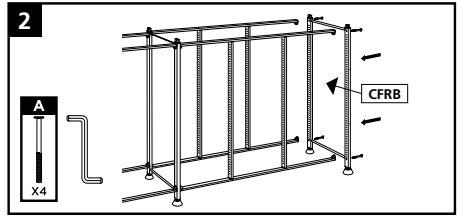
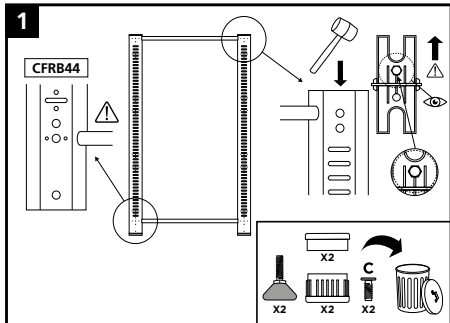
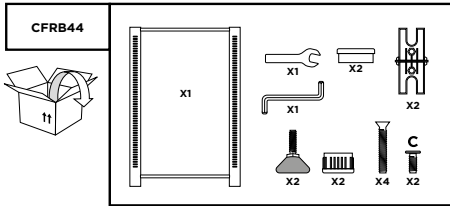
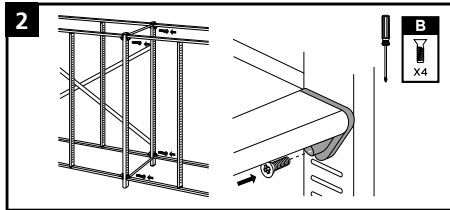
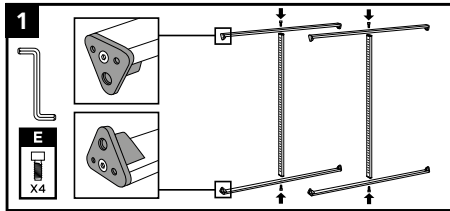
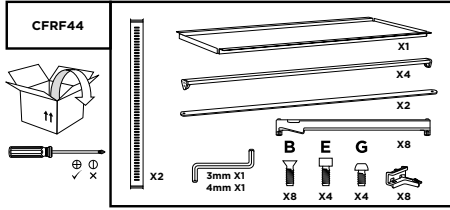

## 3. Treble column unit

CFRC44 + CFRB44

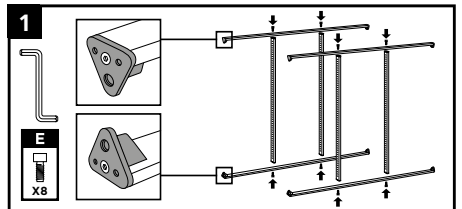
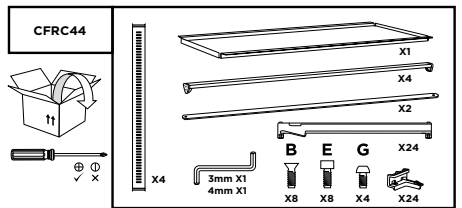

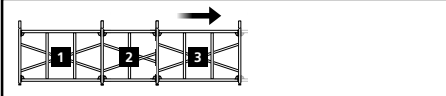
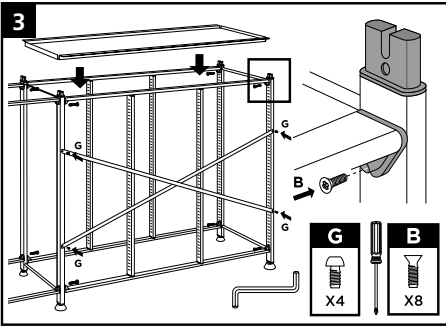
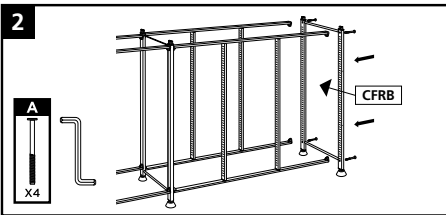
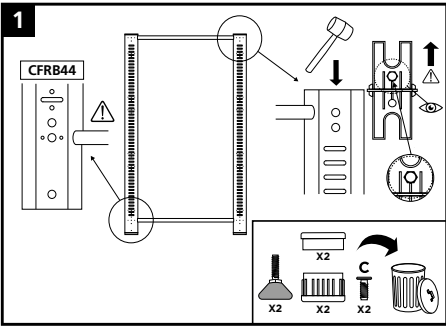
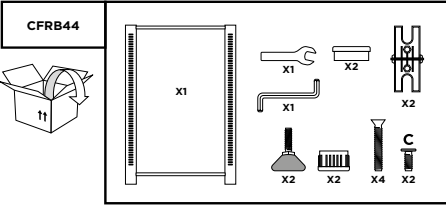
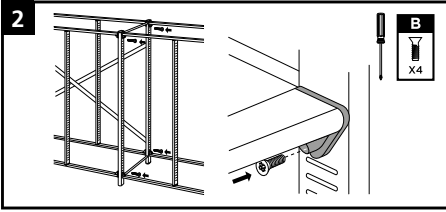

## 4. Maker unit

CFRN44 + CFRB44

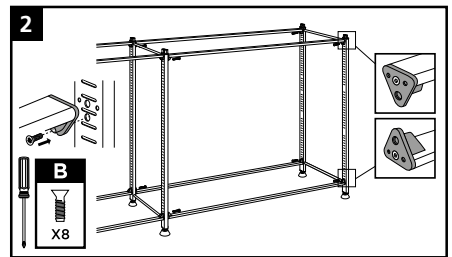
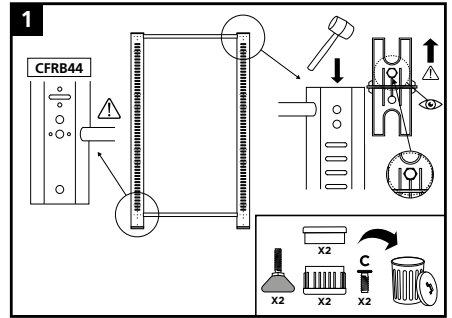
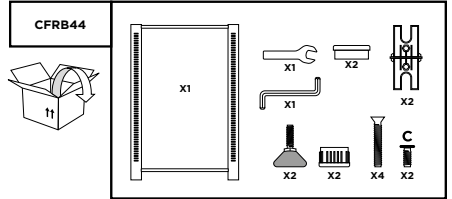
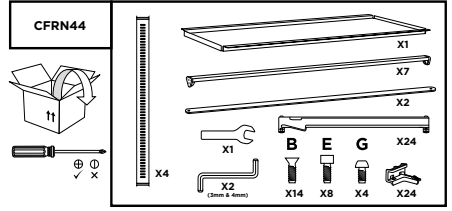
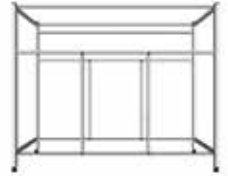

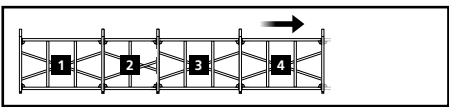
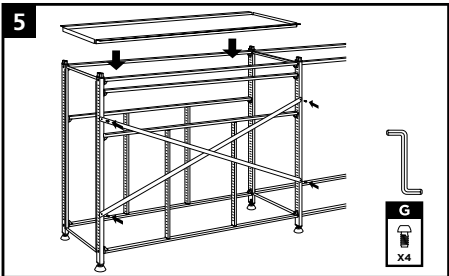
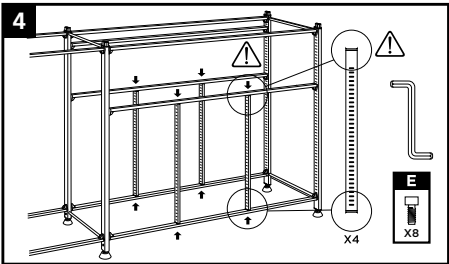
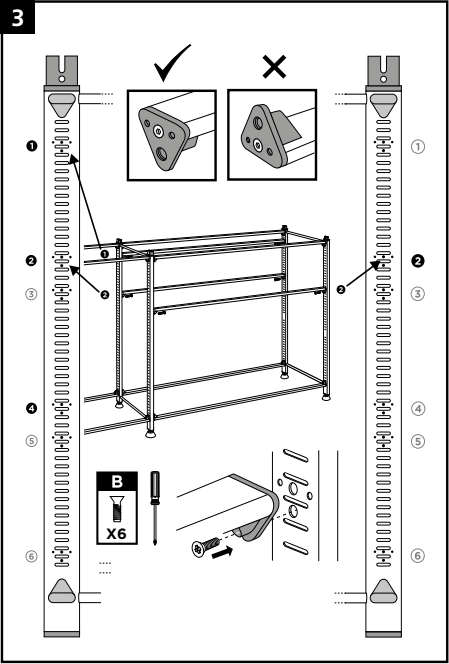

## 5. Tilted tray unit

CFRD44 + CFRB44

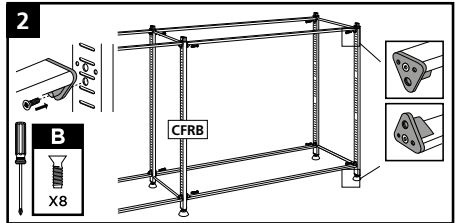
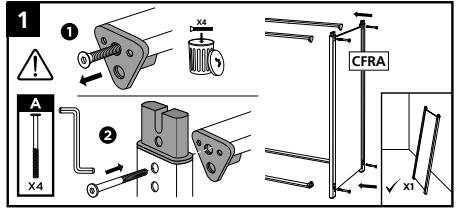
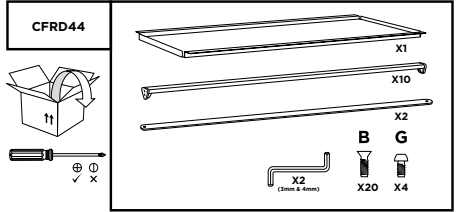

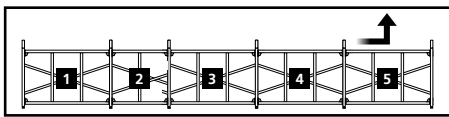
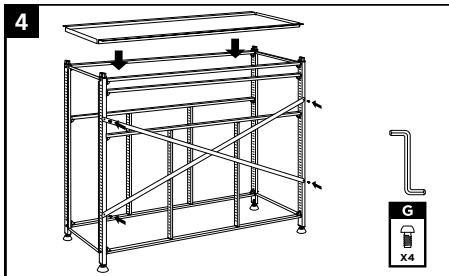
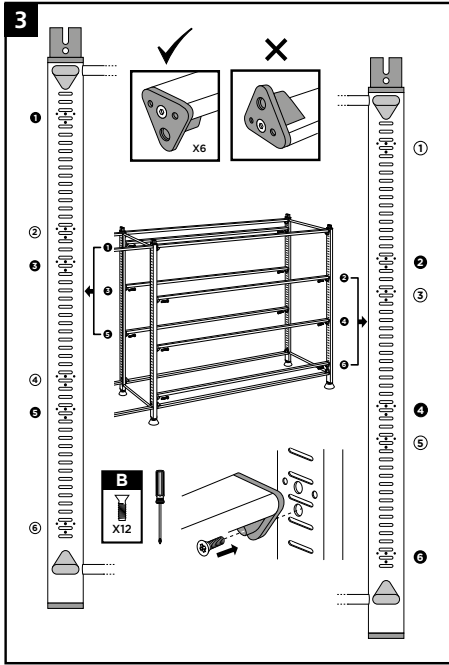

**6. Treble column unit**  
 CFRA44 + CFRC44  
 + CFRB44

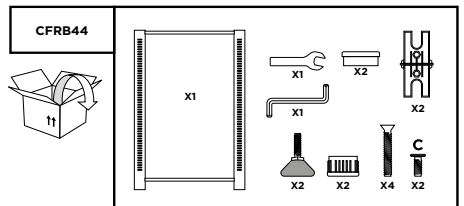
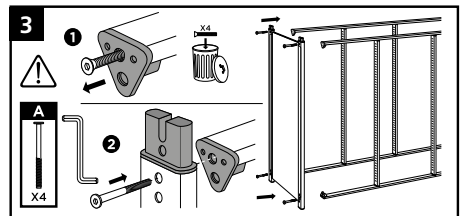
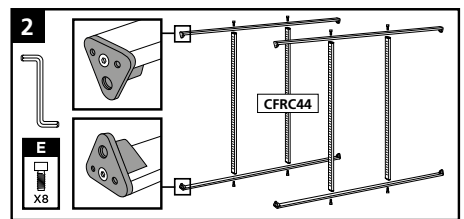
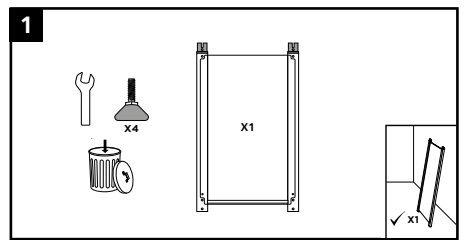
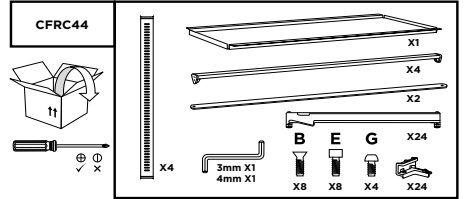
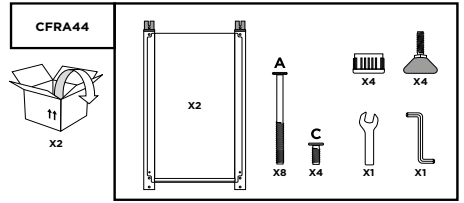

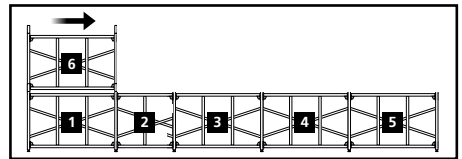
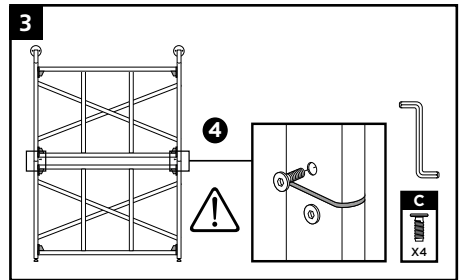
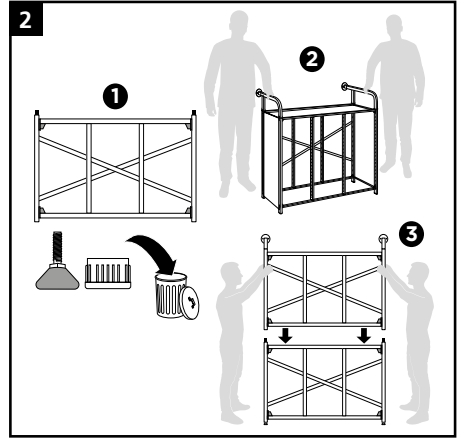
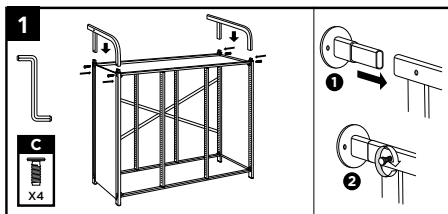
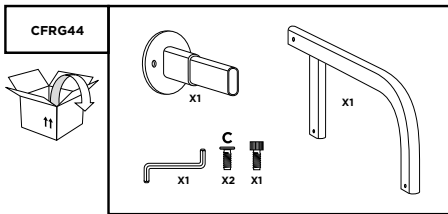
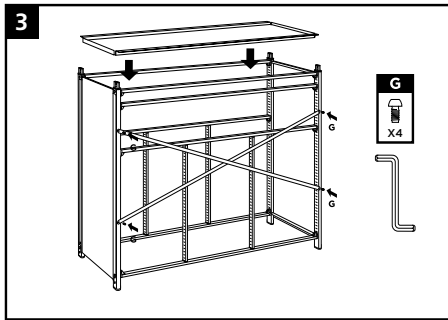
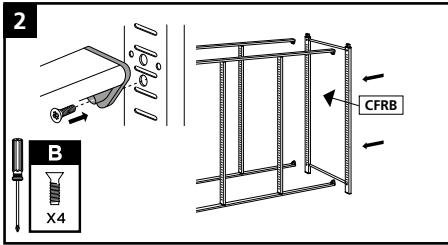
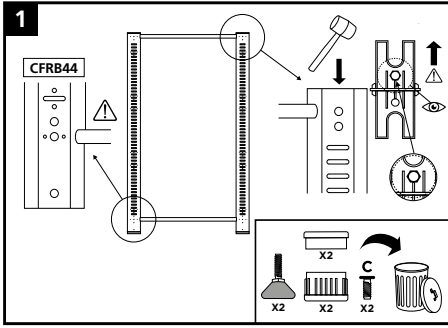

## 7. Double column unit

CFRF44 = CFRB44

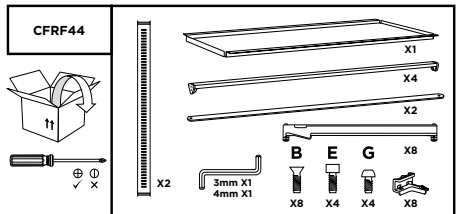

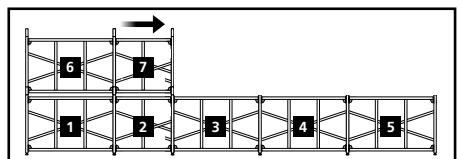
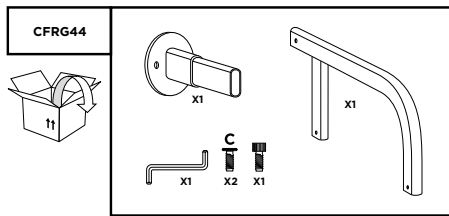
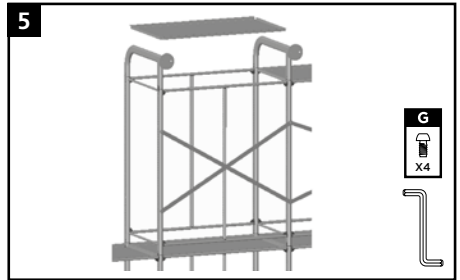
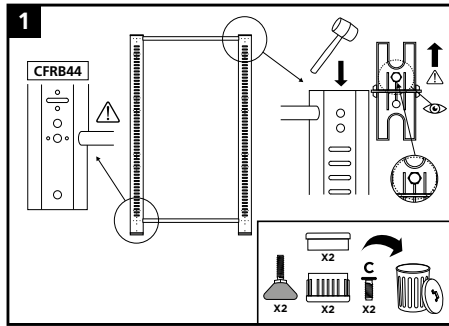
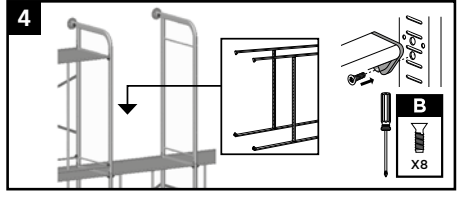
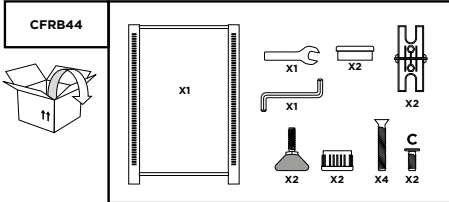
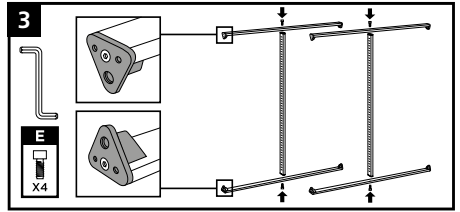
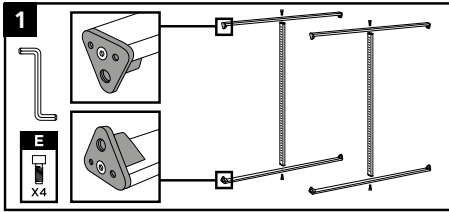

**8. Flat shelf unit**  
CFRM44 + CFRB44

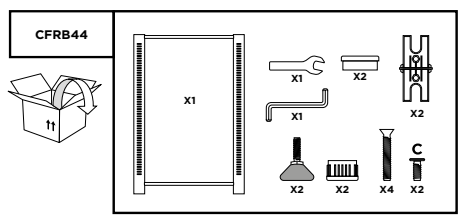
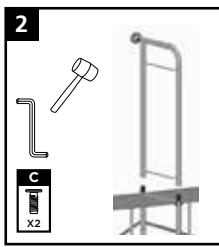
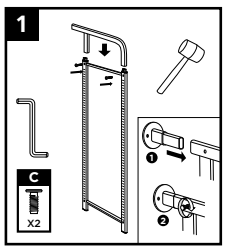

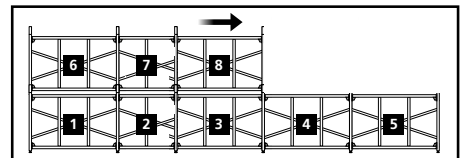
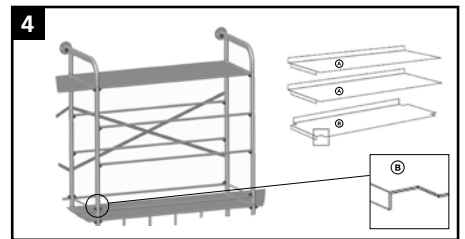
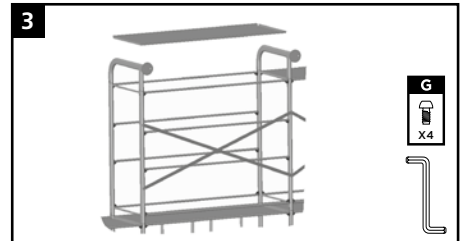
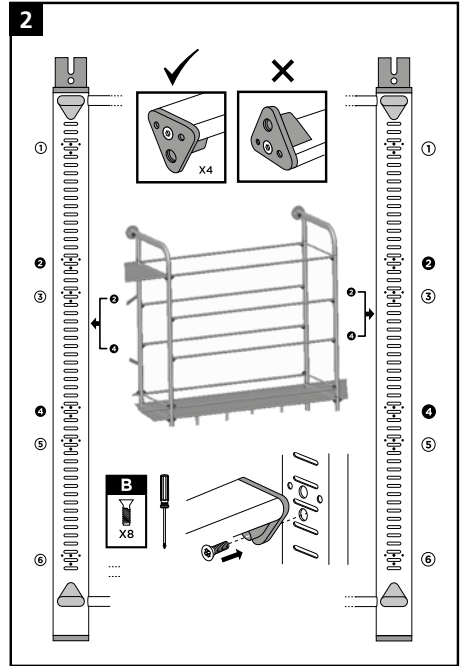
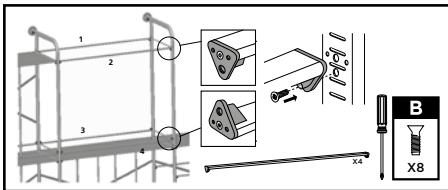
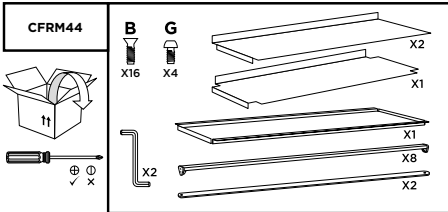
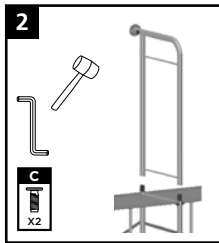
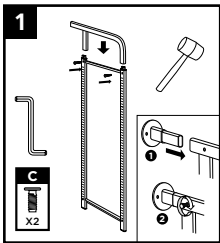
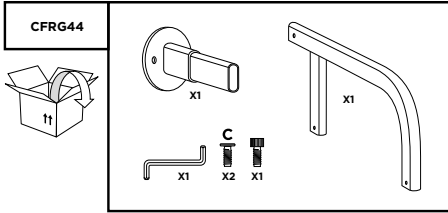
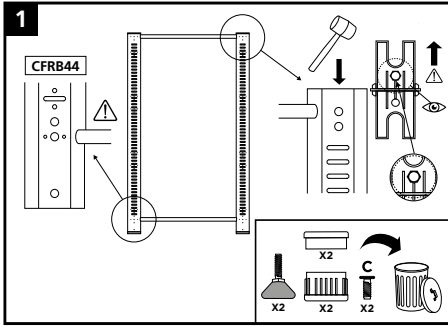



## 9. Treble column unit

CFRC44 + CFRB44

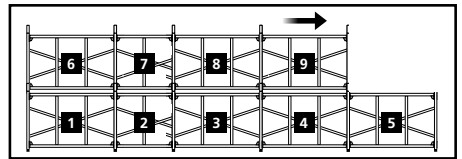
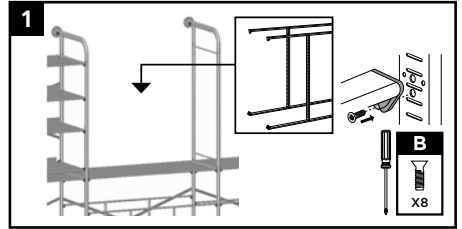
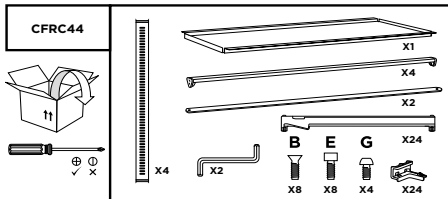
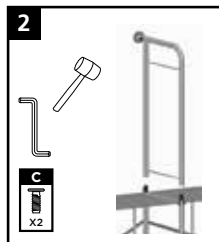
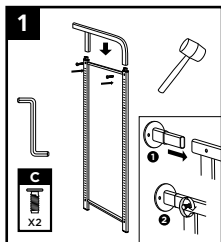
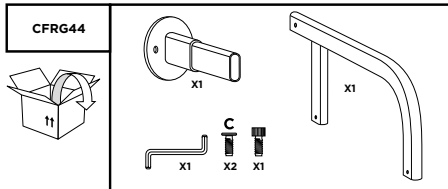
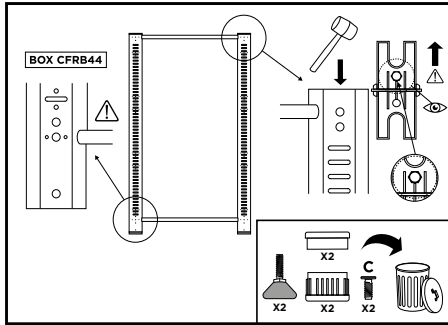
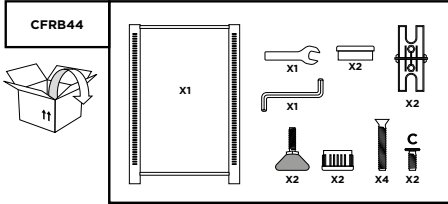

## 10. Treble column unit

CFRA44 + CFRC44  
+ CFRB44

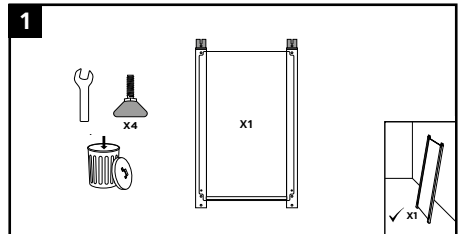
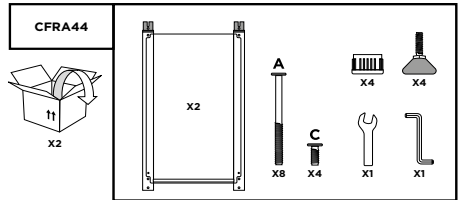

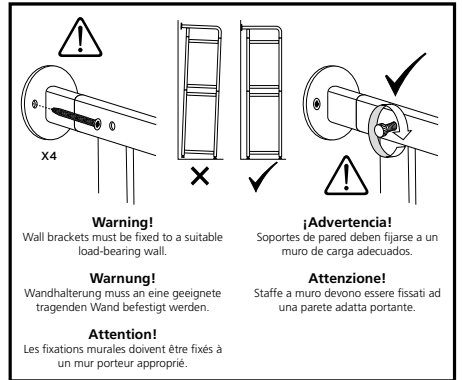
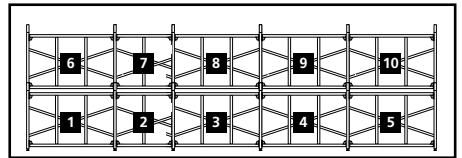
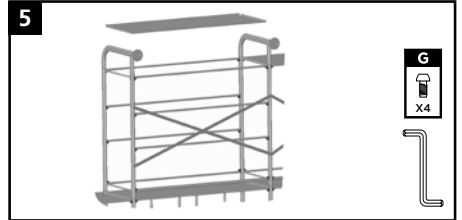
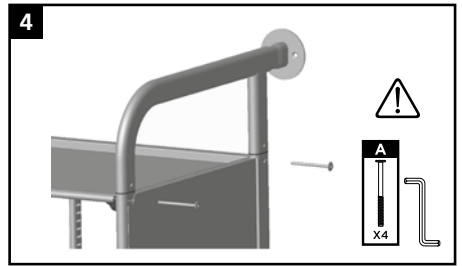
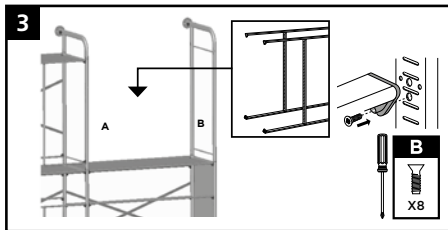
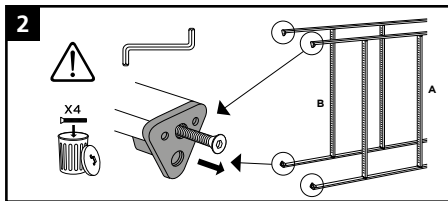
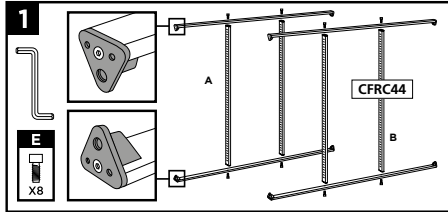
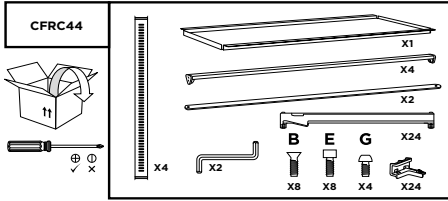
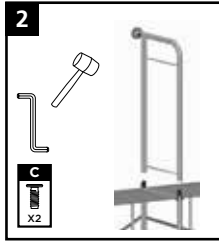
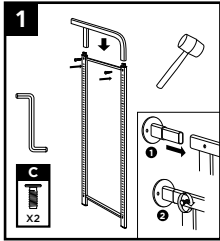
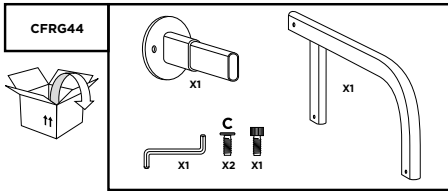

# Runners and Tray spacing guide

