

# Mobile Mixer Stands Specification Sheet

## SMS-08-V69-MMT303

### Short Form Specifications

Top to be 14 gauge 300 series stainless steel with no-drip counter top edge. Constructed with uni-lok® patented gusset system, with the gussets recessed into the hat channels to reduce lateral movement. Stainless steel pan rack slides hold six 18" x 26" bun pans. Galvanized or stainless steel tubular base: 1½" O.D. tubular legs with 1¼" O.D. tubular cross rails, and 4" swivel casters—two with brake.

Eagle Mobile Equipment Stand, model MET2430S. Top to be 14 gauge 300 series stainless steel with no-drip counter top edge. Constructed with uni-lok® patented gusset system, with the gussets recessed into the hat channels to reduce lateral movement. Heavy gauge stainless steel adjustable undershelf, 1" diameter stainless steel handle welded to brackets and stand. 1½" O.D. stainless steel tubular legs and two 4" casters with brake.

### Mobile Mixer Stands

- Uni-lok® gusset system (patent #5,165,349): gusset is recessed into hat channel underside tabletop, reducing lateral movement.
- Highly-polished 14 gauge 300 series stainless steel top with no-drip countertop edge.
- Stainless steel crossbracing on three sides.
- 1½" (41mm)-diameter legs with four 4" (102mm) casters, two with brake.
- Pan rack slides hold six 18" x 26" (457 x 660mm) pans.
- 400 lb. (181.4 kg) total weight capacity - evenly distributed static load.



mobile mixer stand

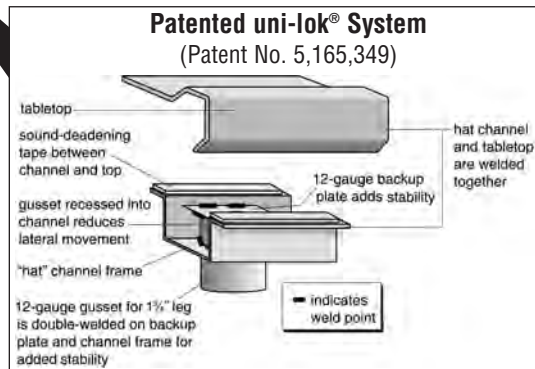

## Mobile Mixer Stands

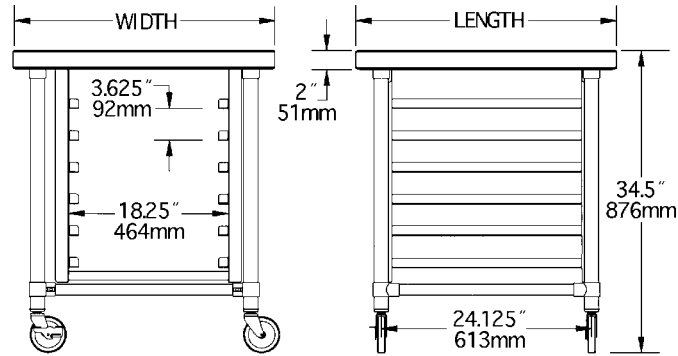

galvanized model #	stainless steel model #	weight		width		length	
		lbs.	kg	in.	mm	in.	mm
<i>MMT3030G</i>	<i>MMT3030S</i>	55	24.9	30"	762	30"	762
<i>MMT3036G</i>	<i>MMT3036S</i>	60	27.2	30"	762	36"	914

