

Laminate lockers || SMS-05-V90-MCLA

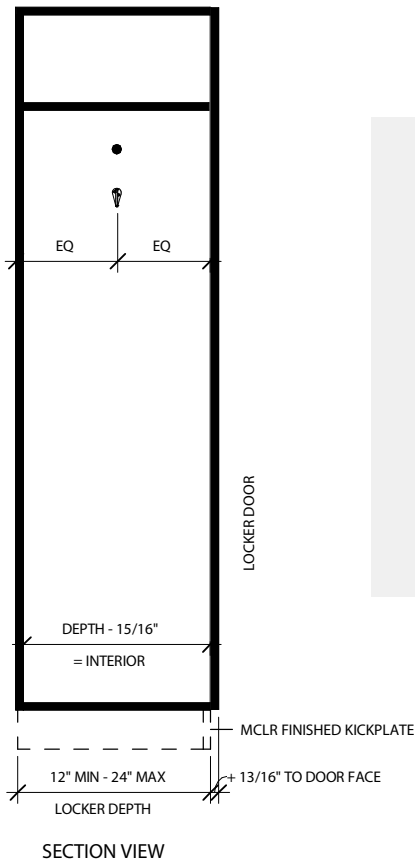
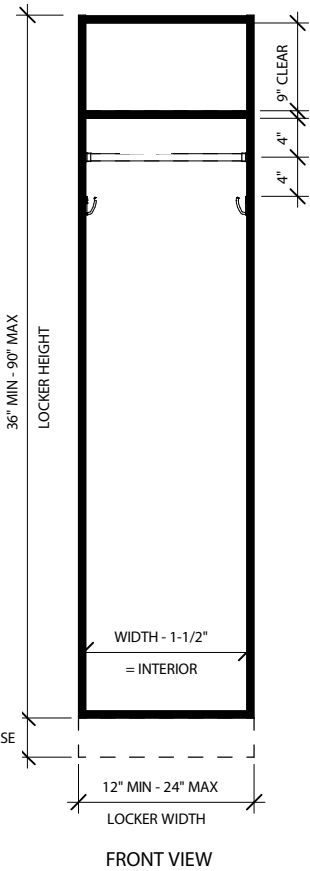
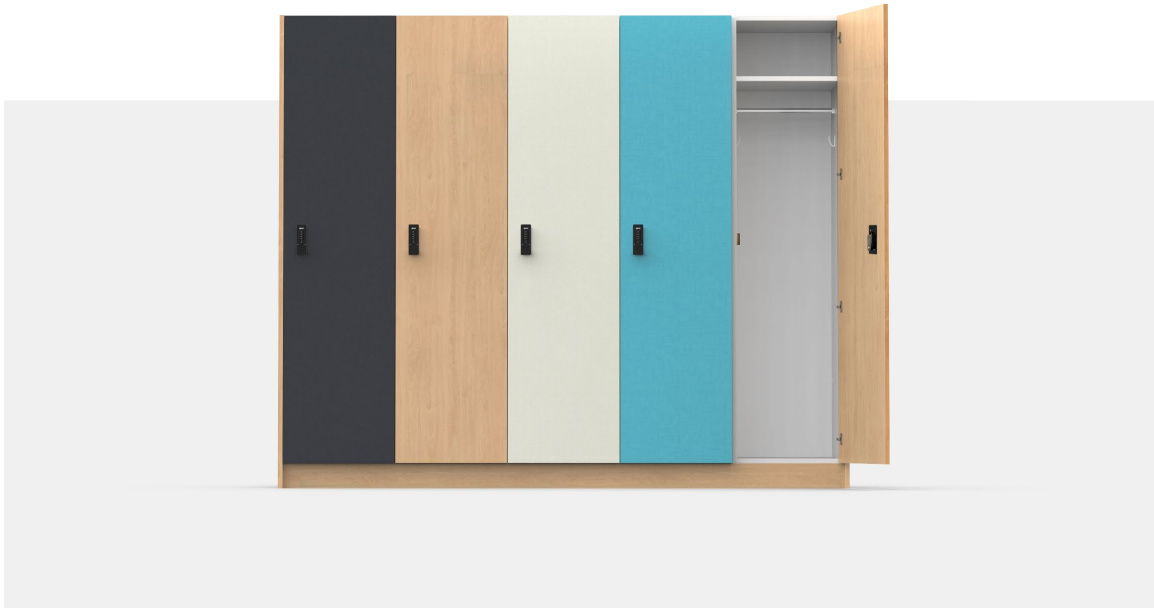

STANDARD SIZES

Custom sizes available

Width	Depth	Height
12"	15"	36"
15"	18"	40"
18"	20"	54"
		68"
		72"
		90"



Laminate lockers II SMS-05-V90-MCLB

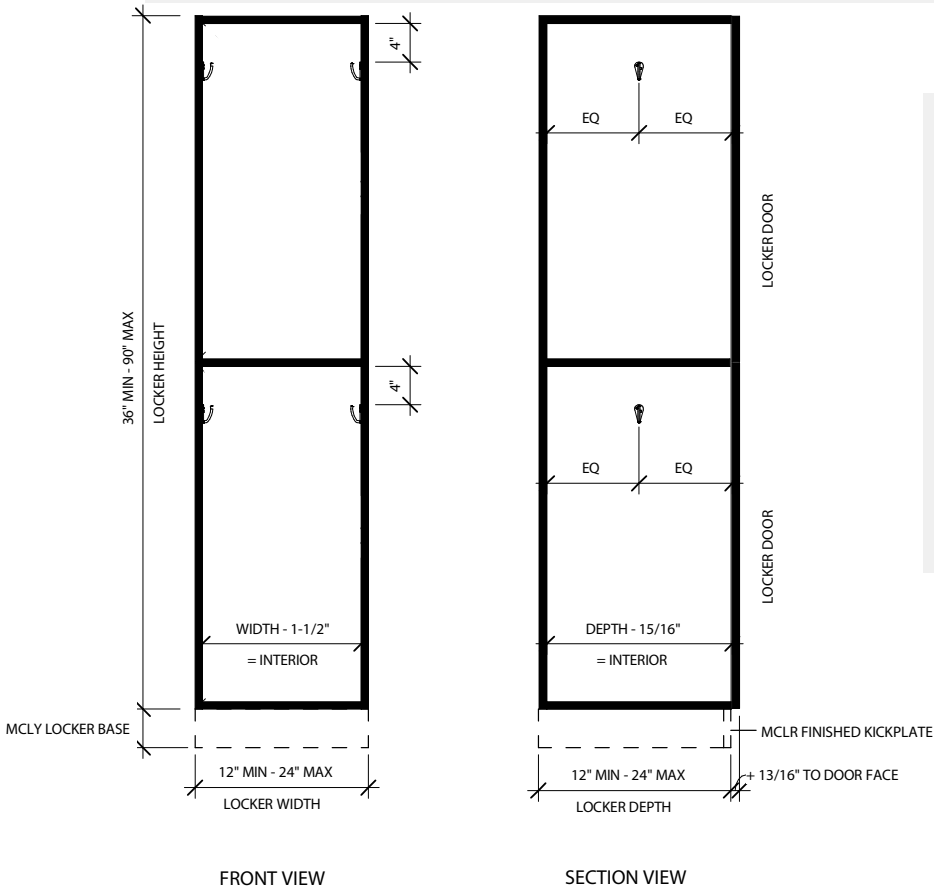
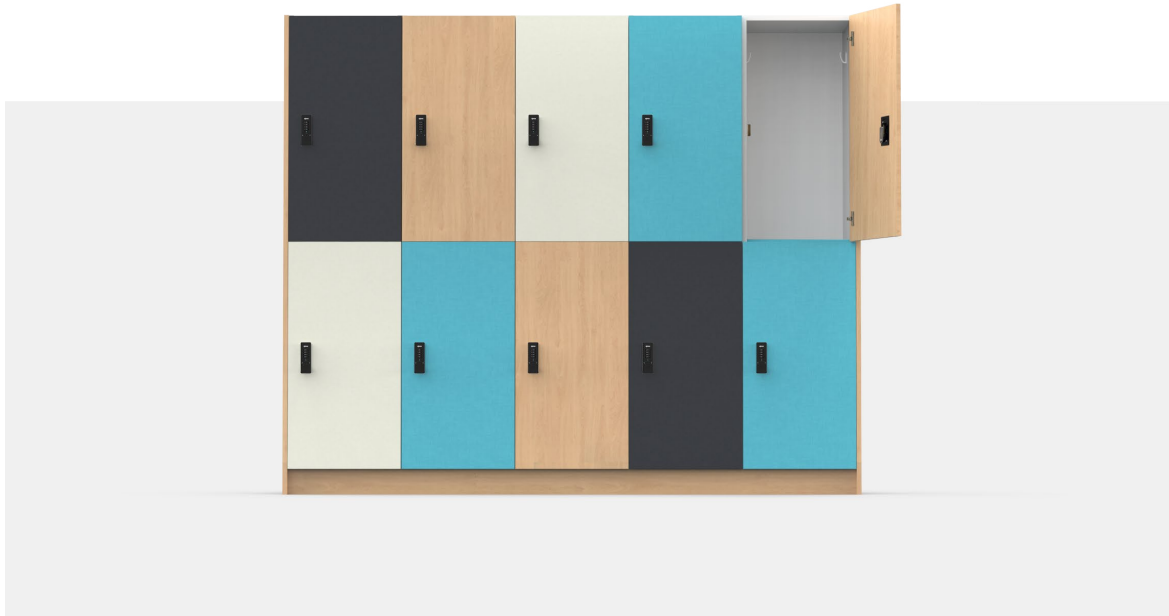

STANDARD SIZES

Custom sizes available

Width	Depth	Height
12"	15"	36"
15"	18"	40"
18"	20"	54"
		68"
		72"
		90"



Standard Locker Construction

Body and Doors: 3/4" Thermally Fused Laminate (TFL) with industrial grade particleboard core

Edge Banding: 1mm PVC

Shelves: 3/4" TFL with industrial grade particleboard core

Lockers fabricated using wood doweled and glued construction

Hamilton Standard Limited Lifetime Warranty

MCLB Standard Features

Base: Sold separately

Body Interior: White interior

Body Exterior: Unfinished – finished end panels sold separately

Body Edge Banding: PVC in HAMILTON standard colors, front edges only

Doors: TFL in HAMILTON standard colors, interior/exterior color matching

Door Edge Banding: PVC in HAMILTON standard colors, all sides

Hinges: Concealed 110-degree full overlay, quantity based on door height

Door Swing: Right or left hinged

Coat Hooks: Optional, includes 2 single prong chrome coat hooks in selected locations, located 4" down from top, centered on panel width, choose from left or right side panel, back panel, or back of door

Locks: HAMILTON standard line includes Mechanical-Combo, Smart, Networked, RFID & 4-Digit PIN Battery-Operated, and more. Example brands: Metra, Ojmar, Digilock, Zephyr. Locks are centered on door height.

Available Options

Base: Integrated 4" kick base, no base with levelers

Body: Double-sided TFL with matching interior and exterior color in HAMILTON standard colors, or select special color

Doors: High Pressure Laminate (HPL) in HAMILTON standard colors, or select special colors

Hinges: 110-degree soft close, 270 degree, 5 knuckle institutional

Handles: When required with lock, from HAMILTON standard line

Coat Hooks: Additional single prong coat hooks, double prong chrome coat hook also available

Hanging Rod: 3/4" diameter chrome rod with end supports, located 4" down from top, note: minimum 20" deep locker required for hanging

Door rout for number tag: 1-1/2" diameter to accept HAMILTON MCLT locker tags, located 3" from top of door to center of tag, centered on door width

Sustainability: GREENGUARD Gold, NAF/ULEF, FSC options available

Corresponding Models

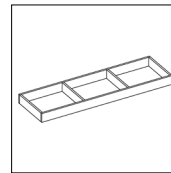

MCLY (base)

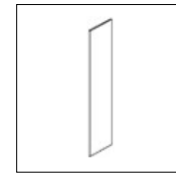

MCLX (end panels)

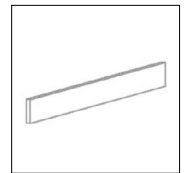

MCLR (kickplate)

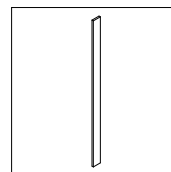

MCLW (filler)



MCLT (number tags)

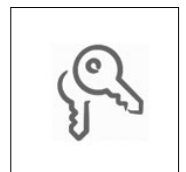

MKEY (locker keys)



Single Prong Coat Hook Chrome



19mm Hanging Rod Chrome



Hanging Rod Support Chrome



Double Prong Coat Hook (Optional) Chrome



Laminate lockers II SMS-05-V90-MCLC

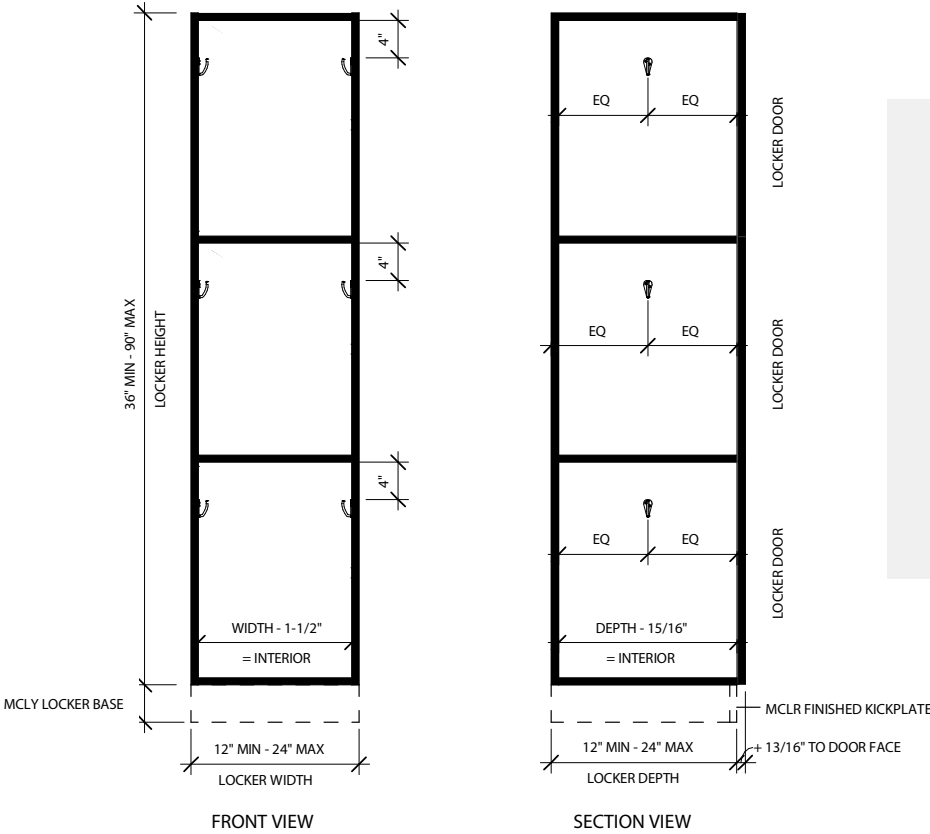
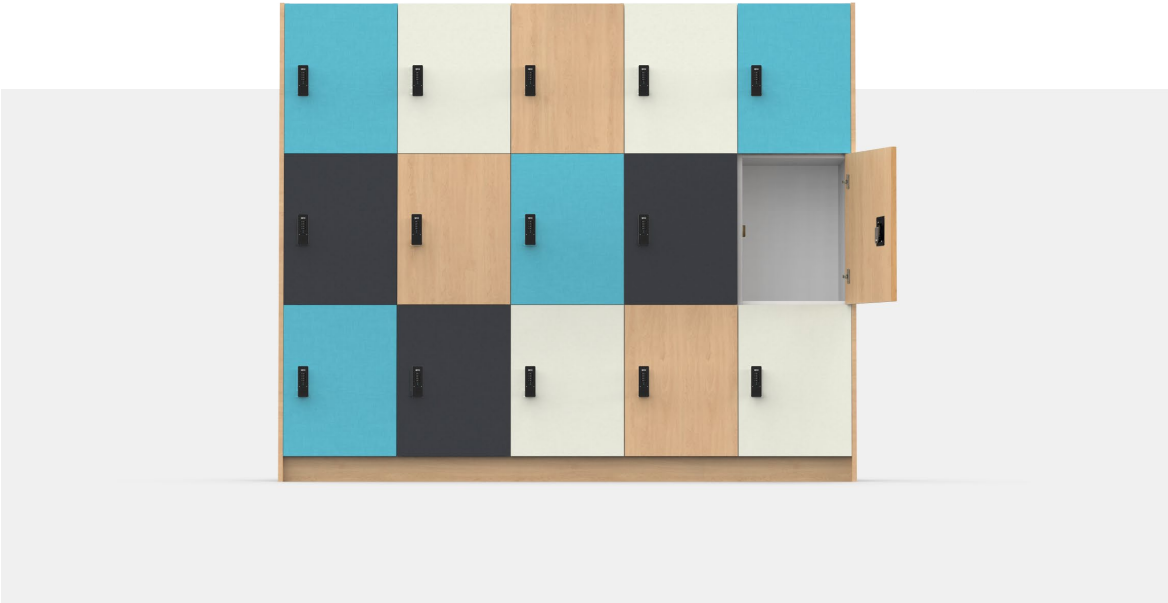

STANDARD SIZES
Custom sizes available

Width	Depth	Height
12"	15"	36"
15"	18"	40"
18"	20"	54"
		68"
		72"
		90"



Standard Locker Construction

Body and Doors: 3/4" Thermally Fused Laminate (TFL) with industrial grade particleboard core

Edge Banding: 1mm PVC

Shelves: 3/4" TFL with industrial grade particleboard core

Lockers fabricated using wood doweled and glued construction

Hamilton Standard Limited Lifetime Warranty

MCLC Standard Features

Base: Sold separately

Body Interior: White interior

Body Exterior: Unfinished – finished end panels sold separately

Body Edge Banding: PVC in HAMILTON standard colors, front edges only

Doors: TFL in HAMILTON standard colors, interior/exterior color matching

Door Edge Banding: PVC in HAMILTON standard colors, all sides

Hinges: Concealed 110-degree full overlay, quantity based on door height

Door Swing: Right or left hinged

Locks: HAMILTON standard line includes Mechanical-Combo, Smart, Networked, RFID & 4-Digit PIN Battery-Operated, and more. Example brands: Metra, Ojmar, Digilock, Zephyr. Locks are centered on door height.



Single Prong
Coat Hook
Chrome



Double Prong Coat
Hook (Optional)
Chrome

Available Options

Base: Integrated 4" kick base, no base with levelers

Body: Double-sided TFL with matching interior and exterior color in HAMILTON standard colors, or select special color

Doors: High Pressure Laminate (HPL) in HAMILTON standard colors, or select special colors

Hinges: 110-degree soft close, 270 degree, 5 knuckle institutional

Handles: When required with lock, from HAMILTON standard line

Coat Hooks: Single or double prong chrome coat hooks available, located 4" down from top, centered on panel width, choose from left or right side panel, back panel, or back of door

Door rout for number tag: 1-1/2" diameter to accept HAMILTON MCLT locker tags, located 3" from top of door to center of tag, centered on door width

Sustainability: GREENGUARD Gold, NAF/ULEF, FSC options available

Corresponding Models

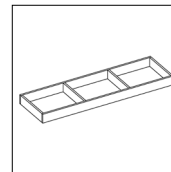

MCLY (base)

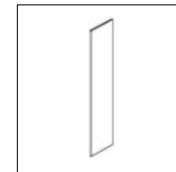

MCLX (end panels)

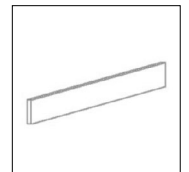

MCLR (kickplate)

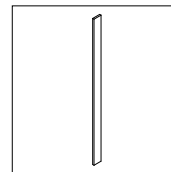

MCLW (filler)



MCLT (number tags)



MKEY (locker keys)



Standard Locker Construction

Body and Doors: 3/4" Thermally Fused Laminate (TFL) with industrial grade particleboard core

Edge Banding: 1mm PVC

Shelves: 3/4" TFL with industrial grade particleboard core

Lockers fabricated using wood doweled and glued construction

Hamilton Standard Limited Lifetime Warranty

MCLA Standard Features

Base: Sold separately

Body Interior: White interior

Body Exterior: Unfinished – finished end panels sold separately

Body Edge Banding: PVC in HAMILTON standard colors, front edges only

Doors: TFL in HAMILTON standard colors, interior/exterior color matching

Door Edge Banding: PVC in HAMILTON standard colors, all sides

Hinges: Concealed 110-degree full overlay, quantity based on door height

Door Swing: Right or left hinged

Hanging Rod: Optional, includes 3/4" diameter chrome rod with end supports, located 4" down from top, note: minimum 20" deep locker required for hanging

Coat Hooks: Optional, includes 2 single prong chrome coat hooks in selected locations, located 4" down from top, centered on panel width, choose from left or right side panel, back panel, or back of door

Fixed Shelf: Optional, includes 1 fixed TFL shelf in White with 1mm PVC, located 9" down from top

Locks: HAMILTON standard line includes Mechanical-Combo, Smart, Networked, RFID & 4-Digit PIN Battery-Operated, and more. Example brands: Metra, Ojmar, Digilock, Zephyr. Locks are centered on door height.



Single Prong Coat Hook Chrome



19mm Hanging Rod Chrome



Hanging Rod Support Chrome



Double Prong Coat Hook (Optional) Chrome

Available Options

Base: Integrated 4" kick base, no base with levelers

Body: Double-sided TFL with matching interior and exterior color in HAMILTON standard colors, or select special color

Doors: High Pressure Laminate (HPL) in HAMILTON standard colors, or select special colors

Hinges: 110-degree soft close, 270 degree, 5 knuckle institutional

Handles: When required with lock, from HAMILTON standard line

Coat Hooks: Additional single prong coat hooks, double prong chrome coat hook also available

Door rout for number tag: 1-1/2" diameter to accept HAMILTON MCLT locker tags, located 3" from top of door to center of tag, centered on door width

Sustainability: GREENGUARD Gold, NAF/ULEF, FSC options available

Corresponding Models

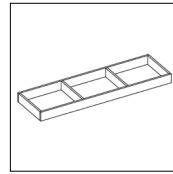

MCLY (base)

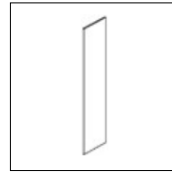

MCLX (end panels)

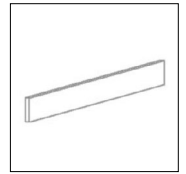

MCLR (kickplate)

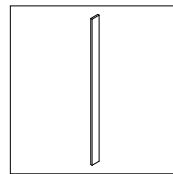

MCLW (filler)



MCLT (number tags)



MKEY (locker keys)

