

LAB SINK CABINET

3303 (OAK OR MAPLE)
ASSEMBLY INSTRUCTIONS

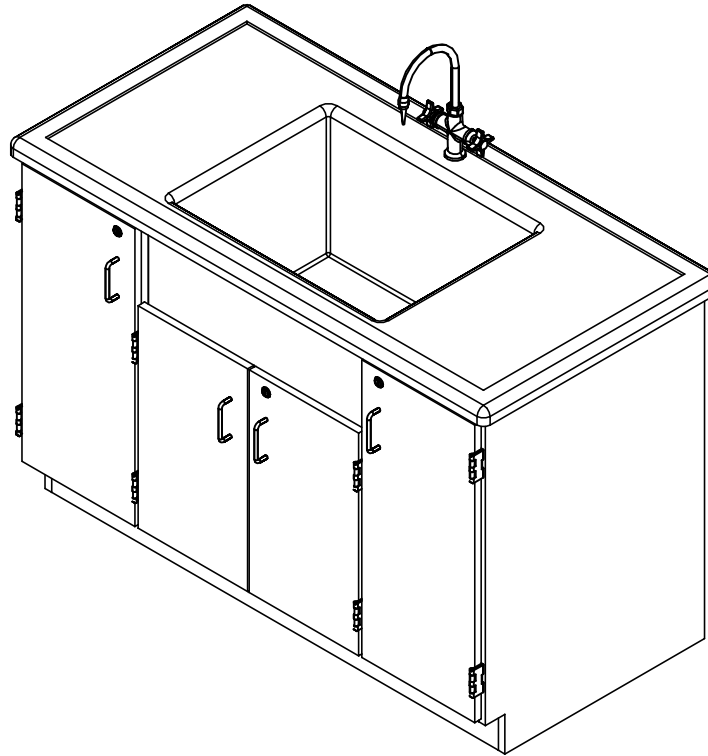

NOTE:

1. MODEL VIEWS MAY NOT REPRESENT EXACT MODEL PURCHASED

TOOLS REQUIRED

CONTACT CEMENT

SCREW DRIVER

ASSEMBLY COMPONENTS

ITEMS INCLUDED	PART #	PART DESCRIPTION	QTY
RUBBER BASE MOLDING	100283	RUBBER BASE MOLDING (SOLD BY FOOT)	8.5
STAINLESS STEEL CORNERS	100057	CORNERS-STAINLESS STEEL, BASE	2
SCREWS - BASE	100064	SCREW, #6X $\frac{1}{2}$ PTH SMS SS SCREW	8
SHELF CLIPS	100027	SHELF CLIPS, PLASTIC, 5MM PIN	8
FIXTURE	100467	FIXTUREW, L414 HOT & COLD MIXING	1
SINK TRAP	100056	SINK TRAP, PLASTIC ADJUSTABLE	1



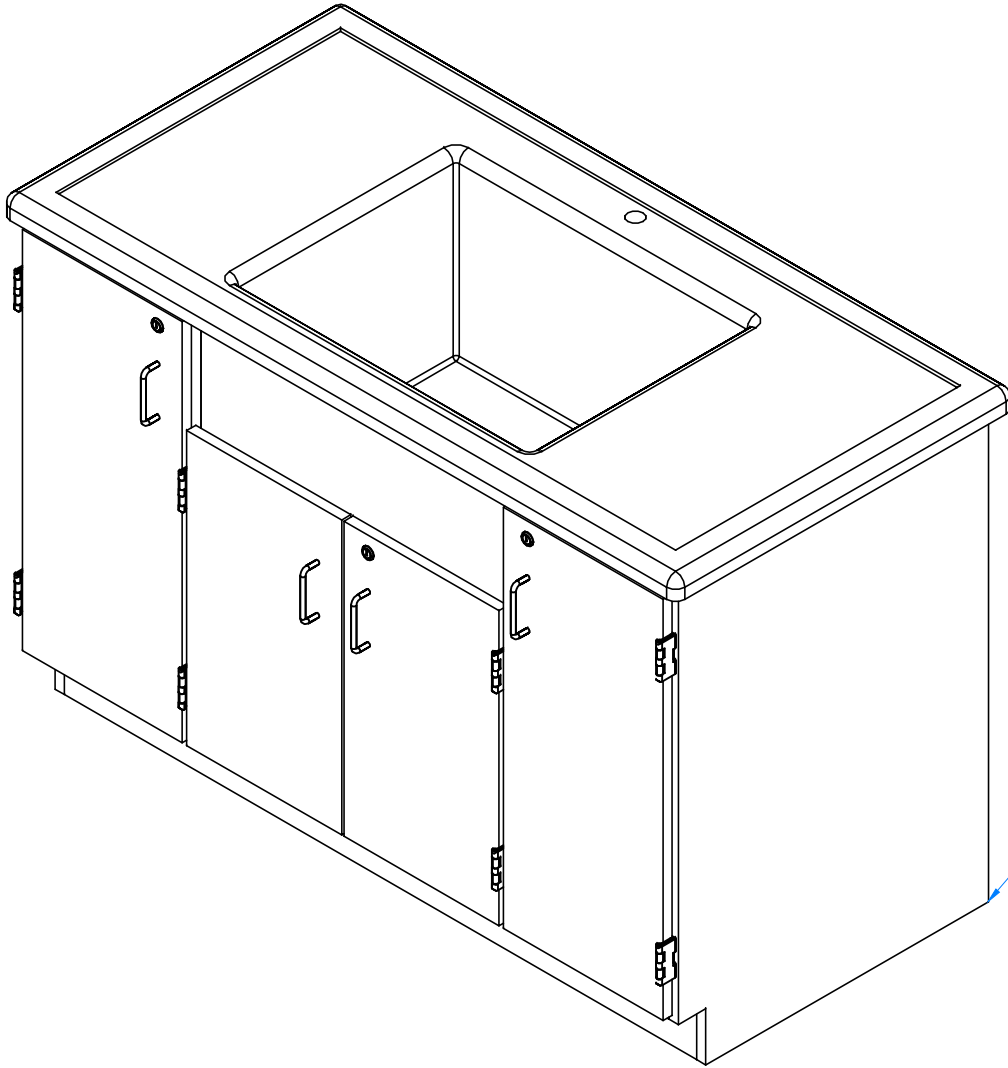

STEP 1:

- PLACE UNIT OVER PLUMBING HOOK-UP.
- LEVEL CABINET.
- ANCHOR TO WALL.

****NOTE****
CABINET MUST BE LEVELED OR
DOORS AND DRAWERS MAY NOT
OPEN OR CLOSE CORRECTLY



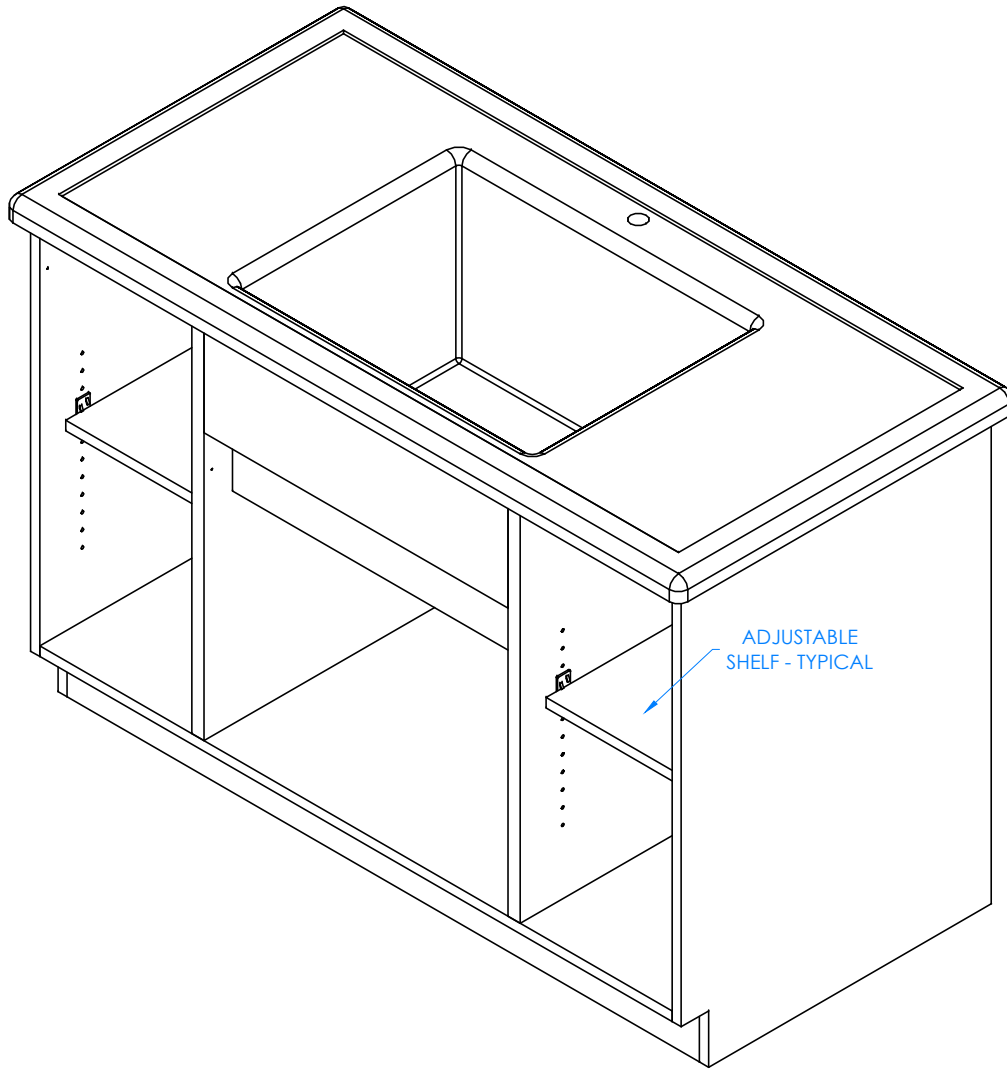

DOORS AND HARDWARE REMOVED TO SHOW CLARITY

STEP 2:

- INSERT SHELF CLIPS IN DESIRED LOCATION.
- PLACE SHELVES ON CLIPS, MAKING SURE THEY ARE LEVEL.



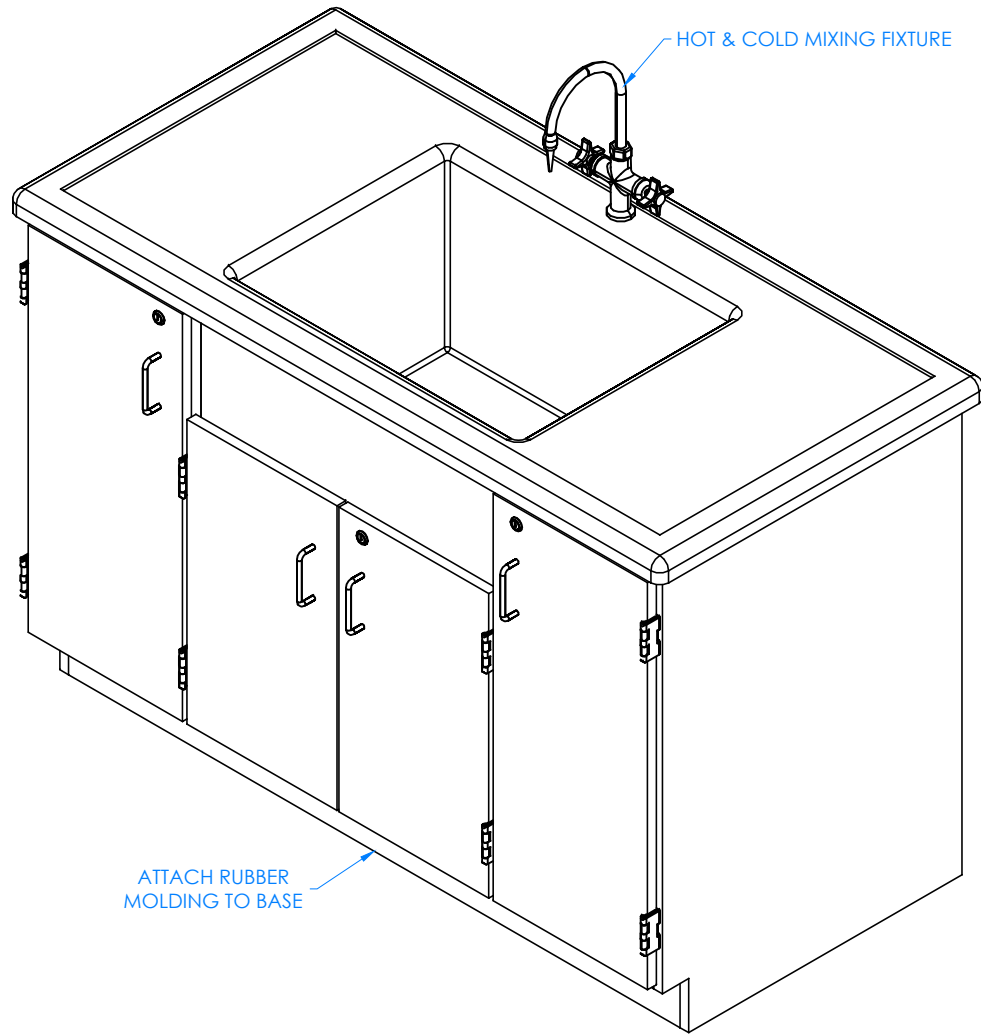

STEP 3:

- ATTACH RUBBER MOLDING TO BASE OF CABINET USING CONTACT CEMENT.
- SCREW STAINLESS STEEL CORNER BRACKETS ON EACH CORNER OVER BASE MOLDING WITH HARDWARE PROVIDED.
- MOUNT FIXTURE INTO PLACE AND HOOK UP WATER AND DRAIN.

NOTE:

1. ALL PLUMBING NEEDS TO BE DONE BY A LICENSED PLUMBER PER LOCAL CODE.

