

Hydroponic Growing System with Light and Locking Cabinet

SMS-01-V102

HGC ASSEMBLY INSTRUCTIONS

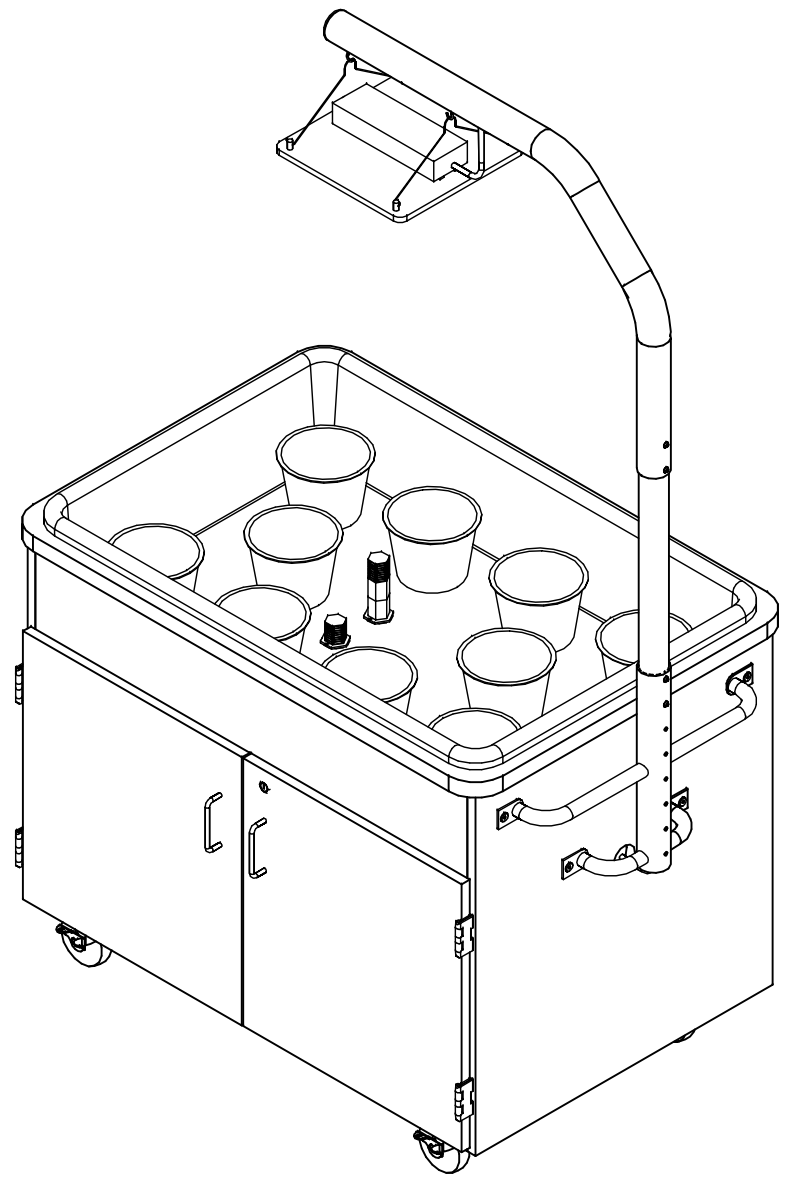

NOTE:

- 1. MODEL VIEWS MAY NOT REPRESENT EXACT MODEL PURCHASED.

TOOLS REQUIRED
4MM ALLEN WRENCH
5MM ALLEN WRENCH
FLATHEAD SCREW DRIVER
3⁄8" WRENCH
3⁄8" SOCKET AND TORQUE WRENCH - OPTIONAL
DRILL & 1⁄8" DRILL BIT
TEFLON PLUMBERS TAPE

ASSEMBLY COMPONENTS			
ITEMS INCLUDED	PART #	PART DESCRIPTION	QTY
CABINET	N/A	41.50"W x 27.50"D x 29.00"H	1
ARM - LOWER	259578	ARM,STEEL,HGC,LOWER, 23.50X3.88X15.81	1
ARM - MIDDLE	259579	ARM,STEEL,HGC,MIDDLE,2.00X2.00X21.81	1
ARM - UPPER	259580	ARM,STEEL,HGC,UPPER, 2.00X30.50X22.00	1
ARM CONNECTING BOLT	259666	SCREW,1/4-20X1/2 BUTTON HEAD HEX DRIVE	4
CONNECTING BOLT	259537	BOLT,1/4-20X0.708,CONNECTOR BOLT	4
CONNECTION NUT	234337-JCN	JOINT CONNECTING NUT,1/4-20X17MM	4
SNAP IN TUBE COVER	259536	SNAP IN TUBE PLUG,ROUND,BLACK	1
CASTERS	100081	CASTER,4IN SWIVEL TOP PLATE, W/BRAKE	4
CASTER HARDWARE	206509	CASTER,ASSY,HARDWARE	1
GROW TRAY	250170	GROW TRAY, 41.5W X 27.5D X 8.25H	1
WATER RESERVOIR	259502	TANK,22 GAL,VERTICAL WATER TANK	1
PLANT POTS	250163	NET POTS, 6"	10
GROW LIGHT	259660	ELECTRICAL,GROW LIGHT,100 WATT	1
J HOOKS	259501	HOOK,J-SHAPE,SCREW IN,ZINC PLATED	2
1⁄4" TUBING	250166	TUBING,3/16ID,1/4"OD,CLEAR AIRLINE	5
1⁄2" TUBING	250167	TUBING,1/2" BLACK HOSE	3

NOTE:

1. BULKHEAD FITTINGS, BALL VALVE, & PIPE NIPPLE ASSEMBLED TO GROW TRAY & RESERVOIR AT DWI.
2. GFCI POWER STRIP MOUNTED IN CABINET AT DWI.
3. COMPONENTS VARY WITH STYLE OF TABLE PURCHASED.

3.1. METAL COMPONENT COLORS:

3.1.1. BLACK, WHITE, CARROT, LIME, AQUA, SILVER, LIGHT GREY, DARK GREY.



ASSEMBLY COMPONENTS			
ITEMS INCLUDED	PART #	PART DESCRIPTION	QTY
3/4" TUBING	250168	TUBING,3/4" BLACK HOSE	4
TIMER	250164	ELECTICAL,TIMER,24 HR, DUAL 15 MIN	2
SUBMERSIBLE PUMP	250159	FIXTURE,SUBMERSIBLE PUMP,264 GPH	1
AIR PUMP	250160	FIXTURE,AIR PUMP,1 OUTLET	1
AIR STONE	250161	FIXTURE,AIR STONE, 4" LONG	1
GFCI POWER STRIP	250802	ELECTRICAL,TRIPP LITE,6 OUTLET,GFCI	1
CABLE CLAMP	251075	CABLE CLAMP, 5/16, BLACK	1
GROMMET	100766	GROMMET,2"DIA	2
GROMMET	100767	GROMMET,3.125"DIA	1

NOTE:

- 1. BULKHEAD FITTINGS, BALL VALVE, & PIPE NIPPLE ASSEMBLED TO GROW TRAY & RESERVOIR AT DWI.
- 2. GFCI POWER STRIP MOUNTED IN CABINET AT DWI.
- 3. COMPONENTS VARY WITH STYLE OF TABLE PURCHASED.
 - 3.1. METAL COMPONENT COLORS:
 - 3.1.1. BLACK, WHITE, CARROT, LIME, AQUA, SILVER, LIGHT GREY, DARK GREY.



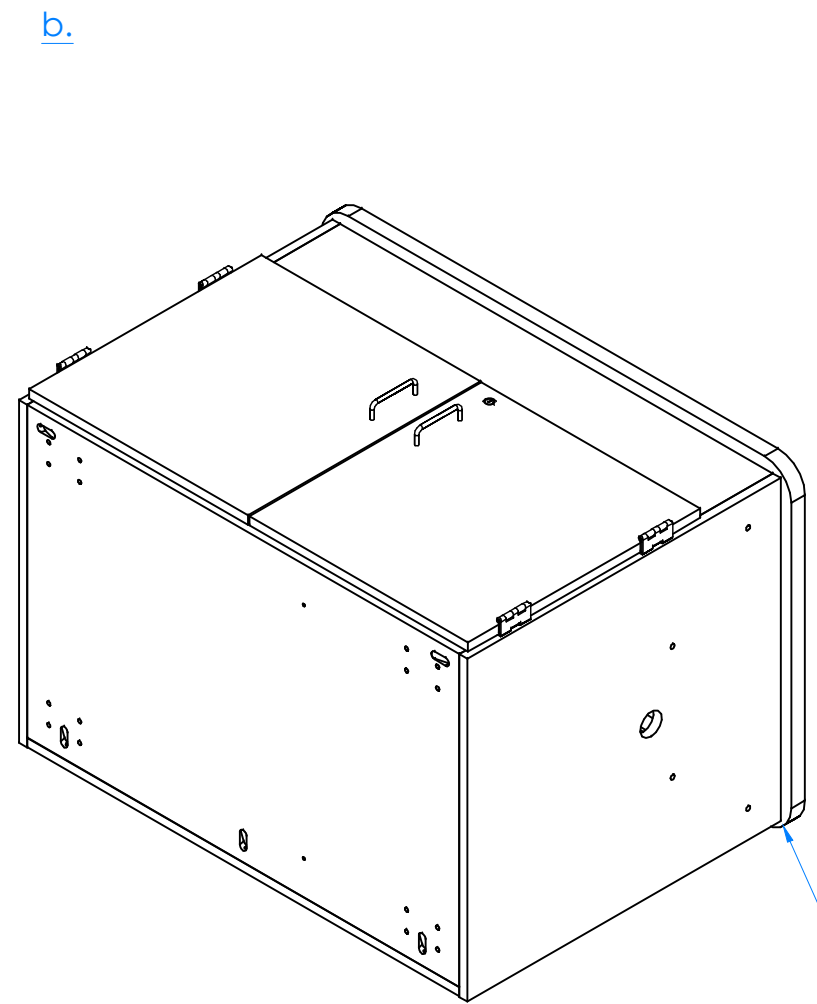
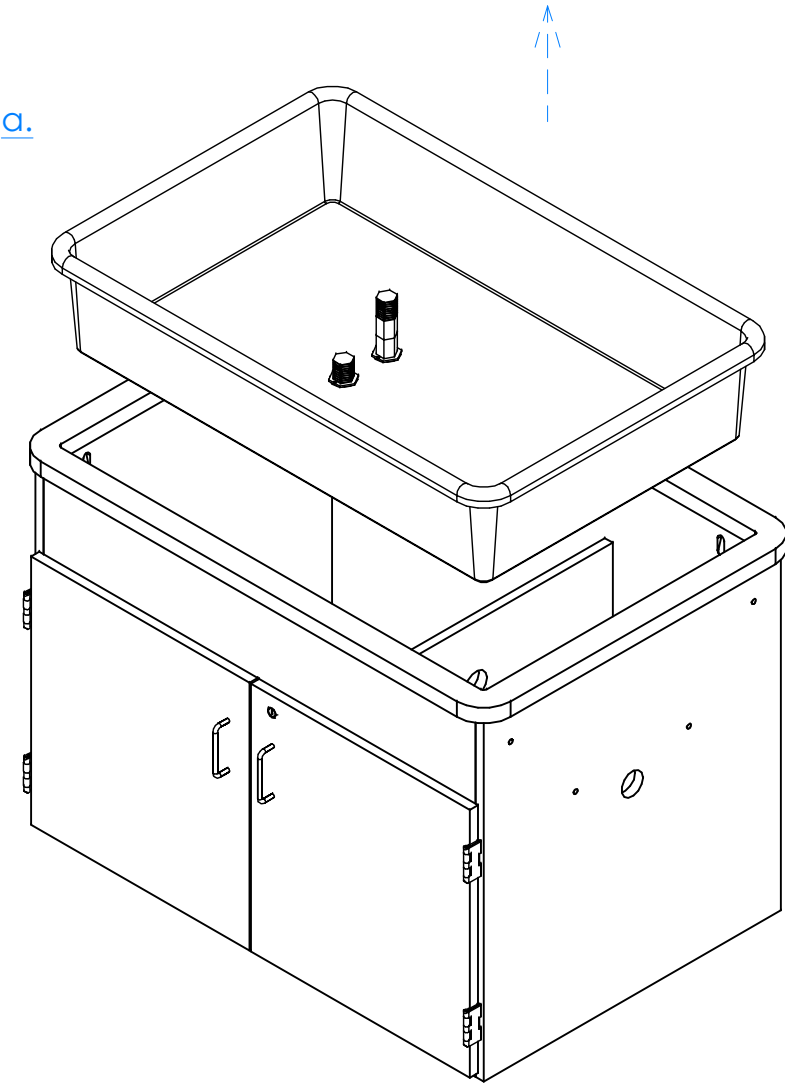

STEP 1:

- a. REMOVE GROW TRAY FROM CABINET ASSEMBLY AND SET ASIDE.
- b. LAY CABINET DOWN ONTO ITS BACK.

****NOTE****
BE SURE CABINET IS ON
A CLEAN SURFACE TO
PREVENT DAMAGE



HARDWARE REQUIRED FOR STEP		
QTY	DESCRIPTION	PART NUMBER
4	CASTERS	100081
1	CASTER,ASSY,HARDWARE	206509

STEP 2:

- α. ATTACH CASTERS USING PROVIDED HARDWARE LISTED ABOVE. ****SEE NOTE****

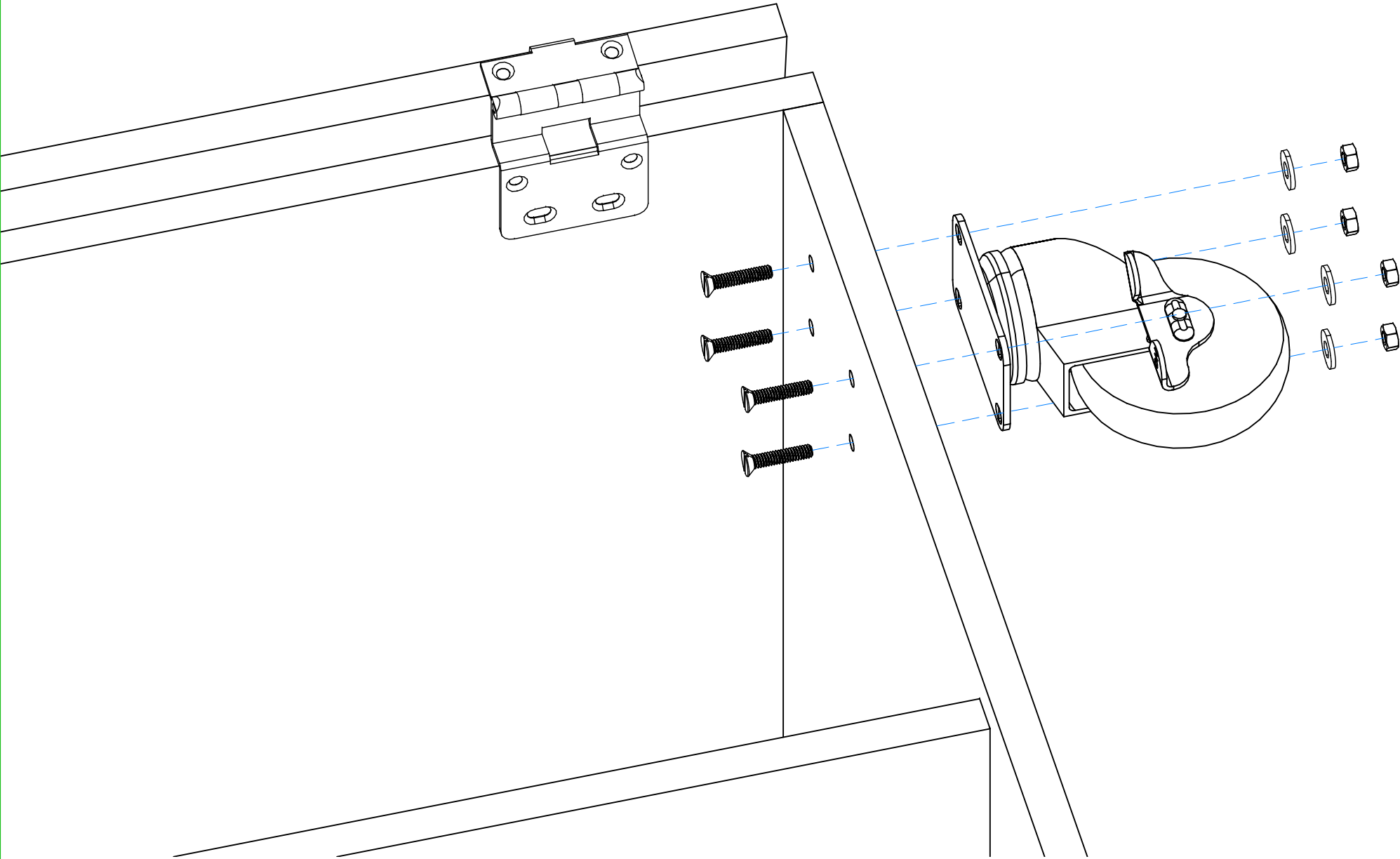

NOTE:

1. ****ATTACH CASTERS WITH FLAT HEAD BOLT THREADS FACING OUTSIDE OF THE CABINET LIKE SHOWN ABOVE.****



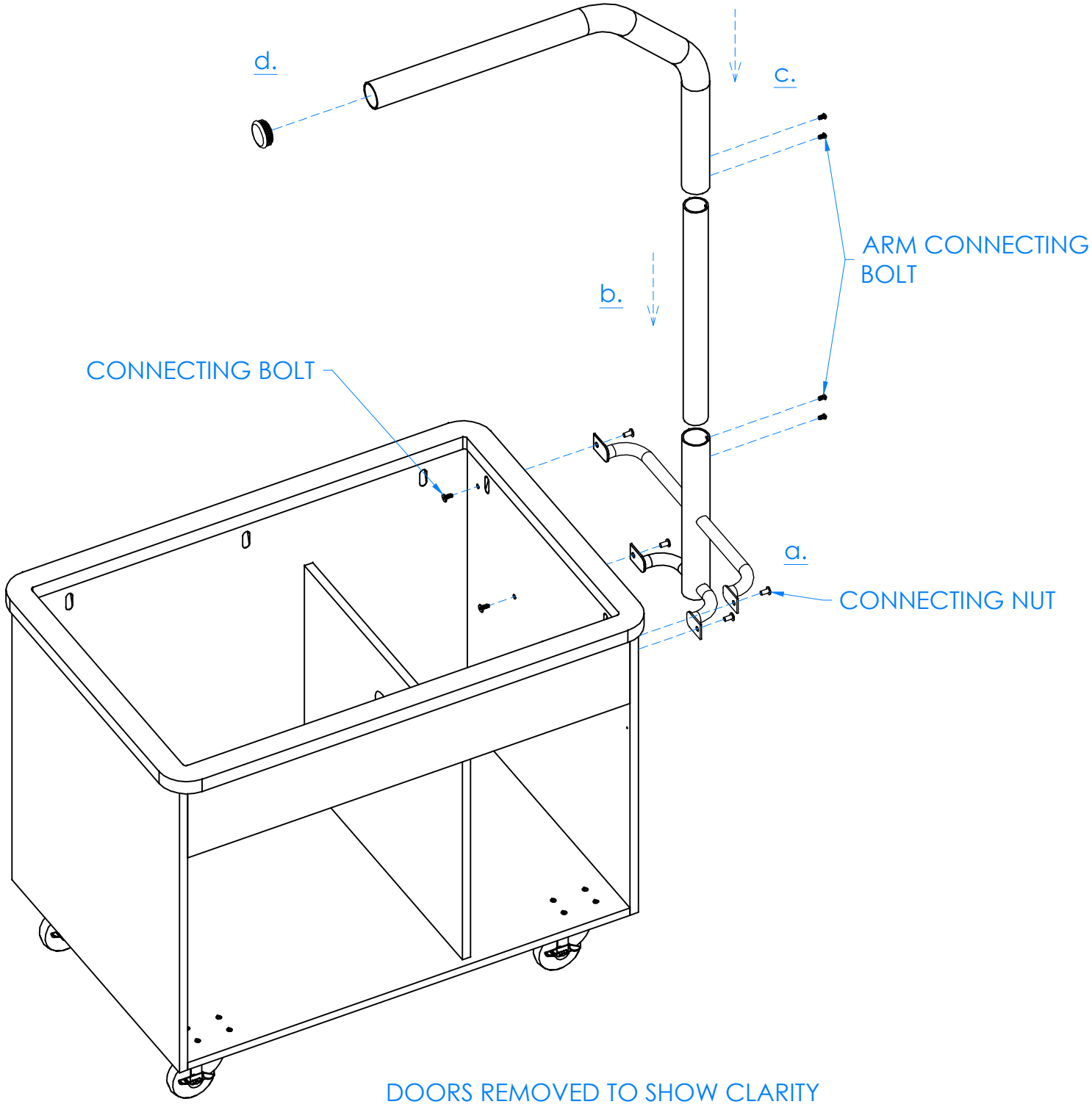

HARDWARE REQUIRED FOR STEP

QTY	DESCRIPTION	PART NUMBER
1	ARM - LOWER	259578
1	ARM - MIDDLE	259579
1	ARM - UPPER	259580
4	ARM CONNECTING BOLT	259666
4	CONNECTOR BOLT	259537
4	JOINT CONNECTING NUT	234337-JCN
1	PLASTIC SNAP IN PLUG,ROUND	259536

STEP 3:

- a. ATTACH HGC LOWER ARM USING PROVIDED HARDWARE LISTED ABOVE.
- b. ATTACH HGC MIDDLE ARM USING PROVIDED ARM CONNECTING BOLTS LISTED ABOVE.
- c. ATTACH HGC UPPER ARM USING PROVIDED ARM CONNECTING BOLTS LISTED ABOVE.
- d. INSTALL SNAP IN TUBE COVER INTO TOP END OF ARM.



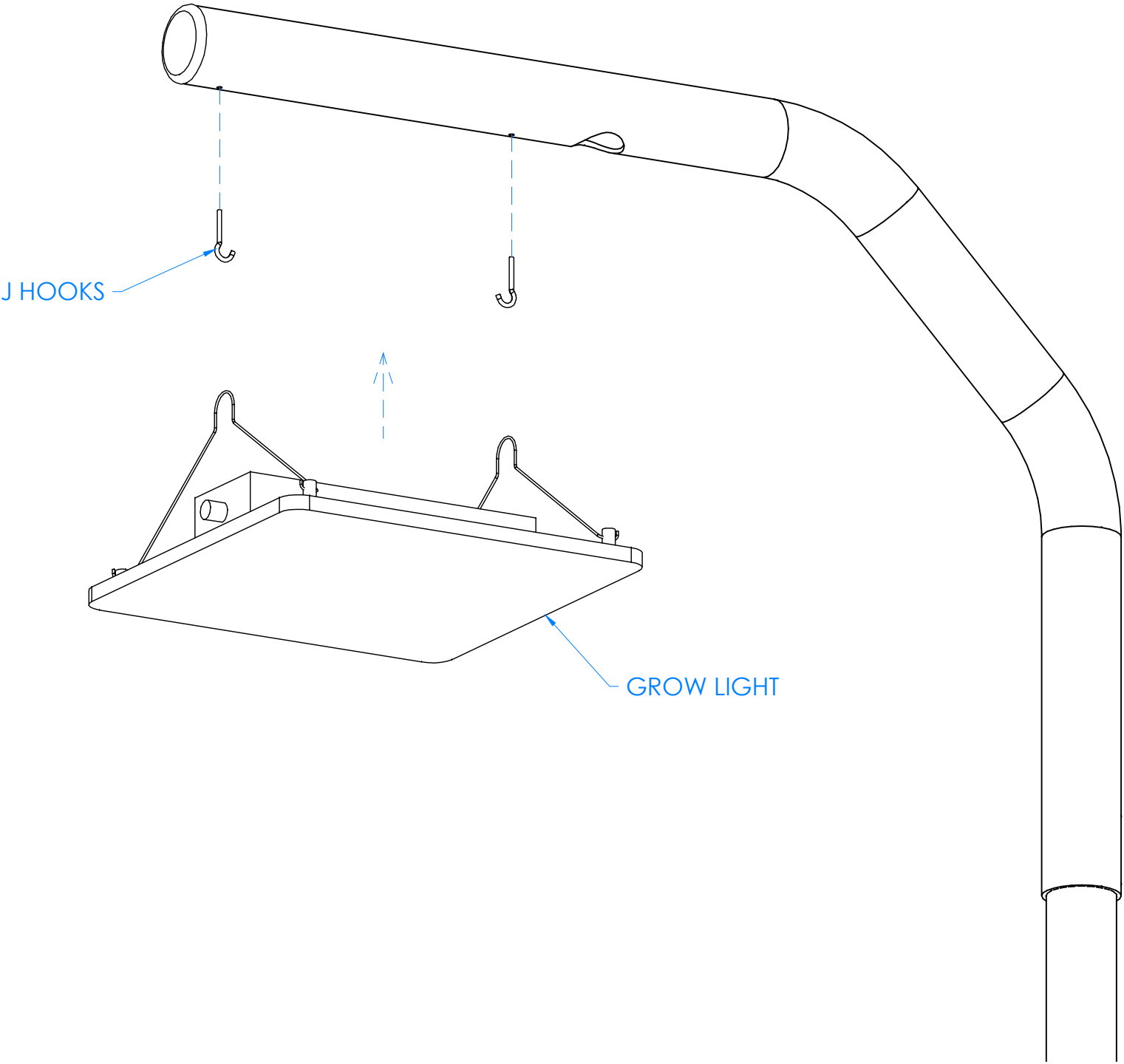

HARDWARE REQUIRED FOR STEP

QTY	DESCRIPTION	PART NUMBER
2	HOOK,J-SHAPE,SCREW IN	259501
1	ELECTRICAL,GROW LIGHT,LED,100W	259660

STEP 4:

- a. SCREW J HOOKS INTO THREADED HOLES AT THE TOP OF THE ARM WITH BOTH HOOKS FACING EACH OTHER.
- b. ATTACH GROW LIGHT BY HOOKING THE METAL HOOPS INTO THE J HOOKS.
- c. ATTACH POWER CABLE AND FEED THROUGH ARM AND INTO GROMMET HOLE ON SIDE OF CABINET.



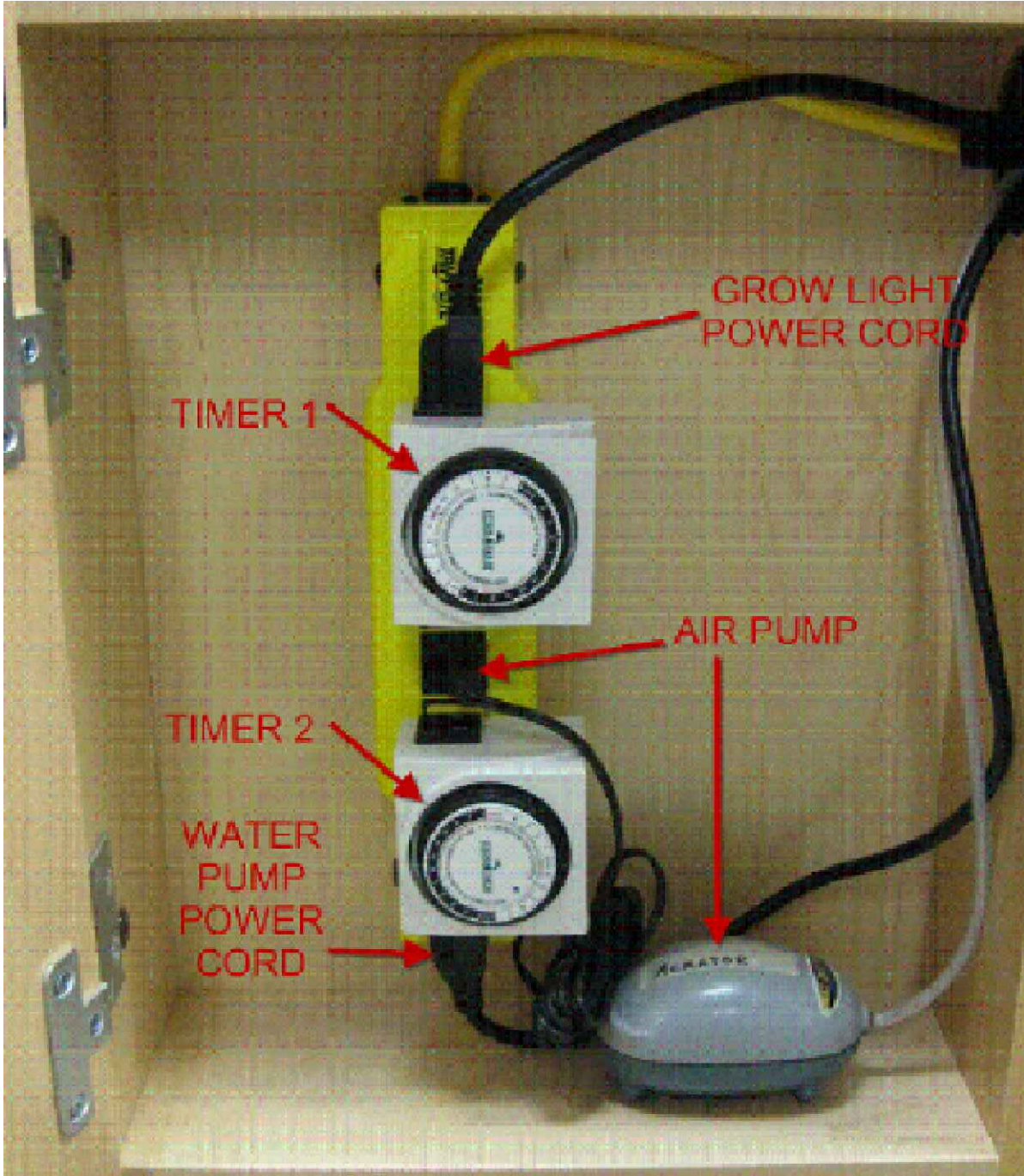

CLOSE UP OF INSIDE OF CABINET SHOWN

HARDWARE REQUIRED FOR STEP

QTY	DESCRIPTION	PART NUMBER
1	ELECTRICAL,TRIPP LITE,6 OUTLET	250802
2	ELECTRICAL TIMER	250164
1	FIXTURE,AIR PUMP	250160
1	CABLE CLAMP,5/16,BLACK	251075

STEP 5:

- a. PLACE TIMERS AND AIR PUMP IN CORRECT LOCATIONS ON POWER STRIP IN CABINET.
 - a.a. GROW LIGHT TIMER (**TIMER 1**) SHOULD BE TOWARDS THE TOP OF THE POWER STRIP.
 - a.b. WATER PUMP TIMER (**TIMER 2**) SHOULD BE TOWARDS THE BOTTOM OF THE POWER STRIP.
 - a.c. INSTALL AIR PUMP POWER CORD INTO CENTER OUTLET IN POWER STRIP.
- b. INSTALL WATER PUMP POWER CORD USING PROVIDED CABLE CLAMP TO SIDE OF CABINET.



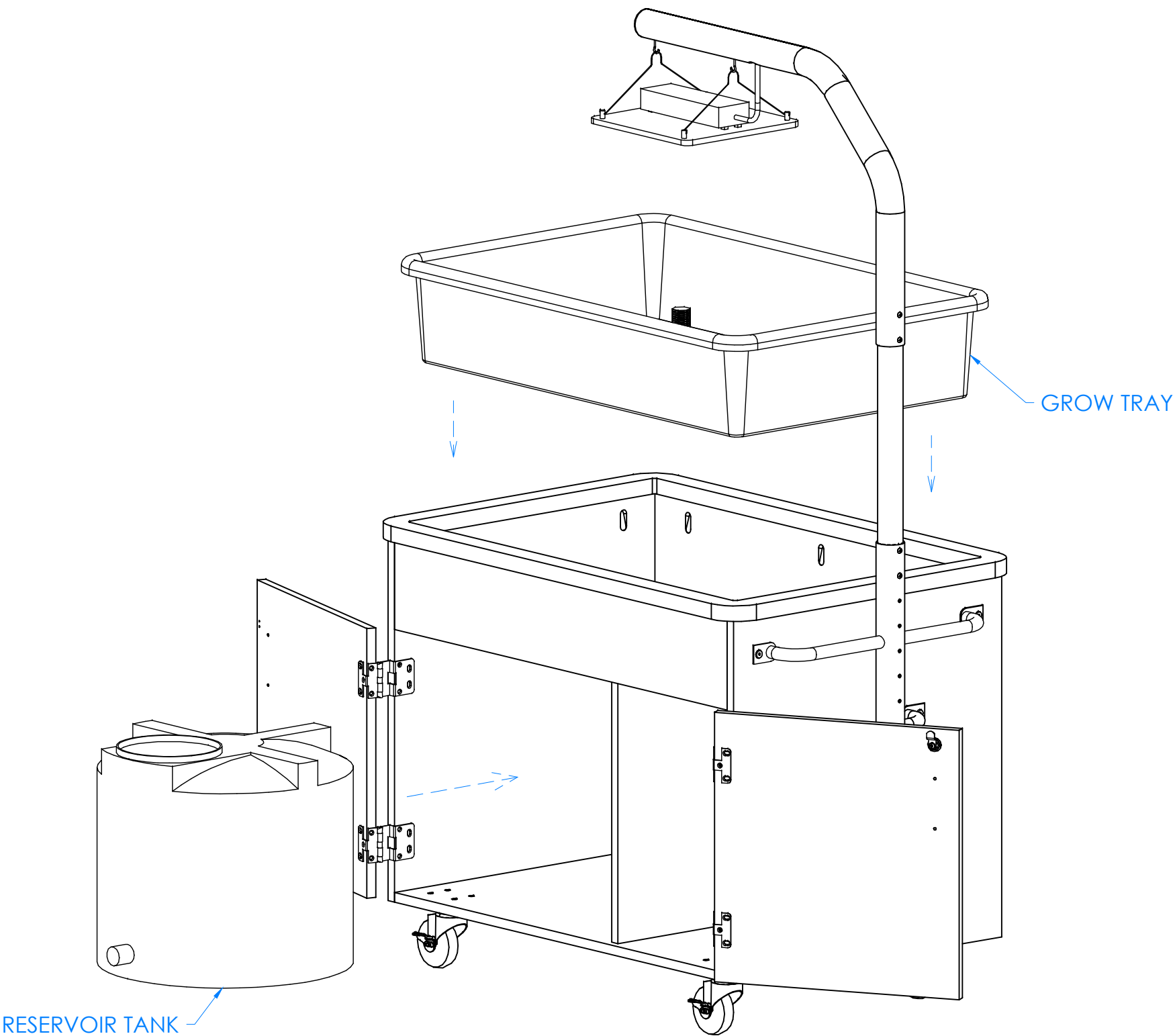

HARDWARE REQUIRED FOR STEP

QTY	DESCRIPTION	PART NUMBER
1	TANK,22 GAL VERTICAL WATER TANK	259502
1	GROW TRAY	250170

- STEP 6:
- a. REMOVE LID FROM RESERVOIR TANK AND PLACE TANK INTO LEFT SIDE OF CABINET SO THAT DRAIN IS FACING THE DOOR.
 - a.a. STORE LID INSIDE CABINET
 - b. REPLACE GROW TRAY INTO TOP OF CABINET.



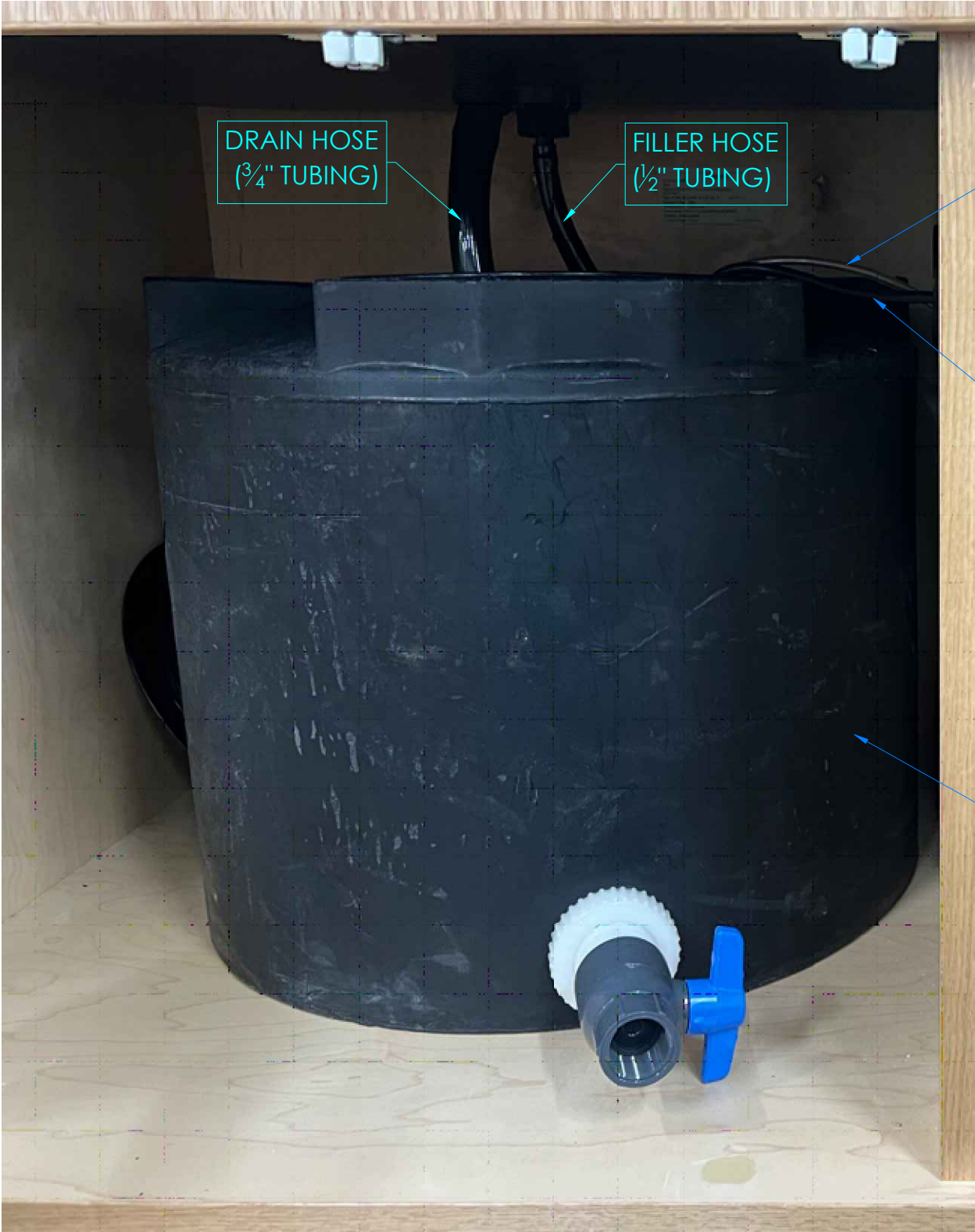

HARDWARE REQUIRED FOR STEP

QTY	DESCRIPTION	PART NUMBER
1	FIXTURE,SUBMERSIBLE PUMP	250159
5	¼" TUBING	250166
3	½" TUBING	250167
4	¾" TUBING	250168

STEP 7:

- a. PLACE WATER PUMP INTO BOTTOM OF RESERVOIR TANK
- b. FEED THE ½" TUBING AND WATER PUMP POWER CORD THROUGH THE TOP OPENING INTO RESERVOIR TANK.
- c. ATTACH THE ½" TUBING FROM THE PUMP TO THE ½" BARBED FITTING ON THE BOTTOM OF THE GROW TRAY.
- d. ATTACH THE ¾" TUBING TO THE ¾" BARBED FITTING AND PLACE THE OTHER END INTO THE RESERVOIR TANK.
- e. RUN AIR LINE FROM AIR PUMP INTO THE RESERVOIR TANK.



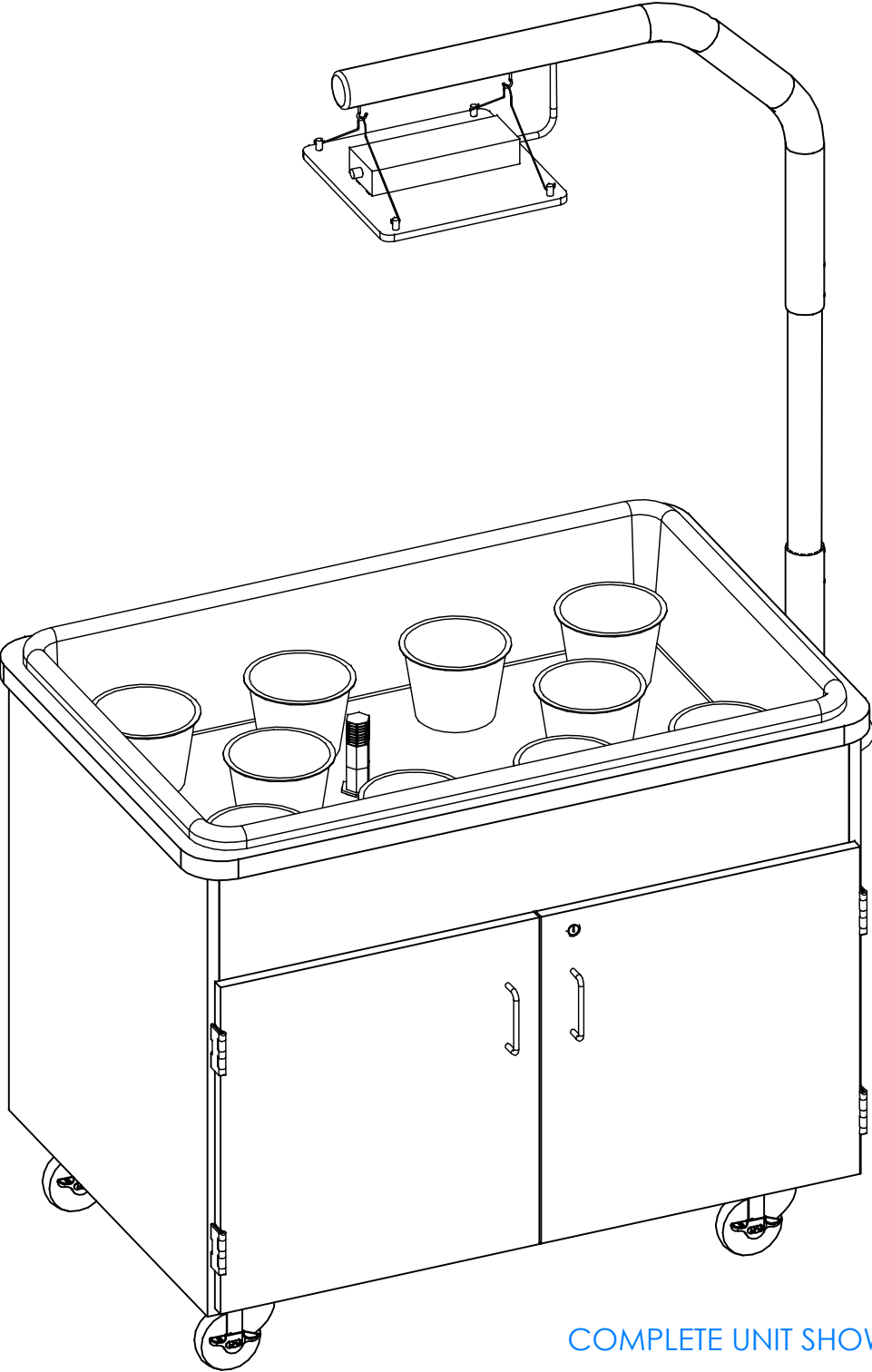

COMPLETE UNIT SHOWN

HARDWARE REQUIRED FOR STEP

QTY	DESCRIPTION	PART NUMBER
10	NET POTS	250163
1	AIR STONE	250161
2	GROMMET	100766
1	GROMMET	100767

STEP 8:

- a. SET TIMERS TO CONTROL YOUR LIGHT AND WATER PUMP AS DESIRED.
- b. ATTACH GROMMETS INTO HOLES LOCATED ON SIDE PANEL, BACK PANEL, AND INTERNAL DIVIDER.
- c. PLUG POWER STRIP INTO WALL OUTLET AT DESIRED LOCATION.
- d. FILL RESERVOIR TANK TO WITHIN 4 INCHES OF THE TOP, DROP IN AIR STONE, AND REPLACE RESERVOIR LID.
- e. ADD GROW MEDIA TO NET POTS AND PLACE POTS INTO GROW TRAY.
- f. UNIT IS COMPLETE AND READY FOR USE.

